



Document 2018 3944

Book 2018 Page 3944 Type 06 043 Pages 1

Date 12/03/2018 Time 3:14:08PM

Rec Amt \$7.00

INDX
ANNO
SCAN
CHEK

LISA SMITH, COUNTY RECORDER
MADISON COUNTY IOWA

PREPARED BY: CRAIG S. BOLDMAN 521 WEST GREEN STREET, WINTERSET, IA 50273 PHONE (515)462-9242

UNITED STATES PUBLIC LAND SURVEY CORNER CERTIFICATE

Land Survey Monuments situated in Section 8, Township 74N, Range 27W, the Fifth Principal Meridian, Madison County, Iowa.
Previously recorded in Bk: 1 Pg: 155 in County Recorder's Office

(Show reason for preparing this certificate, the evidence and detailed procedures used in establishing the corner positions & monumentation found or placed)

Monument Description and Remarks:

- ① N1/4 Corner – Found 1/2" iron rod set by C.T. Vance later used by B.L. Skinner in 1992 survey.
- ② NE Corner – Found 1/2" iron rod found by B.L. Skinner in 1993. Later found by J.B. Morrissey in 1994 survey
- ③ E1/4 Corner – Searched for stone. Nothing found. Set 5/8" at SW side of 3-way fence post.
- ④ SW Corner NE 1/4 – Searched for stone Nothing found. Set 5/8" IR N. side of corner post.

PLAN-VIEW

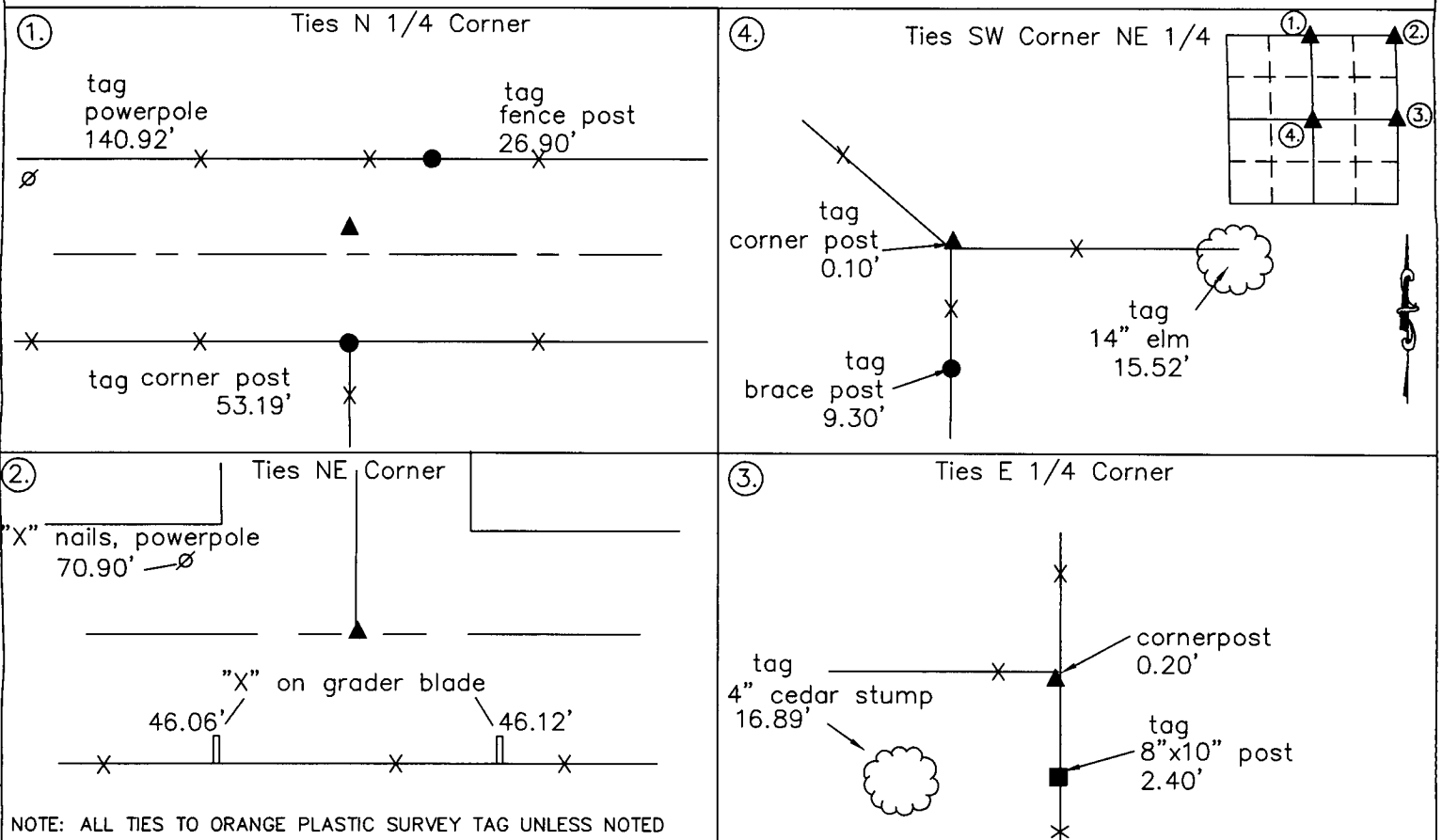

NOTE: ALL TIES TO ORANGE PLASTIC SURVEY TAG UNLESS NOTED

I HEREBY CERTIFY THAT THIS LAND SURVEYING DOCUMENT WAS PREPARED AND THE RELATED SURVEY WORK WAS PERFORMED BY ME OR UNDER MY DIRECT PERSONAL SUPERVISION AND THAT I AM A DULY LICENSED LAND SURVEYOR UNDER THE LAWS OF THE STATE OF IOWA

SIGNATURE *Craig S. Boldman*
CRAIG S. BOLDMAN

DATE: 12/3/18 LICENSE NO 13427

MY RENEWAL DATE IS DECEMBER 31, 2018

COVERS SHEETS

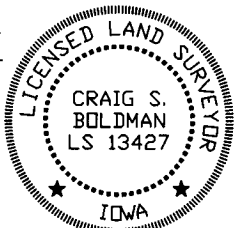

CORNERS TO BE INDEXED

Corners	Section	Township	Range
①	8	74	27
②	8	74	27
③	8	74	27
④	8	74	27

Project No.18040