

REAL ESTATE TRANSFER - GROUNDWATER HAZARD STATEMENT
TO BE COMPLETED BY TRANSFEROR

TRANSFEROR:

Name Dana Follmann
Address 1516 Old Portland Road, Van Meter, IA 50261
Number and Street or RR City, Town or P.O. State Zip

TRANSFeree:

Name Troy Corder and Stacy Corder
Address 1516 Old Portland Road, Van Meter, IA 50261
Number and Street or RR City, Town or P.O. State Zip

Address of Property Transferred:

1516 Old Portland Road, Van Meter, IA 50261
Number and Street or RR City, Town or P.O. State Zip

Legal Description of Property: (Attach if necessary) See attached legal description

1. Wells (check one)

- There are no known wells situated on this property.
 There is a well or wells situated on this property. The type(s), location(s) and legal status are stated below or set forth on an attached separate sheet, as necessary. *in basement se*

2. Solid Waste Disposal (check one)

- There is no known solid waste disposal site on this property.
 There is a solid waste disposal site on this property and information related thereto is provided in Attachment #1, attached to this document.

3. Hazardous Wastes (check one)

- There is no known hazardous waste on this property.
 There is hazardous waste on this property and information related thereto is provided in Attachment #1, attached to this document.

4. Underground Storage Tanks (check one)

- There are no known underground storage tanks on this property. (Note exclusions such as small farm and residential motor fuel tanks, most heating oil tanks, cisterns and septic tanks, in instructions.)
 There is an underground storage tank on this property. The type(s), size(s) and any known substance(s) contained are listed below or on an attached separate sheet, as necessary.

5. Private Burial Site (check one)

- There are no known private burial sites on this property.
- There is a private burial site on this property. The location(s) of the site(s) and known identifying information of the decedent(s) is stated below or on an attached separate sheet, as necessary.

6. Private Sewage Disposal System (check one)

- All buildings on this property are served by a public or semi-public sewage disposal system.
- This transaction does not involve the transfer of any building which has or is required by law to have a sewage disposal system.
- There is a building served by private sewage disposal system on this property or a building without any lawful sewage disposal system. A certified inspector's report is attached which documents the condition of the private sewage disposal system and whether any modifications are required to conform to standards adopted by the Department of Natural Resources. A certified inspection report must be accompanied by this form when recording.
- There is a building served by private sewage disposal system on this property. Weather or other temporary physical conditions prevent the certified inspection of the private sewage disposal system from being conducted. The buyer has executed a binding acknowledgment with the county board of health to conduct a certified inspection of the private sewage disposal system at the earliest practicable time and to be responsible for any required modifications to the private sewage disposal system as identified by the certified inspection. A copy of the binding acknowledgment is attached to this form.
- There is a building served by private sewage disposal system on this property. The buyer has executed a binding acknowledgment with the county board of health to install a new private sewage disposal system on this property within an agreed upon time period. A copy of the binding acknowledgment is provided with this form.
- There is a building served by private sewage disposal system on this property. The building to which the sewage disposal system is connected will be demolished without being occupied. The buyer has executed a binding acknowledgment with the county board of health to demolish the building within an agreed upon time period. A copy of the binding acknowledgment is provided with this form. [Exemption #9]
- This property is exempt from the private sewage disposal inspection requirements pursuant to the following exemption [Note: for exemption #9 use prior check box]: _____.
- The private sewage disposal system has been installed within the past two years pursuant to permit number _____.

Information required by statements checked above should be provided here or on separate sheets attached hereto:

I HEREBY DECLARE THAT I HAVE REVIEWED THE INSTRUCTIONS FOR THIS FORM AND THAT THE INFORMATION STATED ABOVE IS TRUE AND CORRECT.

Signature:  Telephone No.: (515) 238-9456
(Transferor or Agent)

A parcel of land in the Northwest Quarter of the Northwest Quarter (NW¼ NW¼) of Section 33, Township 77 North, Range 27 West of the 5th P.M., Madison County, Iowa, more particularly described as follows: Beginning at the Southwest Corner of the Northwest Quarter of the Northwest Quarter (NW¼ NW¼) of said Section 33, thence along the South line of said Northwest Quarter of the Northwest Quarter (NW¼ NW¼), North 89°37'11" East 848.48 feet; thence North 00°00'00" 159.83 feet; thence South 87°47'27" West 600.58 feet; thence North 05°25'59" West 258.55 feet; thence North 14°27'56" West 225.02 feet; thence South 89°53'17" West 167.64 feet to the West line of said Section 33; thence along said West line, thence South 00°00'00" 617.27 feet to the Point of Beginning. Said parcel of land contains 5.250 acres, including 0.490 acres of county road right-of-way.



Time of Transfer Inspection Report (DNR Form 542-0191)

Property information

Current owner JANA FOLLMANN
Buyer TROY & STACY CORDER Realtor Sarah Cowman
Mailing address 1516 Old Portland Rd, JAN Meter, IA 50261

Site Address/County Same as Above / Madison Co
Legal Description AS ABSTRACT

No. of bedrooms 3 Last occupied? present Records available yes
Permit/installation date 021-07/4-16-08 Separation distances ok/no? OK

Septic system information

Septic tank(s): size 2,000 gal material Concrete condition ok
Tank pumped? yes date 8-7-18 licensed pumper Countryside Septic
Septic/trash/processing tank: size material condition
Tank pumped? date licensed pumper

Aerobic treatment unit (ATU) mfg size
Tank pumped? date licensed pumper
Maintenance contract? expiration date service provider
Condition

Pump tanks/vaults: type pressurized size 1,000 gal condition ok

Distribution system: distribution box outlets used condition
Header pipe(s) # of lines Pressure dosed?

Secondary treatment:
length of absorption fields determined by
condition of fields determined by
type of trench material

Size of sand filter determined by
Vent pipes above grade? discharge pipe located?
Effluent sample taken? yes Results See Lab Results 7-10 1415

Media filters: type EcoFlow peat
Maintenance contract? yes expiration date 6-1-18 service provider River to River
Condition OK AT TIME OF THE INSPECTION
MAINTENANCE AGREEMENT HAS EXPIRED.

NPDES General Permit No. 4: required? permitted? NOI provided



Time of Transfer Inspection Report

Other components:

Alarms YES Working? YES disinfection NO working? _____

Control box _____ Timers _____ inspection ports _____

Other components SECTOR
Sump pump for plumbing in basement

Overall condition of the private sewage disposal system

Report system status _____

Explain (attach additional pages as needed): _____

Comments: Concrete slab south of house has rough
in plumbing for bathroom that goes into
septic tank (see drawing)

Site status at conclusion of Time of Transfer inspection:

- Verify that controls are set on the appropriate mode.
- Power is on to all components.
- Revisit all components to verify lids are secure.
- Gather all tools for removal from the site.
- Verify that no sewage is on the ground surface.

Using this worksheet, write a narrative report of the inspection results and attach a site sketch.

This report indicates the condition of the private sewage disposal system at the time of the inspection. It does not guarantee that it will continue to function satisfactorily.

Signature of Certified inspector: [Signature] Date: 8-7-18
 Name (print): BRIAN RINAPO Certificate #: 8805
 Address: P.O. Box 264 NORWALK IA 50211
 Phone #: 202-4895

Provide a copy of this report, the narrative report and sketch to the seller/agent, buyer/agent or the person ordering the inspection, the county sanitarian/environmental health office, and to;

Iowa DNR
Private Sewage Disposal Program
502 E. 9th St.
Des Moines, IA 50319

Time of Transfer Report System Status

Address: 1516 OLD PORTLAND RD

Date: 8-7-18

Comments: VAN Meter, 50261

Technician: Brian Rinard

ALL WASTEWATER FROM HOUSE & CONCRETE SLAB FOR
FUTURE BATHROOM APPEARS TO DRAIN INTO SEPTIC SYSTEM
2000 GAL CONCRETE (2) COMPARTMENT SEPTIC TANK WITH
RISERS & EFFLUENT FILTER ALONG WITH 1500 GAL PUMP PIT
TANK WITH RISERS AND PUMP & ALARM ALL WORKING
AT TIME OF THE INSPECTION. ECO-FLO PEAT
TANK - TIPPING TRAY WORKING AND EFFLUENT SAMPLE
TAKEN TO DSM WRA LAB (RESULTS 7-10 DAYS)

THIS IS NOT A GUARANTEE

THIS CERTIFIES THAT THE SEPTIC SYSTEM
WAS IN WORKING CONDITION AT THE
TIME OF THE INSPECTION

DIAGRAM OF SYSTEM.

NOTE: Add concrete SLAB WITH ROUGH IN PLUMBING
TO ORIGINAL DRAWING

See
County
Records

Permit # 021-07 Peat Filter Inspection 4/16/07
Popular Financial Services

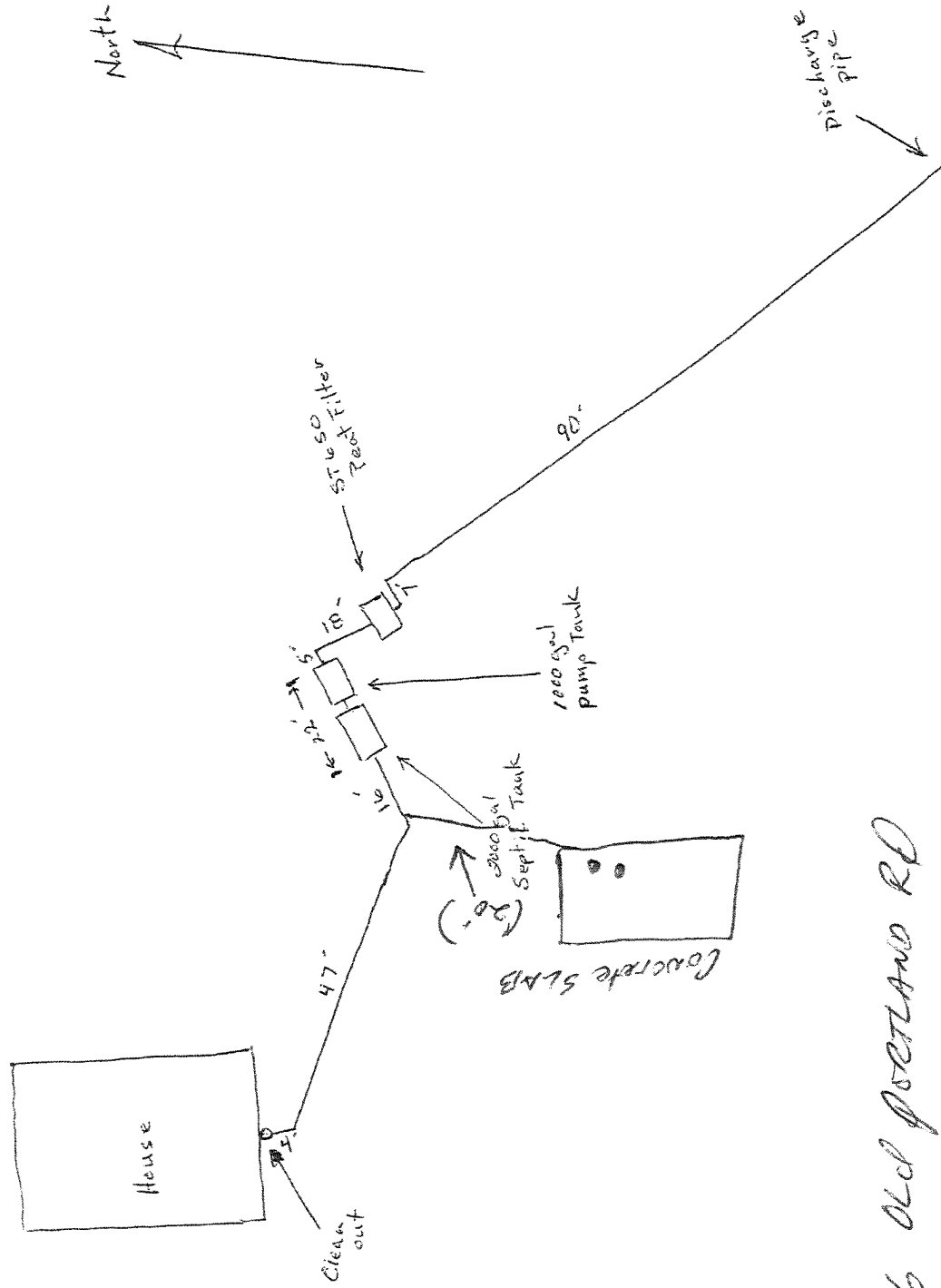

1516 Old Portland RD