

Document 2017 GW4022

Book 2017 Page 4022 Type 43 001 Pages 8
Date 12/22/2017 Time 12:12:55PM
Rec Amt \$.00

INDX
ANNO
SCAN
CHEK

LISA SMITH, COUNTY RECORDER
MADISON COUNTY IOWA

**REAL ESTATE TRANSFER - GROUNDWATER HAZARD STATEMENT
TO BE COMPLETED BY TRANSFEROR**

TRANSFEROR:

Name Margaret E. Noble

Address 9225 Cascade Ave #2311 West Des Moines IA 50266
Number and Street or RR City, Town or P.O. State Zip

TRANSFeree:

Name Christopher M. Grandstaff

Address 9534 SE 56th Ave Runnells IA 50237
Number and Street or RR City, Town or P.O. State Zip

Address of Property Transferred:

2517 Hiatt Apple Trl. Winterset IA 50273
Number and Street or RR City, Town or P.O. State Zip

Legal Description of Property: (Attach if necessary)

Lot One (1) of Lazy "S" Ranch Subdivision, located in the Northeast Quarter (1/4) of the Northeast Quarter (1/4) of Section Twenty-three (23), Township Seventy-five (75) North, Range Twenty-seven (27) West of the 5th P.M., Madison County, Iowa.

1. Wells (check one)

- There are no known wells situated on this property.
- There is a well or wells situated on this property. The type(s), location(s) and legal status are stated below or set forth on an attached separate sheet, as necessary.

2. Solid Waste Disposal (check one)

- There is no known solid waste disposal site on this property.
- There is a solid waste disposal site on this property and information related thereto is provided in Attachment #1, attached to this document.

3. Hazardous Wastes (check one)

- There is no known hazardous waste on this property.
- There is hazardous waste on this property and information related thereto is provided in Attachment #1, attached to this document.

4. Underground Storage Tanks (check one)

- There are no known underground storage tanks on this property. (Note exclusions such as small farm and residential motor fuel tanks, most heating oil tanks, cisterns and septic tanks, in instructions.)
- There is an underground storage tank on this property. The type(s), size(s) and any known substance(s) contained are listed below or on an attached separate sheet, as necessary.

5. Private Burial Site (check one)

- There are no known private burial sites on this property.
- There is a private burial site on this property. The location(s) of the site(s) and known identifying information of the decedent(s) is stated below or on an attached separate sheet, as necessary.

6. Private Sewage Disposal System (check one)

- All buildings on this property are served by a public or semi-public sewage disposal system.
- This transaction does not involve the transfer of any building which has or is required by law to have a sewage disposal system.
- There is a building served by private sewage disposal system on this property or a building without any lawful sewage disposal system. A certified inspector's report is attached which documents the condition of the private sewage disposal system and whether any modifications are required to conform to standards adopted by the Department of Natural Resources. A certified inspection report must be accompanied by this form when recording.
- There is a building served by private sewage disposal system on this property. Weather or other temporary physical conditions prevent the certified inspection of the private sewage disposal system from being conducted. The buyer has executed a binding acknowledgment with the county board of health to conduct a certified inspection of the private sewage disposal system at the earliest practicable time and to be responsible for any required modifications to the private sewage disposal system as identified by the certified inspection. A copy of the binding acknowledgment is attached to this form.
- There is a building served by private sewage disposal system on this property. The buyer has executed a binding acknowledgment with the county board of health to install a new private sewage disposal system on this property within an agreed upon time period. A copy of the binding acknowledgment is provided with this form.
- There is a building served by private sewage disposal system on this property. The building to which the sewage disposal system is connected will be demolished without being occupied. The buyer has executed a binding acknowledgment with the county board of health to demolish the building within an agreed upon time period. A copy of the binding acknowledgment is provided with this form. [Exemption #9]
- This property is exempt from the private sewage disposal inspection requirements pursuant to the following exemption [Note: for exemption #9 use prior check box]: _____.
- The private sewage disposal system has been installed within the past two years pursuant to permit number _____.

Information required by statements checked above should be provided here or on separate sheets attached hereto:

I HEREBY DECLARE THAT I HAVE REVIEWED THE INSTRUCTIONS FOR THIS FORM AND THAT THE INFORMATION STATED ABOVE IS TRUE AND CORRECT.

Signature: Margaret E Noble Telephone No.: (515) 975-3480
 (Transferor or Agent)



Time of Transfer Inspection Report (DNR Form 542-0191)

Property information

Current owner Margaret Noble Tom Sweagle 515-577-6758
Buyer Realtor Becky Knight 515-707-3444
Mailing address 1738 Rio Valley Dr. Clive Ia 50325
Site Address/County 2517 Hiatt Apple Trl. Winterset Ia / Madison Co
Legal Description

No. of bedrooms 4 Last occupied? 1 year Records available yes

Permit/installation date 5-15-08 Separation distances (sk)no? yes

Septic system information 056-07 010-12

Septic tank(s): size 2,000 gal. material concrete condition Good
Tank pumped? yes date 12-12-17 licensed pumper yes ST 307
Septic/trash/processing tank: size material condition
Tank pumped? date licensed pumper

Aerobic treatment unit (ATU) mfrg size
Tank pumped? date licensed pumper
Maintenance contract? expiration date service provider
Condition

Pump tanks/vaults: type Poly Vinyl size 50 gal condition Good

Distribution system: distribution box yes outlets used no condition Good
Header pipe(s) 1 # of lines 5 Pressure dosed? no

Secondary treatment:
length of absorption fields 5 x 100' 500 ft. determined by
condition of fields Good determined by
type of trench material 24" chambers

Size of sand filter determined by
Vent pipes above grade? discharge pipe located?
Effluent sample taken? Results

Media filters: type
Maintenance contract? expiration date service provider
Condition

NPDES General Permit No. 4: required? permitted? NOI provided



Time of Transfer Inspection Worksheet

Other Components

Alarms yes Working? yes Disinfection no Working? _____

Control Box no Timers no Inspection Ports no

Other Components Zoeller grinder pump

Overall condition of the private sewage disposal system

Acceptable? yes Unacceptable? _____

Explain (attach additional pages as needed): _____

Comments: Recommend to have septic tank pumped and cleaned every 3 to 5 years

Site status at conclusion of Time of Transfer inspection:

- Verify that controls are set on the appropriate mode.
- Power is on to all components.
- Revisit all components to verify lids are secure.
- Gather all tools for removal from the site.
- Verify that no sewage is on the ground surface.

Using this worksheet, write a narrative report of the inspection results.

Submit a copy of this report, including your narrative, to the city/county environmental health office, the DNR and the county Recorder in the county where the inspection was conducted.

This report indicates the condition of the private sewage disposal system at the time of the inspection. It does not guarantee that it will continue to function satisfactorily.

Signature of Certified Inspector: Vance Smith Date: 12-14-17
 Name (print): Vance Smith Certificate #: 8992
 Address: 502 West Main Street St. Charles Ia 50240
 Phone #: 641-396-2440

**ANYTIME SEPTIC SERVICES II
VANCE SMITH
ST. CHARLES, IA 50240
641-396-2440**

REAL ESTATE SEPTIC INSPECTION

On December 12, 2017. Anytime Septic Services II did Time of Transfer Real Estate Inspection on lift station, septic tank, distribution box, and lateral field at 2517 Hiatt Apple Trail, Winterset, IA 50273. Tom Swegle residence. *Margaret Noble*

Lift station is a 50 gallon Poly Vinyl plastic Fralo tank with air vent and 30 inch plastic lid at ground surface. Lift station consist of a Zoeller grinder pump with Fernco flexible coupling for easy disconnect. Pump is pumping through 2 inch schedule 40 pipe to septic tank and is working properly. Alarm is on 4x4 wooden post next to lift station and is also working properly, red light is lighting and alarm is sounding.

Septic tank is a 2,000 gallon two compartment concrete Lister tank which I pumped and cleaned. Tank is 30 inches below ground level with 30x22 inch plastic E.Z. Risers and 23 inch plastic E.Z. screw down lids at ground surface above 4 inch schedule 40 pipe and 4 inch schedule 40 tee baffle on both inlet and outlet ends of tank. Header pipe coming into septic tank is pushed upward and doesn't appear to be causing any issues.

Distribution box is a plastic Tuff Tite box and is 6 inches below ground level with concrete surrounding for support. Inside box is a 4 inch schedule 40 piped tee baffle and 5, 4 inch schedule 40 piped lines leveling box through 5 screwed into place speed levelers. Effluent level in box was at ring or gasket level after pumping and cleaning box. I noticed bottom of box was slightly pushed upward and I didn't find or notice any cracking or leaking in distribution box.

Lateral field is located in a flat not mowed area and consist of 5 runs of 24 inch plastic infiltrated chambers at 100 feet, each totaling 500 feet of laterals that are 16 to 19 inches below ground level with no evidence of any ponding or surfacing of septic above absorption field and no popping sound from probing all 5 laterals.

NOT RESPOSIBLE FOR ANY FAILED SEPTIC SYSTEMS.

Permit # 056-07 David Nobel Inspection 5/15/08
2517 Hiatt Apple Trl.

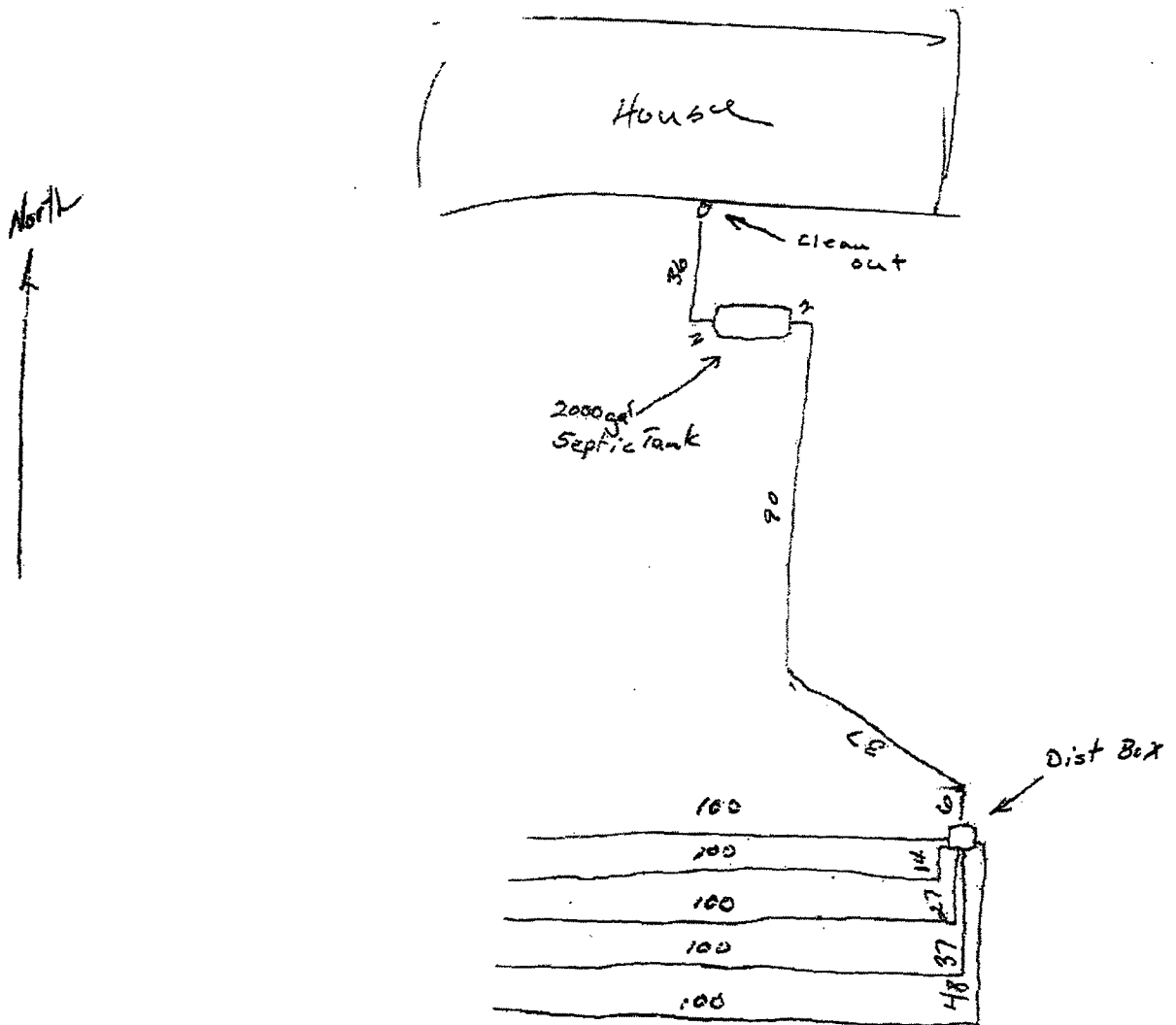

Permit # 010-12
2517 Hiatt Apple Trl.
Inspection 4/9/12
SR

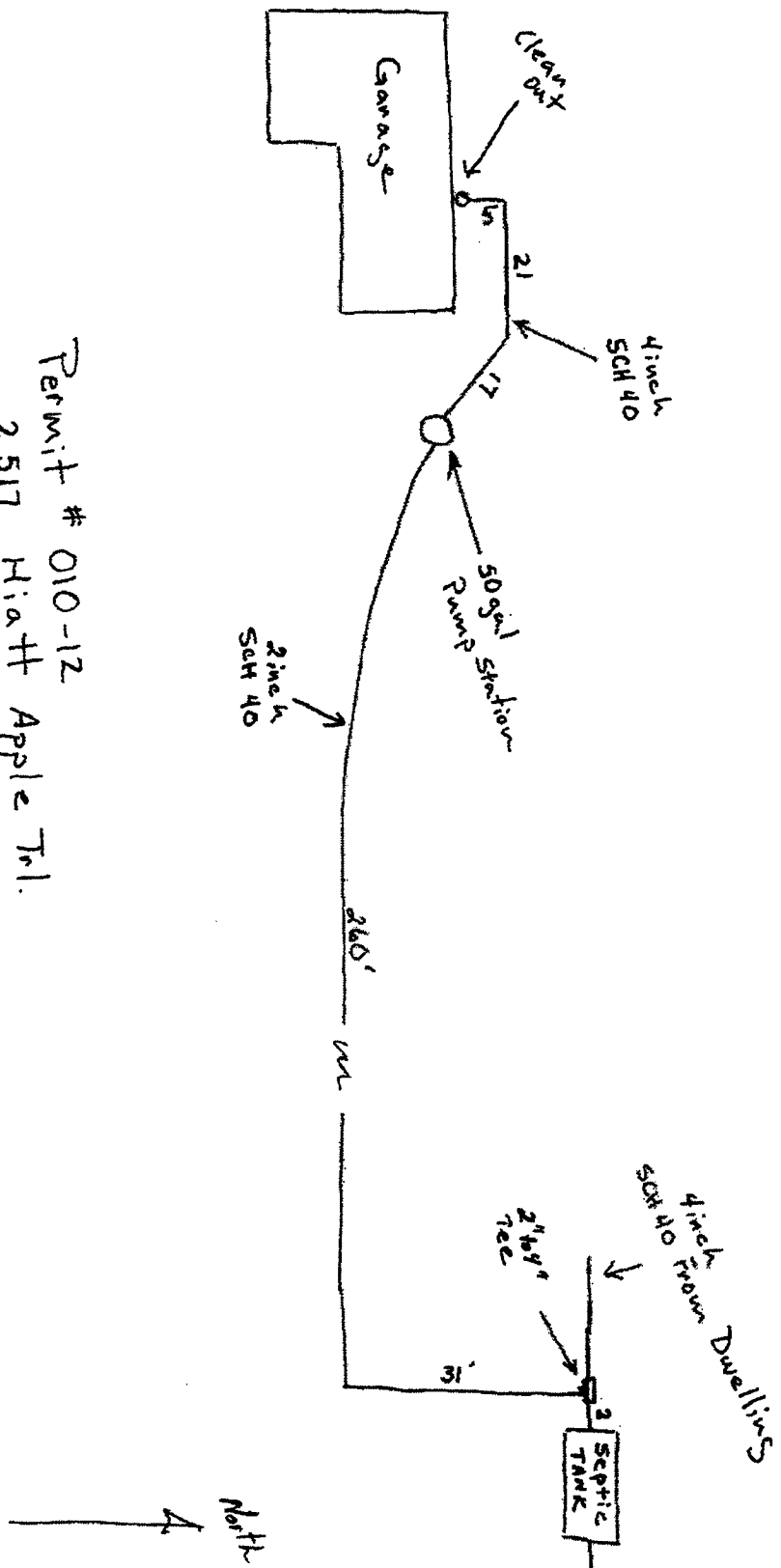

Anytime Septic Services II
502 W. Main St.
Saint Charles, Iowa
50240

CUSTOMER'S ORDER NO. 515-577-6758	DEPARTMENT	DATE 12-14-77
---	------------	-------------------------

NAME **Tom Sweeple**

ADDRESS **1738 Rio Valley Drive**

CITY, STATE, ZIP **Clive Ia 50325**

SOLD BY	CASH	C.O.D.	CHARGE	ON. ACCT.	MDSE. RETD.	PAID OUT
---------	------	--------	--------	-----------	-------------	----------

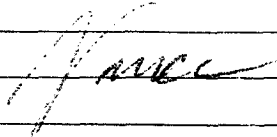
QUANTITY	DESCRIPTION	PRICE	AMOUNT
1			
2	Pumped and cleaned lift station, septic tank, distribution box and inspected complete septic system. Fuel, dumping and inspection included.		
3			
4			
5			
6			
7			
8	D.B.A.		\$ 650⁰⁰
9			
10			
11	Thank You		
12			
13			
14			
15			
16			
17			
18	Total		\$ 650⁰⁰

RECEIVED BY _____

KEEP THIS SLIP FOR REFERENCE