

BK: 2017 PG: 2915
Recorded: 9/15/2017 at 12:57:21.0 PM
Fee Amount: \$0.00
Revenue Tax:
LISA SMITH RECORDER
Madison County, Iowa

**REAL ESTATE TRANSFER - GROUNDWATER HAZARD STATEMENT
TO BE COMPLETED BY TRANSFEROR**

TRANSFEROR:

Name Amy E. Kaven, f/k/a Amy E. Sowder
Address 2345 St. Charles Road, Winterset, IA 50273
Number and Street or RR City, Town or P.O. State Zip

TRANSFereeE:

Name Aaron L. Vetter
Address 2345 St. Charles Road, Winterset, IA 50273
Number and Street or RR City, Town or P.O. State Zip

Address of Property Transferred:
2345 St. Charles Road, Winterset, IA 50273
Number and Street or RR City, Town or P.O. State Zip

Legal Description of Property: (Attach if necessary) Lot Three (3) of Middle River View Subdivision, located in the Northeast Quarter (1/4) of Section Eight (8), and in the Northwest Quarter (1/4) of the Northwest Quarter (1/4) of Section Nine (9), All in Township Seventy-five (75) North, Range Twenty-seven (27) West of the 5th P.M., Madison County, Iowa

1. Wells (check one)

- There are no known wells situated on this property.
 There is a well or wells situated on this property. The type(s), location(s) and legal status are stated below or set forth on an attached separate sheet, as necessary.

2. Solid Waste Disposal (check one)

- There is no known solid waste disposal site on this property.
 There is a solid waste disposal site on this property and information related thereto is provided in Attachment #1, attached to this document.

3. Hazardous Wastes (check one)

- There is no known hazardous waste on this property.
 There is hazardous waste on this property and information related thereto is provided in Attachment #1, attached to this document.

4. Underground Storage Tanks (check one)

- There are no known underground storage tanks on this property. (Note exclusions such as small farm and residential motor fuel tanks, most heating oil tanks, cisterns and septic tanks, in instructions.)
 There is an underground storage tank on this property. The type(s), size(s) and any known substance(s) contained are listed below or on an attached separate sheet, as necessary.

5. Private Burial Site (check one)

- There are no known private burial sites on this property.
- There is a private burial site on this property. The location(s) of the site(s) and known identifying information of the decedent(s) is stated below or on an attached separate sheet, as necessary.

6. Private Sewage Disposal System (check one)

- All buildings on this property are served by a public or semi-public sewage disposal system.
- This transaction does not involve the transfer of any building which has or is required by law to have a sewage disposal system.
- There is a building served by private sewage disposal system on this property or a building without any lawful sewage disposal system. A certified inspector's report is attached which documents the condition of the private sewage disposal system and whether any modifications are required to conform to standards adopted by the Department of Natural Resources. A certified inspection report must be accompanied by this form when recording.
- There is a building served by private sewage disposal system on this property. Weather or other temporary physical conditions prevent the certified inspection of the private sewage disposal system from being conducted. The buyer has executed a binding acknowledgment with the county board of health to conduct a certified inspection of the private sewage disposal system at the earliest practicable time and to be responsible for any required modifications to the private sewage disposal system as identified by the certified inspection. A copy of the binding acknowledgment is attached to this form.
- There is a building served by private sewage disposal system on this property. The buyer has executed a binding acknowledgment with the county board of health to install a new private sewage disposal system on this property within an agreed upon time period. A copy of the binding acknowledgment is provided with this form.
- There is a building served by private sewage disposal system on this property. The building to which the sewage disposal system is connected will be demolished without being occupied. The buyer has executed a binding acknowledgment with the county board of health to demolish the building within an agreed upon time period. A copy of the binding acknowledgment is provided with this form. [Exemption #9]
- This property is exempt from the private sewage disposal inspection requirements pursuant to the following exemption [Note: for exemption #9 use prior check box]: _____.
- The private sewage disposal system has been installed within the past two years pursuant to permit number _____.

Information required by statements checked above should be provided here or on separate sheets attached hereto:

Regarding #1, there is a well located approximately 40 feet North of the house. There is also a 2nd well approximately 100 feet ~~west~~ east of the house.

I HEREBY DECLARE THAT I HAVE REVIEWED THE INSTRUCTIONS FOR THIS FORM AND THAT THE INFORMATION STATED ABOVE IS TRUE AND CORRECT.

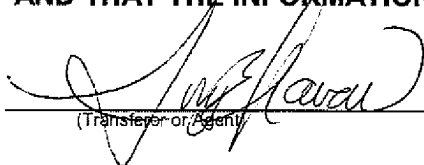
Signature: 
(Transferor or Agent)

Telephone No.: 515-608-9399



Time of Transfer Inspection Report

Property Information

Current Owner: Amy + Dave Souder
Buyer: _____ Realtor: _____

Mailing Address: _____

Site Address/Country: 2345 Saint Charles Road Winterset IA 50273

Legal Description _____

No. of bedrooms: 3 Last occupied: Current Records available: Yes

Permit/installation date: 7/26/07 Separation distances (ok/no?): ok

Septic System Information

Septic tank(s): Size: 1500 gal Material: Concrete Condition: good

Tank pumped? Y N Date: 6-21-17 Licensed pumper: ST-237

Septic/Trash/Processing tank: Size: _____ Material: _____ Condition: _____

Tank pumped? Y N Date: _____ Licensed pumper: _____

Aerobic treatment unit (ATU) mfr _____ Size _____

Tank pumped? Y N Date: _____ Licensed pumper: _____

Maintenance contract? Y N Expiration date: _____ Service provider: _____

Condition: _____

Pump tanks/vaults: Type: _____ Size: _____ Condition: _____

Distribution system: Distribution box Plastic Outlets used 5 Condition: good

Header pipe(s): _____ No. of lines: _____ Pressure dosed? no

Secondary Treatment:

Length of absorption fields: 5 @ 100 Determined by: Probe, map

Condition of fields: Good Determined by: hydraulic test

Type of trench material: Chambers

Size of sand filter: _____ Determined by: _____

Vent pipes above grade? Y N Discharge pipe located? Y N

Effluent sample taken _____ Results: _____

Media Filters: Type: _____

Maintenance contract? Y N Expiration date: _____ Service provider: _____

Condition: _____

NPDES General Permit No. 4: Required? Y N Permitted? Y N NOI provided: _____



Time of Transfer Inspection Report

Other components:

Alarms: Y N Working: Y N Disinfection: Y N Working: Y N

Control Box: _____ Timers: _____ Inspection Ports: _____

Other components: _____

Overall condition of the private sewage disposal system: Good

Report system status: System was working properly on day of inspection.
Explain (attach additional pages as needed): Secondary treatment handled

Comments: hydraulic test and was working properly on inspection.
System was working properly on day of inspection.

Site status at conclusion of Time of Transfer inspection:

- Verify that controls are set on the appropriate mode.
- Power is on to all components.
- Revisit all components to verify lids are secure.
- Gather all tools for removal from the site.
- Verify that no sewage is on the ground surface.

Using this worksheet, write a narrative report of the inspection results and attach a site sketch.

This report indicates the condition of the private sewage disposal system at the time of the inspection. It does not guarantee that it will continue to function satisfactorily.

Signature of Certified Inspector: Joe Bedwell Date: 6-22-17

Name (print): Joe Bedwell Certificate #: 10974

Address: 1600 West Euclid Avenue #2 Indianola IA 50125

Phone #: 515-681-5885

Provide a copy of this report, the narrative report and sketch to the seller/agent, buyer/agent or the person ordering the inspection, the county sanitarian/environmental health office and to:

Iowa DNR
Private Sewage Disposal Program
502 E 9th St
Des Moines IA 50319

Permit # 610-07
Inspection 7/26/07

2345 St. Charles Rd.

North



6-22-17

JB

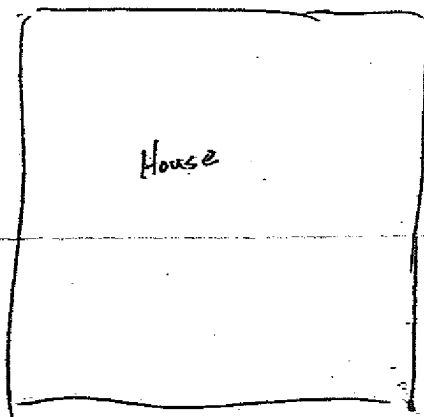

12

31



gal
Septic Tank



Dist Box

