



Document 2017 GW2839

Book 2017 Page 2839 Type 43 001 Pages 7

Date 9/08/2017 Time 10:24:35AM

Rec Amt \$.00

INDX  
ANNO  
SCAN

LISA SMITH, COUNTY RECORDER  
MADISON COUNTY IOWA

CHEK

**REAL ESTATE TRANSFER - GROUNDWATER HAZARD STATEMENT  
TO BE COMPLETED BY TRANSFEROR**

**TRANSFEROR:**

Name: Casey W Christensen and Heidi L Christensen

Address: PO Box 222 State Center Iowa 50247

Number and Street or RR

City, Town or P.O.

State

Zip

**TRANSFeree:**

Name: Anthony Monroe and Katie Monroe

Address

Number and Street or RR

City, Town or P.O.

State

Zip

Address of Property Transferred:

2953 Truro Road, Truro, IA 50257

Legal Description of Property: (Attach if necessary) : Parcel "A" located in the Northeast Quarter (1/4) of the Southeast Quarter (1/4) of Section Ten (10), Township Seventy-four (74) North, Range Twenty-six (26) West of the 5th P.M., Madison County, Iowa, containing 4.45 acres, as shown in Plat of Survey filed in Book 2005, Page 4867 on October 7, 2005 in the Office of the Recorder of Madison County, Iowa, EXCEPT any part thereof conveyed for road purposes or for use as a public highway

**1. Wells (check one)**

- There are no known wells situated on this property.
- There is a well or wells situated on this property. The type(s), location(s) and legal status are stated below or set forth on an attached separate sheet, as necessary.

**2. Solid Waste Disposal (check one)**

- There is no known solid waste disposal site on this property.
- There is a solid waste disposal site on this property and information related thereto is provided in Attachment #1, attached to this document.

**3. Hazardous Wastes (check one)**

- There is no known hazardous waste on this property.
- There is hazardous waste on this property and information related thereto is provided in Attachment #1, attached to this document.

**4. Underground Storage Tanks (check one)**

- There are no known underground storage tanks on this property. (Note exclusions such as small farm and residential motor fuel tanks, most heating oil tanks, cisterns and septic tanks, in instructions.)
- There is an underground storage tank on this property. The type(s), size(s) and any known substance(s) contained are listed below or on an attached separate sheet, as necessary. FILE

**WITH RECORDER  
Site (check one)**

**DNR Form 542-0960 (July 18, 2012)5. Private Burial**

- There are no known private burial sites on this property.
- There is a private burial site on this property. The location(s) of the site(s) and known identifying information of the decedent(s) is stated below or on an attached separate sheet, as necessary.

**6. Private Sewage Disposal System (check one)**

- All buildings on this property are served by a public or semi-public sewage disposal system.
- This transaction does not involve the transfer of any building which has or is required by law to have a sewage disposal system.
- There is a building served by private sewage disposal system on this property or a building without any lawful sewage disposal system. A certified inspector's report is attached which documents the condition of the private sewage disposal system and whether any modifications are required to conform to standards adopted by the Department of Natural Resources. A certified inspection report must be accompanied by this form when recording.
- There is a building served by private sewage disposal system on this property. Weather or other temporary physical conditions prevent the certified inspection of the private sewage disposal system from being conducted. The buyer has executed a binding acknowledgment with the county board of health to conduct a certified inspection of the private sewage disposal system at the earliest practicable time and to be responsible for any required modifications to the private sewage disposal system as identified by the certified inspection. A copy of the binding acknowledgment is attached to this form.
- There is a building served by private sewage disposal system on this property. The buyer has executed a binding acknowledgment with the county board of health to install a new private sewage disposal system on this property within an agreed upon time period. A copy of the binding acknowledgment is provided with this form.
- There is a building served by private sewage disposal system on this property. The building to which the sewage disposal system is connected will be demolished without being occupied. The buyer has executed a binding acknowledgment with the county board of health to demolish the building within an agreed upon time period. A copy of the binding acknowledgment is provided with this form. (Exemption #9)
- This property is exempt from the private sewage disposal inspection requirements pursuant to the following exemption (Note: for exemption #9 use prior check box): \_\_\_\_\_.
- The private sewage disposal system has been installed within the past two years pursuant to permit number \_\_\_\_\_.

**Information required by statements checked above should be provided here or on separate sheets attached hereto:**

---

---

**I HEREBY DECLARE THAT I HAVE REVIEWED THE INSTRUCTIONS FOR THIS  
FORM  
AND THAT THE INFORMATION STATED ABOVE IS TRUE AND CORRECT.**

Signature: \_\_\_\_\_

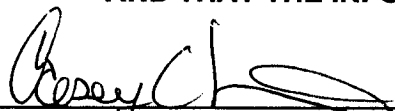
  
(Transferor or Agent)

Telephone No.: (319) 215-5574

**FILE WITH RECORDER**

**DNR Form 542-0960 (July 18, 2012)**



Time of Transfer Inspection Report (DNR Form 542-0191)

Property information

Current owner Casey + Heidi Christensen 319-215-5574 644-765-4250
Buyer
Mailing address 2953 Truro Rd, Truro Ia, 50257
Realtor Julie Egli 515-480-3037

Site Address/County 2953 Truro Rd, Truro Ia, Madison County
Legal Description

No. of bedrooms
Last occupied? 15
Records available yes

Permit/installation date 12-16-09 Separation distances SR/no? yes
159.05

Septic system information

Septic tank(s): size 1,500 gal. material Poly Vinyl condition Good
Tank pumped? yes date 7-9-17 licensed pumper yes S.T 307
Septic/trash/processing tank: size material condition
Tank pumped? date licensed pumper

Aerobic treatment unit (ATU) mfr size
Tank pumped? date licensed pumper
Maintenance contract? expiration date service provider
Condition

Pump tanks/vaults: type Poly Vinyl size 500 gal. condition Good

Distribution system: distribution box yes outlets used no condition Good
Header pipe(s) 1 # of lines 4 Pressure dosed? yes

Secondary treatment:
length of absorption fields 4 x 100' 400 ft. determined by
condition of fields Good determined by
type of trench material 36" infiltrators

Size of sand filter determined by
Vent pipes above grade? discharge pipe located?
Effluent sample taken? Results

Media filters: type
Maintenance contract? expiration date service provider
Condition

NPDES General Permit No. 4: required? permitted? NOI provided



Time of Transfer Inspection Worksheet

Other Components

Alarms yes Working? yes Disinfection no Working? \_\_\_\_\_

Control Box no Timers no Inspection Ports no

Other Components Zeller Pump, effluent filter

Overall condition of the private sewage disposal system

Acceptable? yes Unacceptable? \_\_\_\_\_

Explain (attach additional pages as needed): \_\_\_\_\_  
\_\_\_\_\_  
\_\_\_\_\_

Comments: Have septic tank pumped and cleaned every 3 to 5 years, clean effluent filter at least once a year!

Site status at conclusion of Time of Transfer inspection:

- Verify that controls are set on the appropriate mode.
- Power is on to all components.
- Revisit all components to verify lids are secure.
- Gather all tools for removal from the site.
- Verify that no sewage is on the ground surface.

Using this worksheet, write a narrative report of the inspection results.

Submit a copy of this report, including your narrative, to the city/county environmental health office, the DNR and the county Recorder in the county where the inspection was conducted.

This report indicates the condition of the private sewage disposal system at the time of the inspection. It does not guarantee that it will continue to function satisfactorily.

Signature of Certified Inspector: *Vance Smith* Date: 7.12.17  
 Name (print): Vance Smith Certificate #: 8992  
 Address: 502 West Main Street St. Charles Ia 50240  
 Phone #: 641.396.2440

**ANYTIME SEPTIC SERVICES II  
VANCE SMITH  
ST. CHARLES, IA 50240  
641-396-2440**

**REAL ESTATE SEPTIC INSPECTION**

On July 9<sup>th</sup>, 2017 Anytime Septic Services II did Time of Transfer Real Estate Inspection on septic tank, lift station, distribution box and lateral field at 2953 Truro Road in Truro, Iowa 50257. At the Casey and Heidi Christensen residence.

Septic tank is a 1,500 gallon two compartment Poly Vinyl Fralo tank that I pumped and cleaned with water. Tank is 17 inches below ground surface with plastic risers and with 28 inch plastic thread lids at ground level above manufactured tee baffles on both inlet and outlet ends of tank. On outlet end of tank is a 4 inch round yellow effluent filter inserted into baffle that needs to be cleaned at least once a year, Very Important to do. By lifting filter straight upward from baffle and hosing off and reinserting into baffle which I did.

Lift station is a 500 gallon Poly Vinyl Fralo tank with two float zoeller pump with easy disconnect. Pumping through 2 inch schedule 40 pipe to 1 ¼ inch schedule 40 pipe. Alarm is on 4x4 wooden post next to lift station and is working properly red light is lighting and alarm is sounding. Which I also pumped and cleaned with water.

Distribution box is a plastic Tuff Tite box and is 1 inch below ground surface with concrete surrounding for support. Inside box is a 4 inch schedule 40 piped tee baffle and 4 schedule 40 piped lines leaving box through 4 speed levelers equally distributing effluence's to lateral field.

Lateral field is on top of hill and consist of 4 runs of 36 inch plastic infiltrated chambers at 100 feet each totaling 400 feet of laterals that are 12 inches below ground surface with no evidence of any ponding or surfacing above absorption field and no popping sound from probing all 4 laterals.

**NOT RESPOSIBLE FOR ANY FAILED SEPTIC SYSTEMS.**

Permit # 159-05 Linhart Tank & Lateral Inspection 12/16/05  
 Pump Tank and distribution line from pump Tank  
 to laterals to be inspected later.

2953 TRURO RD

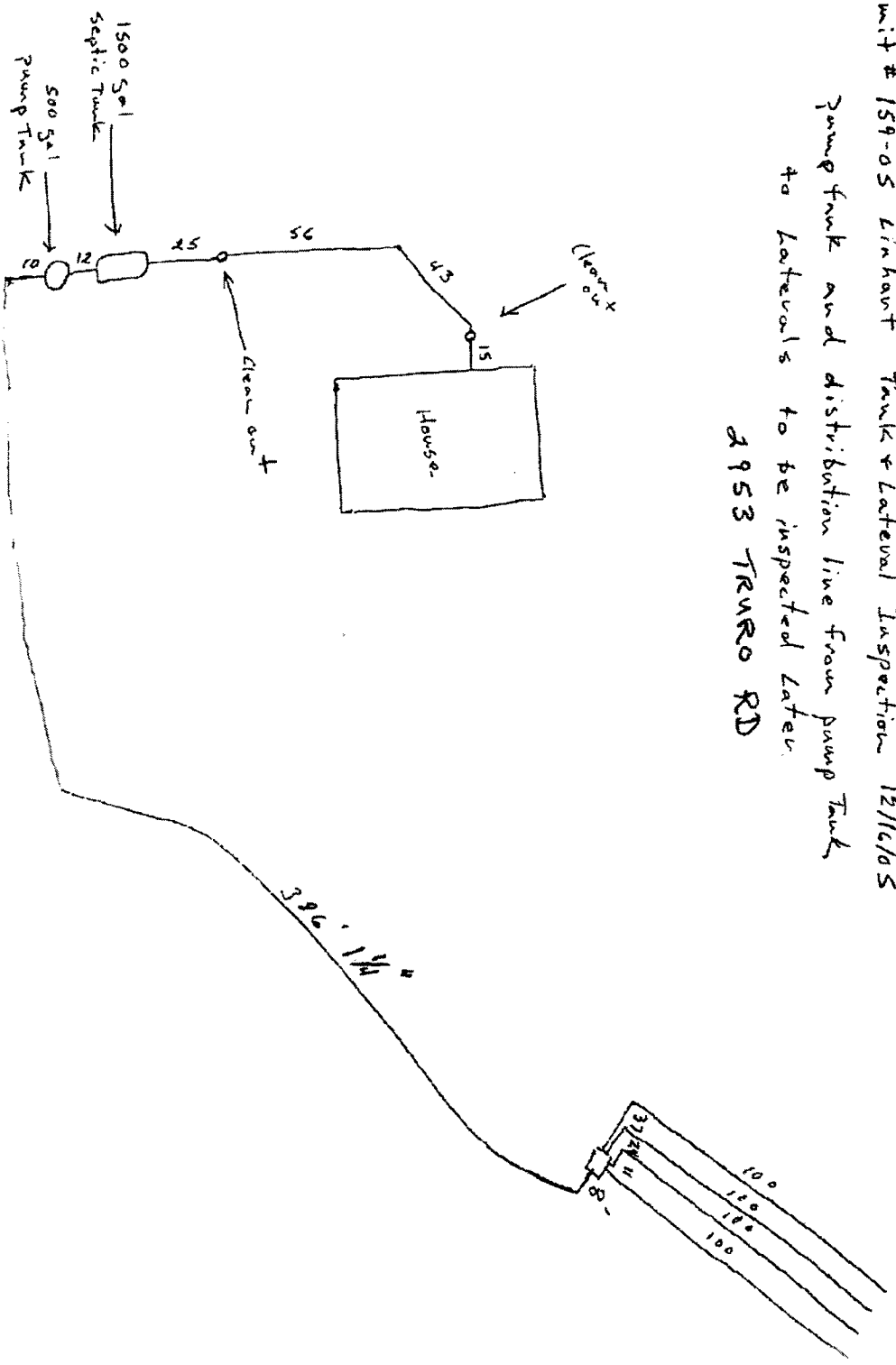

North  
 ↑

Parcel "A" located in the Northeast Quarter (1/4) of the Southeast Quarter (1/4) of Section Ten (10), Township Seventy-four (74) North, Range Twenty-six (26) West of the 5th P.M., Madison County, Iowa, containing 4.45 acres, as shown in Plat of Survey filed in Book 2005, Page 4867 on October 7, 2005 in the Office of the Recorder of Madison County, Iowa, EXCEPT any part thereof conveyed for road purposes or for use as a public highway.