



Document 2017 1785

Book 2017 Page 1785 Type 06 043 Pages 1
Date 6/08/2017 Time 2:49:53PM
Rec Amt \$.00

INDX
ANNO
SCAN
CHEK

LISA SMITH, COUNTY RECORDER
MADISON COUNTY IOWA

Prepared By: Michael James Hackett, Madison County Engineer's Office, 1105 E. Court Ave., Winterset, Ia. 50273, Tel. (515) 462-1136

UNITED STATES PUBLIC LAND SURVEY CORNER CERTIFICATE OF

Land Survey Monuments situated in Section 33, Township 76 N, Range 26 W, of the Fifth Principal Meridian, Madison County, Iowa.
Previously recorded in Book 1, Page 193 & Book 1, Page 258 in County Recorder's Office.
(book, page, document number, etc.)

(Show reason for preparing this certificate, the evidence and detailed procedures used in establishing the corner positions and monumentation found or placed.)

Monument Description and Remarks: Found 1/2" rebar pin, 3" deep in county highway. Traversed the East line of the Southeast Quarter to verify location of the corner. Accepted position. This certificate was prepared because the found tie varied from previous recorded records.

PLAN VIEW

(Show a minimum of three reference ties to durable physical objects, relevant monuments and physical conditions that will enable recovery of the corner.)

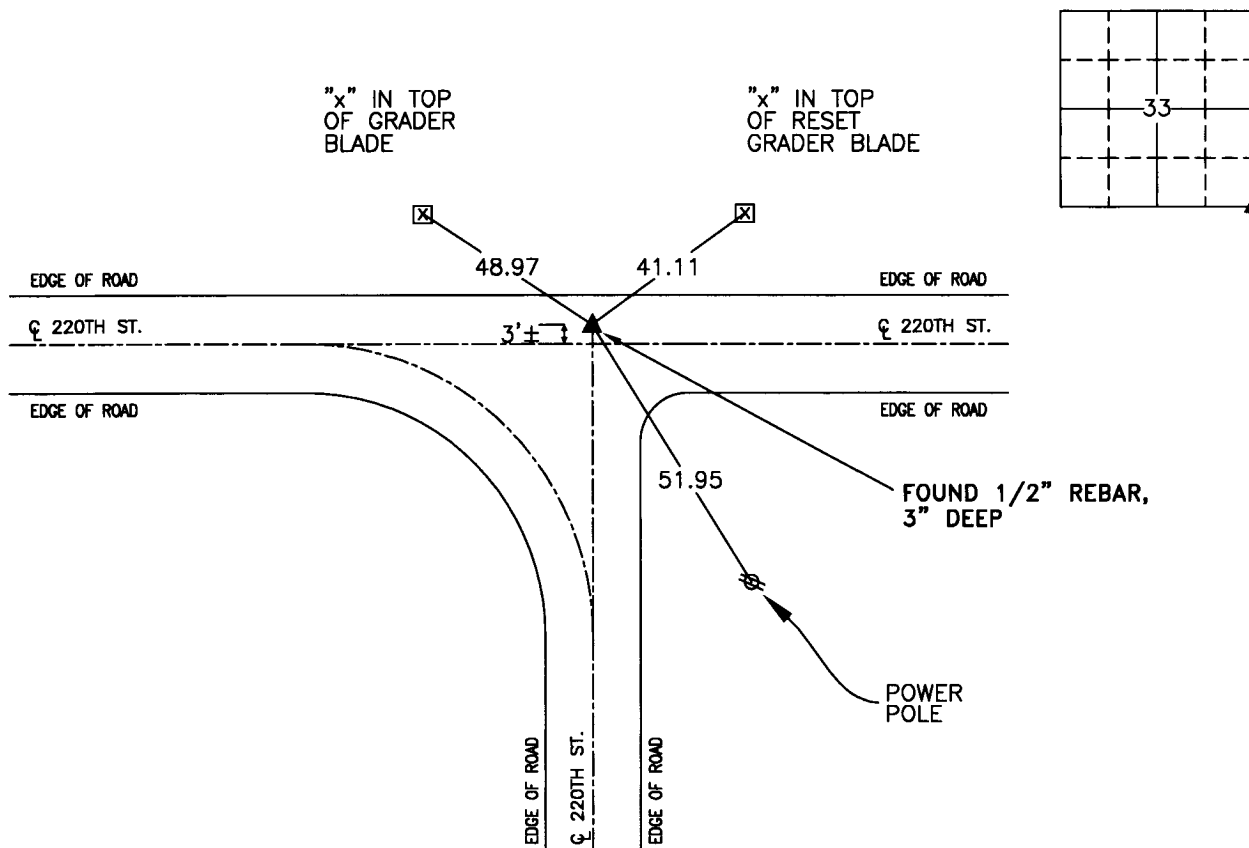

SE. COR., SE. 1/4, SE 1/4 SEC. 33

NOTE: ALL TIES TO "X" NAILS UNLESS NOTED

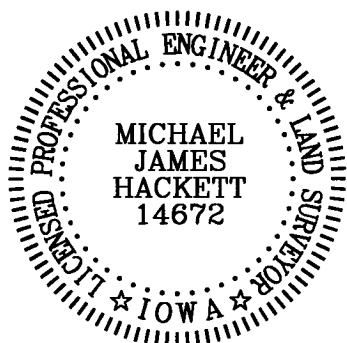

I hereby certify that this land surveying document was prepared and the related survey work was performed by me or under my direct personal supervision and that I am a duly Licensed Land Surveyor under the laws of the State of Iowa.

Signed Michael James Hackett Date 6/7/2017
Michael James Hackett

Iowa license number 14672.
My license renewal date is 12/31/2018.
Pages covered by this seal: 1.