

LISA SMITH, COUNTY RECORDER  
MADISON COUNTY IOWA

IOWA DEPARTMENT OF TRANSPORTATION 2210 E. 7TH ATLANTIC, IOWA 50022 712-243-2009

# UNITED STATES PUBLIC LAND SURVEY CORNER CERTIFICATE

Section 25 Township 76N Range 26W County MADISON

Certificate Prepared For: RE-REFERENCING SECTION CORNERS ALONG  
PRIMARY ROAD IA. 92.



R-26-W

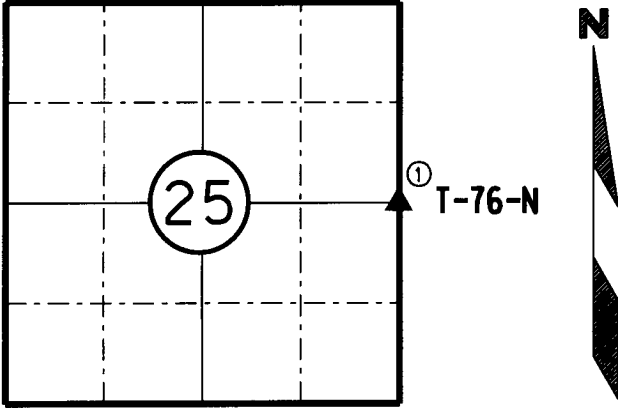

I hereby certify that this land surveying document was prepared by me and the related survey work was performed by me or under my direct supervision and that I am a duly licensed Professional Land Surveyor under the laws of the State of Iowa.

*William J. Fox* 4-26-17  
WILLIAM J. FOX Date

License number 15482  
Pages covered by this seal 1  
My License Renewal date is December 31, 2017

MADISON COUNTY

MONUMENT DESCRIPTION AND REMARKS:

(1) Found Iowa D.O.T. brass plug in bridge deck. Verified by using existing D.O.T. ties.

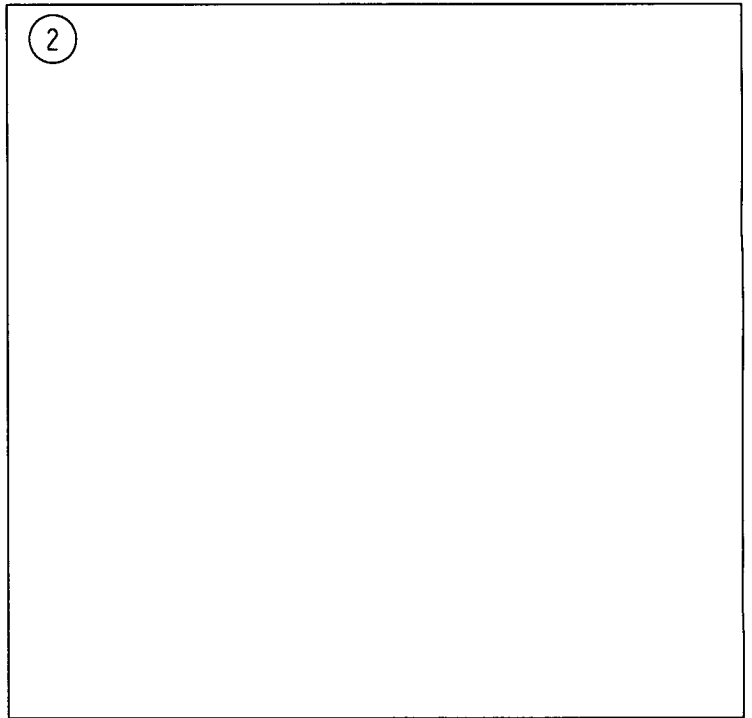
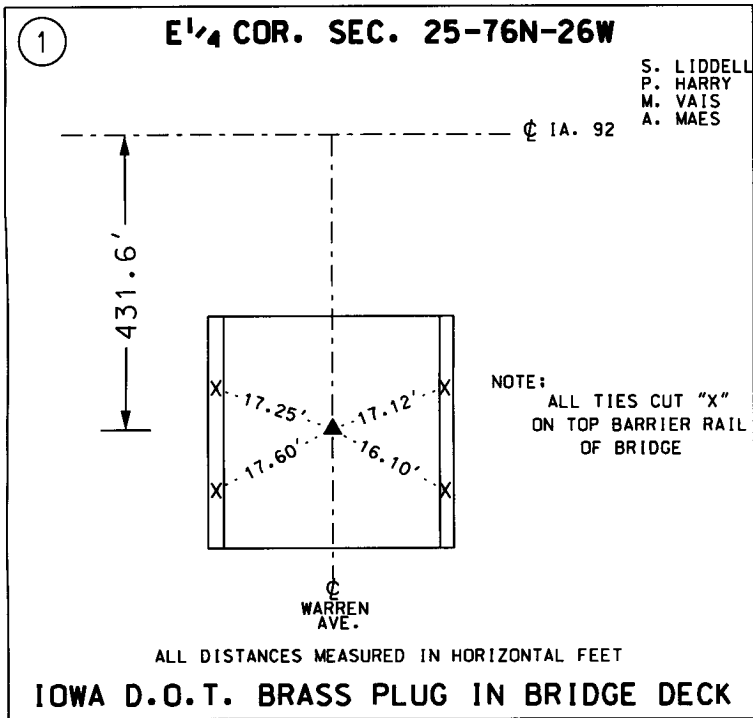

LIST CORNERS TO BE INDEXED:

CORNERS	SECTION	TWP.	RANGE
E COR.	25	76N	26W