

22



Document 2015 3748

Book 2015 Page 3748 Type 06 001 Pages 4
Date 12/21/2015 Time 11:26:47AM
Rec Amt \$22.00

INDX
ANNO
SCAN
CHEK

LISA SMITH, COUNTY RECORDER
MADISON COUNTY IOWA

EL

Prepared by and return to: Bill Miller 515-252-6747
MIDAMERICAN ENERGY ATTN: RIGHT-OF-WAY SERVICES PO BOX 657 DES MOINES, IA 50306-0657

**MIDAMERICAN ENERGY COMPANY
UNDERGROUND ELECTRIC EASEMENT**

Folder No.	<u>351-15</u>	State of	<u>Iowa</u>
Work Req. No.	<u>2508339</u>	County of	<u>Madison</u>
Project No.	<u>A1146</u>	Section	<u>23</u>
		Township	<u>76</u> North
		Range	<u>26</u> West of the 5 th P.M.

1. For and in consideration of the sum of One and no/100—Dollar (\$1.00), and other valuable consideration, in hand paid by MIDAMERICAN ENERGY COMPANY, an Iowa corporation, receipt of which is hereby acknowledged, the undersigned owner(s) **Andrew P. Roby and Sarah A. Roby, Tenants will Full Rights of Survivorship, and not as Tenants in Common**, its successors and assigns ("Grantor"), does hereby grant to MIDAMERICAN ENERGY COMPANY, its successors and assigns ("Grantee"), a perpetual, non-exclusive easement to construct, reconstruct, operate, maintain, replace or remove underground conduits, wires and cables for the transmission and distribution of electric energy and for communication and electrical controls, including other reasonably necessary equipment incident thereto (collectively "Facilities") under and on the surface of the ground, through and across certain property described below, together with the right of ingress and egress to and from the same, and all the rights and privileges incident and necessary to the enjoyment of this easement ("Easement Area").

DESCRIPTION OF PROPERTY CONTAINING EASEMENT AREA:

Parcel "E" located in the Northeast Quarter (1/4) of the Northwest Quarter (1/4) of Section Twenty-three (23), in Township Seventy-six (76) North, Range Twenty-six (26) West of the 5th P.M., Madison County, Iowa, containing 16.647 acres, as shown in Plat of Survey filed in Book 2, Page 702 on July 9, 1996, in the Office of the Recorder of Madison County, Iowa.

EASEMENT AREA:

An underground electric easement over, under, across and through the above described parcel; as generally depicted on Exhibit "A", attached hereto and made a part hereof.

2. Additionally, Grantee shall have the right to remove from the Easement Area described above, any obstructions, including but not limited to, trees, plants, undergrowth, buildings, fences and structures that interfere with the proper operation and maintenance of said Facilities and equipment.

3. Grantor agrees that it will not construct or place any permanent or temporary buildings, structures, fences, trees, plants or other objects on the Easement Area described above or make any changes in ground elevation without written permission from Grantee indicating that said construction or ground elevation changes will not result in inadequate or excessive ground cover, or otherwise interfere with the Grantee's rights to operate and maintain its Facilities.

4. In consideration of such grant, Grantee agrees that it will repair or pay for any damage which may be caused to crops, fences, or other property, real or personal of the Grantor by the construction, reconstruction, maintenance, operation, replacement or removal of the Facilities (except for damage to property placed subsequent to the granting of this easement) that Grantee determines interferes with the operation and maintenance of the Facilities and associated equipment. The cutting, recutting, trimming and removal of trees, branches, saplings, brush or other vegetation on or adjacent to the Easement Area is expected and not considered damage to the Grantor.

5. Additionally, when Grantor provides or installs duct/conduit for said Facilities, this grant shall cover and include all Facilities installed as a part of the Easement Area.

6. Grantor certifies that it is not acting, directly or indirectly, for or on behalf of any person, group, entity or nation named by any Executive Order or the United States Treasury Department as a terrorist, "Specially Designated National and Blocked Person" or any other banned or blocked person, entity, nation or transaction pursuant to any law, order, rule or regulation that is enforced or administered by the Office of Foreign Assets Control; and are not engaged in this transaction, directly or indirectly, on behalf of, any such person, group, entity or nation. Grantor hereby agrees to defend, indemnify and hold harmless the Grantee from and against any and all claims, damages, losses, risks, liabilities and expenses (including attorney's fees and costs) arising from or related to any breach of the foregoing certification.

7. Each of the provisions of this easement shall be enforceable independently of any other provision of this easement and independent of any other claim or cause of action. In the event of any matter of dispute arising out of or related to this easement, it is agreed between the parties that the law of the jurisdiction and location where this easement is recorded (including statute of limitation provisions) will govern the interpretation, validity and effect of this easement without regard to the place of execution or place of performance thereof, or any conflicts or law provisions. **TO THE FULLEST EXTENT PERMITTED BY LAW, EACH OF THE PARTIES HERETO WAIVES ANY RIGHT IT MAY HAVE TO A TRIAL BY JURY IN RESPECT OF LITIGATION DIRECTLY OR INDIRECTLY ARISING OUT OF, UNDER OR IN CONNECTION WITH THIS EASEMENT. EACH PARTY FURTHER WAIVES ANY RIGHT TO CONSOLIDATE ANY ACTION IN WHICH A JURY TRIAL HAS BEEN WAIVED WITH ANY OTHER ACTION IN WHICH A JURY TRIAL CANNOT BE OR HAS NOT BEEN WAIVED.**

8. Grantor hereby relinquishes all rights of dower, homestead and distributive share in and to the property and waives all rights of exemption as to any of the property. Grantor understands that homestead property is in many cases protected from the claims of creditors and exempt from judicial sale; and that by signing this easement, voluntarily gives up any right to this protection for this property with respect to claims based upon this easement.

9. Grantor warrants to Grantee that Grantor holds title to the Easement Area in fee simple and Grantor has good and lawful authority to grant the rights provided in this easement.

(Acknowledgments on following page)

Dated this 4th day of December, 2015



Andrew P. Roby



Sarah A. Roby

ACKNOWLEDGMENT

STATE OF IOWA
COUNTY OF WARREN)^{SS}

This record was acknowledged before me on December 4th, 2015, by Andrew P. Roby and Sarah A. Roby, Tenants with Full Rights of Survivorship, and not as Tenants in Common.

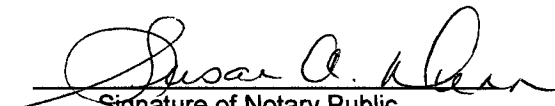

Signature of Notary Public

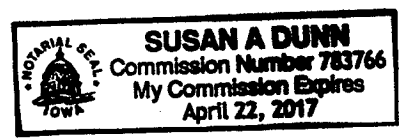

EXHIBIT "A"

Legend

- Subject Property Line
- Easement

Parcel Legal Description:

Parcel "E" located in the Northeast Quarter (1/4) of the Northwest Quarter (1/4) of Section Twenty-three (23), in Township Seventy-six (76) North, Range Twenty-six (26) West of the 5th P.M., Madison County, Iowa, containing 16.647 acres, as shown in Plat of Survey filed in Book 2, Page 702 on July 9, 1996, in the Office of the Recorder of Madison County, Iowa.

Easement Area:

An underground electric easement over, under, across and through the above described parcel.

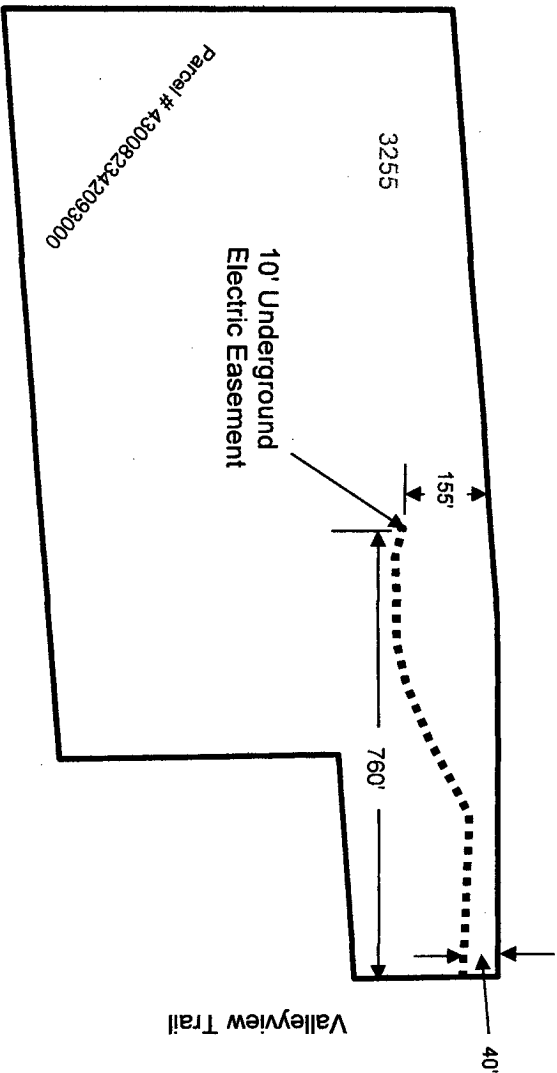

 MidAmerican Energy <small>MEMBER OF THE MIDAMERICAN ENERGY GROUP</small>		Customer: Andrew & Sarah Roby		DR # 2508339	
Address: 3255 Valleyview Trail		Scale: Not to Scale		Date: 11/20/2015	
City: Prole		State: Iowa		Folder: 351-15	
Job Desc: Underground Electric Easement				Sec 23, T 76N, R26 W	

