



Document 2014 2806

Book 2014 Page 2806 Type 06 043 Pages 1
Date 11/06/2014 Time 10:30 AM
Rec Amt \$7.00

INDX
ANNO
SCAN
CHEK

LISA SMITH, COUNTY RECORDER
MADISON COUNTY IOWA

Daniels Land Surveying, 22598 18th Avenue, New Virginia, IA 50210, 515-577-2583

UNITED STATES PUBLIC LAND CORNER CERTIFICATE OF

Land Survey Monuments situated in Section 8, Township 74 N, Range 26 W, of the
5th P.M., Madison County, Iowa. Previously recorded in n.a.
in County Recorders Office. (book, page, document number, etc.)

(Show reason for preparing this certificate, the evidence and detailed procedures used in
establishing the corner positions and monumentation found or placed.)

Monument Description and Remarks:

NW COR., NE 1/4, SW 1/4 - Set 1/2" x 18" red plastic capped rebar, #17532 at
intersection of found 1/4, 1/4 corners to the south with 1/4 line.
CENTER - Set 1/2" x 18" red plastic capped rebar, #17532 using information
gathered while traversing Section 8

PLAN VIEW

(Show a minimum of three reference ties to durable physical objects, relevant monuments
and physical conditions that will enable recovery of the corner.)

ALL TIES TO 30d SPIKES UNLESS NOTED

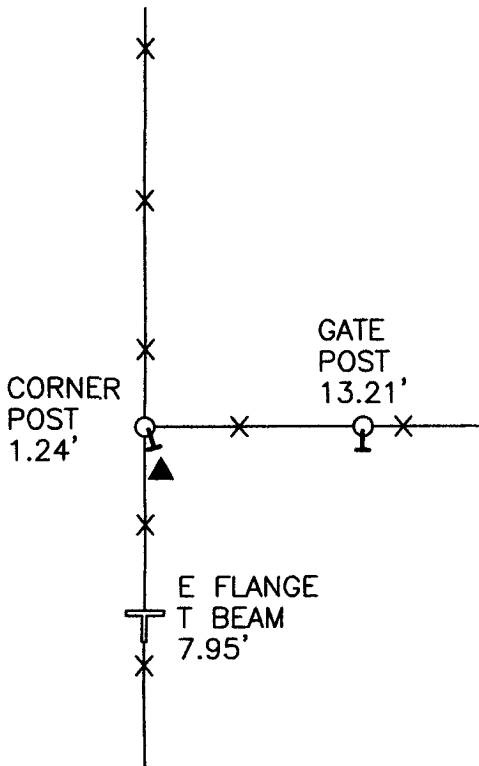
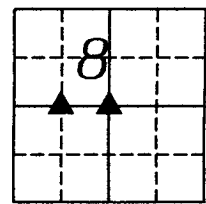

NW COR., NE 1/4, SW 1/4

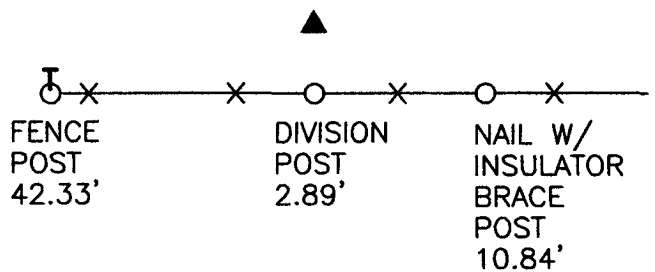

CENTER

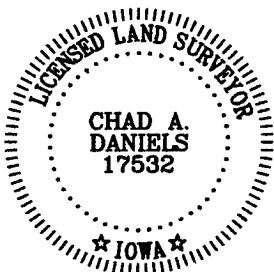

I hereby certify that this land surveying document was prepared and the
related survey work was performed by me or under my direct personal
supervision and that I am a duly licensed Land Surveyor under the laws
of the State of Iowa.

Signature: _____

Chad A. Daniels

11/5/2014
Date

License number 17532
My license renewal date is December 31, 2014

569-01