



Document 2014 GW1831

Book 2014 Page 1831 Type 43 001 Pages 6  
Date 7/28/2014 Time 12:51 PM  
Rec Amt \$.00

INDX  
ANNO  
SCAN

LISA SMITH, COUNTY RECORDER  
MADISON COUNTY IOWA

CHEK

**REAL ESTATE TRANSFER - GROUNDWATER HAZARD STATEMENT  
TO BE COMPLETED BY TRANSFEROR**

**TRANSFEROR:**

Name Eric D. Wedemeyer and Tara J. Wedemeyer  
Address 1651 Hogback Bridge Road, Winterset, IA 50273  
Number and Street or RR City, Town or P.O. State Zip

**TRANSFeree:**

Name Matthew D. Hartman  
Address 1651 Hogback Bridge Road, Winterset, IA 50273  
Number and Street or RR City, Town or P.O. State Zip

Address of Property Transferred:  
1651 Hogback Bridge Road, Winterset, IA 50273  
Number and Street or RR City, Town or P.O. State Zip

Legal Description of Property: (Attach if necessary) Parcel "A" located in the Southeast Quarter (SE 1/4) of the Northeast Quarter (NE 1/4) of Section Three (3), Township Seventy-six (76) North, Range Twenty-eight (28) West of the 5th P.M., Madison County, Iowa, containing 4.083 acres, as shown in Plat of Survey filed in Book 2003, Page 926, on February 20, 2003, in the Office of the Recorder of Madison County, Iowa.

**1. Wells (check one)**

- There are no known wells situated on this property.
- There is a well or wells situated on this property. The type(s), location(s) and legal status are stated below or set forth on an attached separate sheet, as necessary.

**2. Solid Waste Disposal (check one)**

- There is no known solid waste disposal site on this property.
- There is a solid waste disposal site on this property and information related thereto is provided in Attachment #1, attached to this document.

**3. Hazardous Wastes (check one)**

- There is no known hazardous waste on this property.
- There is hazardous waste on this property and information related thereto is provided in Attachment #1, attached to this document.

**4. Underground Storage Tanks (check one)**

- There are no known underground storage tanks on this property. (Note exclusions such as small farm and residential motor fuel tanks, most heating oil tanks, cisterns and septic tanks, in instructions.)
- There is an underground storage tank on this property. The type(s), size(s) and any known substance(s) contained are listed below or on an attached separate sheet, as necessary.

**5. Private Burial Site (check one)**

- There are no known private burial sites on this property.
- There is a private burial site on this property. The location(s) of the site(s) and known identifying information of the decedent(s) is stated below or on an attached separate sheet, as necessary.

**6. Private Sewage Disposal System (check one)**

- All buildings on this property are served by a public or semi-public sewage disposal system.
- This transaction does not involve the transfer of any building which has or is required by law to have a sewage disposal system.
- There is a building served by private sewage disposal system on this property or a building without any lawful sewage disposal system. A certified inspector's report is attached which documents the condition of the private sewage disposal system and whether any modifications are required to conform to standards adopted by the Department of Natural Resources. A certified inspection report must be accompanied by this form when recording.
- There is a building served by private sewage disposal system on this property. Weather or other temporary physical conditions prevent the certified inspection of the private sewage disposal system from being conducted. The buyer has executed a binding acknowledgment with the county board of health to conduct a certified inspection of the private sewage disposal system at the earliest practicable time and to be responsible for any required modifications to the private sewage disposal system as identified by the certified inspection. A copy of the binding acknowledgment is attached to this form.
- There is a building served by private sewage disposal system on this property. The buyer has executed a binding acknowledgment with the county board of health to install a new private sewage disposal system on this property within an agreed upon time period. A copy of the binding acknowledgment is provided with this form.
- There is a building served by private sewage disposal system on this property. The building to which the sewage disposal system is connected will be demolished without being occupied. The buyer has executed a binding acknowledgment with the county board of health to demolish the building within an agreed upon time period. A copy of the binding acknowledgment is provided with this form. [Exemption #9]
- This property is exempt from the private sewage disposal inspection requirements pursuant to the following exemption [Note: for exemption #9 use prior check box]: \_\_\_\_\_
- The private sewage disposal system has been installed within the past two years pursuant to permit number \_\_\_\_\_

Information required by statements checked above should be provided here or on separate sheets attached hereto:

~~1st~~ 1st well is 25 feet SW of House 28' Depth  
 2nd well is 40 feet off NE corner of Shop 36' Depth

**I HEREBY DECLARE THAT I HAVE REVIEWED THE INSTRUCTIONS FOR THIS FORM AND THAT THE INFORMATION STATED ABOVE IS TRUE AND CORRECT.**

Signature: *Erin Madigan*  
(Transferor or Agent)

Telephone No.: (515) 205-5590



# Time of Transfer Inspection Report

### Property Information

Current Owner: Eric Wedemeyer  
 Buyer: Matthew Hartman Realtor: Peter Corkrean  
 Mailing Address: \_\_\_\_\_  
 Site Address/County: 1651 Hogback Bridge Rd Winterset Ia.  
 Legal Description As Abstract 50273  
 No. of bedrooms: 2 Last occupied: occupied Records available: yes  
 Permit/ installation date: 11-25-06 Separation distances (ok/no?): (ok)

### Septic System Information

Septic tank(s): Size: 1500 gal. Material: conc. Condition: good  
 Tank pumped?  Y  N Date: 7-8-14 Licensed pumper: Forest Septic Env.  
~~Septic/Trash/Processing tank: Size: \_\_\_\_\_ Material: \_\_\_\_\_ Condition: \_\_\_\_\_  
 Tank pumped?  Y  N Date: \_\_\_\_\_ Licensed pumper: \_\_\_\_\_  
 Aerobic treatment unit (ATU) mfr \_\_\_\_\_ Size \_\_\_\_\_  
 Tank pumped?  Y  N Date: \_\_\_\_\_ Licensed pumper: \_\_\_\_\_  
 Maintenance contract?  Y  N Expiration date: \_\_\_\_\_ Service provider: \_\_\_\_\_  
 Condition: \_\_\_\_\_  
 Pump tanks/vaults: Type: \_\_\_\_\_ Size: \_\_\_\_\_ Condition: \_\_\_\_\_  
 Distribution system: Distribution box yes Outlets used 3 Condition: good  
 Header pipe(s): \_\_\_\_\_ No. of lines: \_\_\_\_\_ Pressure dosed? \_\_\_\_\_~~

### Secondary Treatment:

Length of absorption fields: 3 100' laterals Determined by: drawing  
 Condition of fields: good/dry Determined by: hydraulic test  
 Type of trench material: 24" Chamber  
~~Size of sand filter: \_\_\_\_\_ Determined by: \_\_\_\_\_  
 Vent pipes above grade?  Y  N Discharge pipe located?  Y  N  
 Effluent sample taken \_\_\_\_\_ Results: \_\_\_\_\_  
 Media Filters: Type: \_\_\_\_\_  
 Maintenance contract?  Y  N Expiration date: \_\_\_\_\_ Service provider: \_\_\_\_\_  
 Condition: \_\_\_\_\_  
 NPDES General Permit No. 4: Required?  Y  N Permitted?  Y  N NOI provided: \_\_\_\_\_~~



## Time of Transfer Inspection Report

Other components:

Alarms:  Y  N Working:  Y  N Disinfection:  Y  N Working:  Y  N

Control Box: \_\_\_\_\_ Timers: \_\_\_\_\_ Inspection Ports: \_\_\_\_\_

Other components: \_\_\_\_\_

Overall condition of the private sewage disposal system:

Report system status: see at tatched

Explain (attach additional pages as needed): \_\_\_\_\_

Comments: \_\_\_\_\_

Site status at conclusion of Time of Transfer inspection:

- Verify that controls are set on the appropriate mode.
- Power is on to all components.
- Revisit all components to verify lids are secure.
- Gather all tools for removal from the site.
- Verify that no sewage is on the ground surface.

Using this worksheet, write a narrative report of the inspection results and attach a site sketch.

This report indicates the condition of the private sewage disposal system at the time of the inspection. It does not guarantee that it will continue to function satisfactorily.

Signature of Certified Inspector: Brian Riñard Date: 7-8-14

Name (print): Brian Riñard Certificate #: 8805

Address: P.O. Box 319 Ind. Ia. 50125

Phone #: 515-961-2113

Provide a copy of this report, the narrative report and sketch to the seller/agent, buyer/agent or the person ordering the inspection, the county sanitarian/environmental health office and to:

Iowa DNR  
Private Sewage Disposal Program  
502 E 9<sup>th</sup> St  
Des Moines IA 50319

DNR Time of Transfer Report System Status

Address: 1651 Hogback Bridge Rd. Date: 7-8-14  
Winterset Ia. 50273

Comments: Technician Brian Rinard

All waste water from house drains to  
septic system.

The tank is a 1500 gal. Cone. tank  
in good condition.

The Distribution Box & all laterals  
were in good working condition.

This is not a guarantee!

This certifies that the septic  
system was in good working condition  
at the time of the inspection.

see  
county's  
drawing

DIAGRAM OF SYSTEM

Permit # 153-06  
1651 Hogback Bridge Rd.

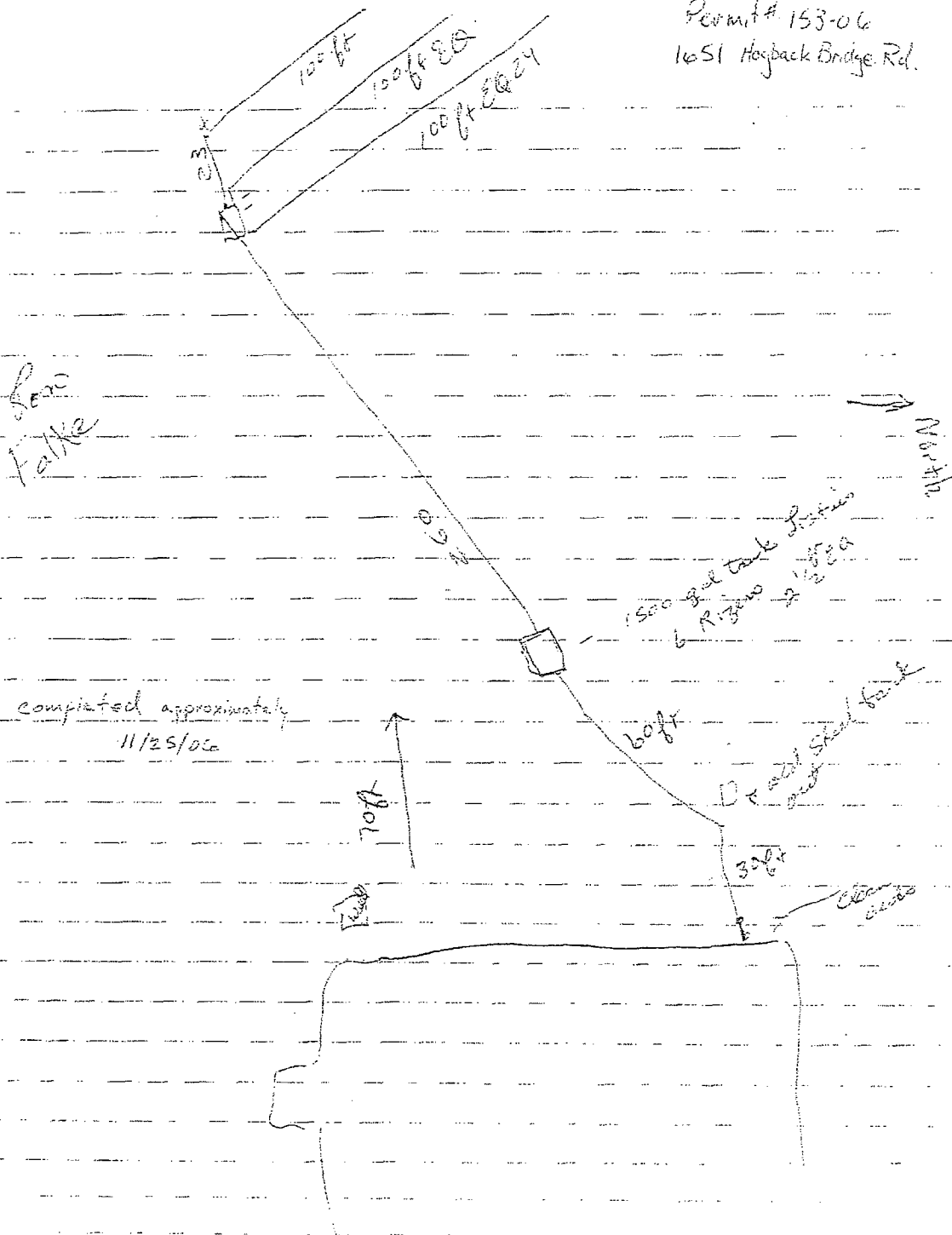

completed approximately  
11/25/06

Fox  
Lake

North

1500 gal tank  
Rising 2 1/2 ft

Deer and Steel tank

Cedar Grove