



Document 2013 GW2783

Book 2013 Page 2783 Type 43 001 Pages 6

Date 9/18/2013 Time 10:42 AM

Rec Amt \$.00

INDX ✓
ANNO
SCAN

LISA SMITH, COUNTY RECORDER
MADISON COUNTY IOWA

CHEK

**REAL ESTATE TRANSFER - GROUNDWATER HAZARD STATEMENT
TO BE COMPLETED BY TRANSFEROR**

TRANSFEROR:

Name Richard Arnold

Address 2377 132nd Court, Van Meter, Iowa 50261

Number and Street or RR

City, Town or P.O.

State

Zip

TRANSFeree:

Name Ryan Matthias

Address 2377 132nd Court, Van Meter, Iowa 50261

Number and Street or RR

City, Town or P.O.

State

Zip

Address of Property Transferred:

2377 132nd Court, Van Meter, Iowa 50261

Number and Street or RR

City, Town or P.O.

State

Zip

Legal Description of Property: (Attach if necessary) See 1 in Addendum

1. Wells (check one)

There are no known wells situated on this property.

There is a well or wells situated on this property. The type(s), location(s) and legal status are stated below or set forth on an attached separate sheet, as necessary.

2. Solid Waste Disposal (check one)

There is no known solid waste disposal site on this property.

There is a solid waste disposal site on this property and information related thereto is provided in Attachment #1, attached to this document.

3. Hazardous Wastes (check one)

There is no known hazardous waste on this property.

There is hazardous waste on this property and information related thereto is provided in Attachment #1, attached to this document.

4. Underground Storage Tanks (check one)

There are no known underground storage tanks on this property. (Note exclusions such as small farm and residential motor fuel tanks, most heating oil tanks, cisterns and septic tanks, in instructions.)

There is an underground storage tank on this property. The type(s), size(s) and any known substance(s) contained are listed below or on an attached separate sheet, as necessary.

5. Private Burial Site (check one)

- There are no known private burial sites on this property.
- There is a private burial site on this property. The location(s) of the site(s) and known identifying information of the decedent(s) is stated below or on an attached separate sheet, as necessary.

6. Private Sewage Disposal System (check one)

- All buildings on this property are served by a public or semi-public sewage disposal system.
- This transaction does not involve the transfer of any building which has or is required by law to have a sewage disposal system.
- There is a building served by private sewage disposal system on this property or a building without any lawful sewage disposal system. A certified inspector's report is attached which documents the condition of the private sewage disposal system and whether any modifications are required to conform to standards adopted by the Department of Natural Resources. A certified inspection report must be accompanied by this form when recording.
- There is a building served by private sewage disposal system on this property. Weather or other temporary physical conditions prevent the certified inspection of the private sewage disposal system from being conducted. The buyer has executed a binding acknowledgment with the county board of health to conduct a certified inspection of the private sewage disposal system at the earliest practicable time and to be responsible for any required modifications to the private sewage disposal system as identified by the certified inspection. A copy of the binding acknowledgment is attached to this form.
- There is a building served by private sewage disposal system on this property. The buyer has executed a binding acknowledgment with the county board of health to install a new private sewage disposal system on this property within an agreed upon time period. A copy of the binding acknowledgment is provided with this form.
- There is a building served by private sewage disposal system on this property. The building to which the sewage disposal system is connected will be demolished without being occupied. The buyer has executed a binding acknowledgment with the county board of health to demolish the building within an agreed upon time period. A copy of the binding acknowledgment is provided with this form. [Exemption #9]
- This property is exempt from the private sewage disposal inspection requirements pursuant to the following exemption [Note: for exemption #9 use prior check box]: _____.
- The private sewage disposal system has been installed within the past two years pursuant to permit number _____.

Information required by statements checked above should be provided here or on separate sheets attached hereto:

I HEREBY DECLARE THAT I HAVE REVIEWED THE INSTRUCTIONS FOR THIS FORM AND THAT THE INFORMATION STATED ABOVE IS TRUE AND CORRECT.

Signature: _____

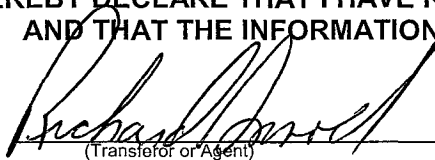

(Transferor or Agent)

Telephone No.: 515 681 4056

Addendum

1. Lot Sixteen (16) of Prairie Ridge Estates located in the North Half ($\frac{1}{2}$) of the Northeast Quarter ($\frac{1}{4}$), the Southwest Quarter ($\frac{1}{4}$) of the Northeast Quarter ($\frac{1}{4}$), and the Northeast Quarter ($\frac{1}{4}$) of the Northwest Quarter ($\frac{1}{4}$) of Section Twenty (20), Township Seventy-seven (77) North, Range Twenty-seven (27) West of the 5th P.M., Madison County, Iowa, together with the undivided percentage interest in the general common elements as set forth in the Declaration of Association for Prairie Ridge Estates Association filed in Book 2002, Page 2126 of the Madison County Recorder's Office.



Seller

Time of Transfer Inspection Report (DNR Form 542-0191)

Property information

Current owner Richard & Cynthia Arnold
Buyer _____ Realtor Kelly Williams
Mailing address _____

Site Address/County 2377-132nd St, Van Meter, Ia. 50261
Legal Description _____ Madison Co.

No. of bedrooms 3 Last occupied? is now Records available yes

Permit/installation date July 2004 Separation distances ok/no? OK
L7A070-04

Septic system information

Septic tank(s): size 1500 gal material Concrete condition good
Tank pumped? yes date 9-10-13 licensed pumper Mages S.T. 75
Septic/trash/processing tank: size _____ material _____ condition _____
Tank pumped? _____ date _____ licensed pumper _____

Aerobic treatment unit (ATU) mfg _____ size _____
Tank pumped? _____ date _____ licensed pumper _____
Maintenance contract? _____ expiration date _____ service provider _____
Condition _____

Pump tanks/vaults: type _____ size _____ condition _____

Distribution system: distribution box Plastic outlets used 6 condition good
Header pipe(s) 6 # of lines 6 Pressure dosed? _____

Secondary treatment:
length of absorption fields 16 ft 60" long determined by most probing
condition of fields Good determined by walking & probing
type of trench material 36" chamber

Size of sand filter _____ determined by _____
Vent pipes above grade? _____ discharge pipe located? _____
Effluent sample taken? _____ Results _____

Media filters: type _____
Maintenance contract? _____ expiration date _____ service provider _____
Condition _____

NPDES General Permit No. 4: required? _____ permitted? _____ NOI provided _____



Time of Transfer Inspection Report

Other components:
 Alarms _____ Working? _____ disinfection _____ working? _____
 Control box _____ Timers _____ inspection ports _____
 Other components _____

Overall condition of the private sewage disposal system

Report system status The septic system at 2377-132 st. Ct. Van Meter, Ia.

Explain (attach additional pages as needed): is in good working cond. the septic tank was opened & pumped on 9-10-13 - has 2 compartments

Comments: intake & outflow baffles are in place - there are no cracks in the tank but water level was at correct level before pumping. The dirt box was opened on 9-10-13 - it was in good cond. also all laterals took water on 9-10-13 - also all gray water goes to system on 9-10-13

Site status at conclusion of Time of Transfer inspection:

- Verify that controls are set on the appropriate mode.
 - Power is on to all components.
 - Revisit all components to verify lids are secure.
 - Gather all tools for removal from the site.
 - Verify that no sewage is on the ground surface. none on 9-10-13
- Done

Using this worksheet, write a narrative report of the inspection results and attach a site sketch.

This report indicates the condition of the private sewage disposal system at the time of the inspection. It does not guarantee that it will continue to function satisfactorily.

Signature of Certified inspector: John W. Mayer Date: 9-10-2013
 Name (print): _____ Certificate #: 8979
 Address: _____
 Phone #: 515-462-2624

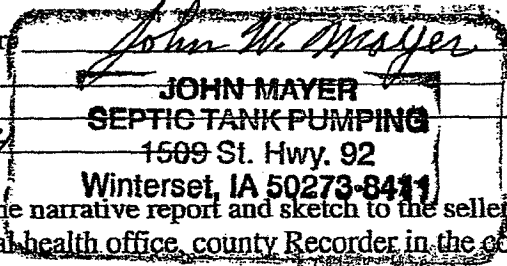

Provide a copy of this report, the narrative report and sketch to the seller/agent, buyer/agent, the county sanitarian/environmental health office, county Recorder in the county the inspection was conducted and to;

Iowa DNR Onsite Wastewater Program
 502 E. 9th St.
 Des Moines, IA 50319

map on back ->

Richard & Cynthia Arnold Permit # 070-04

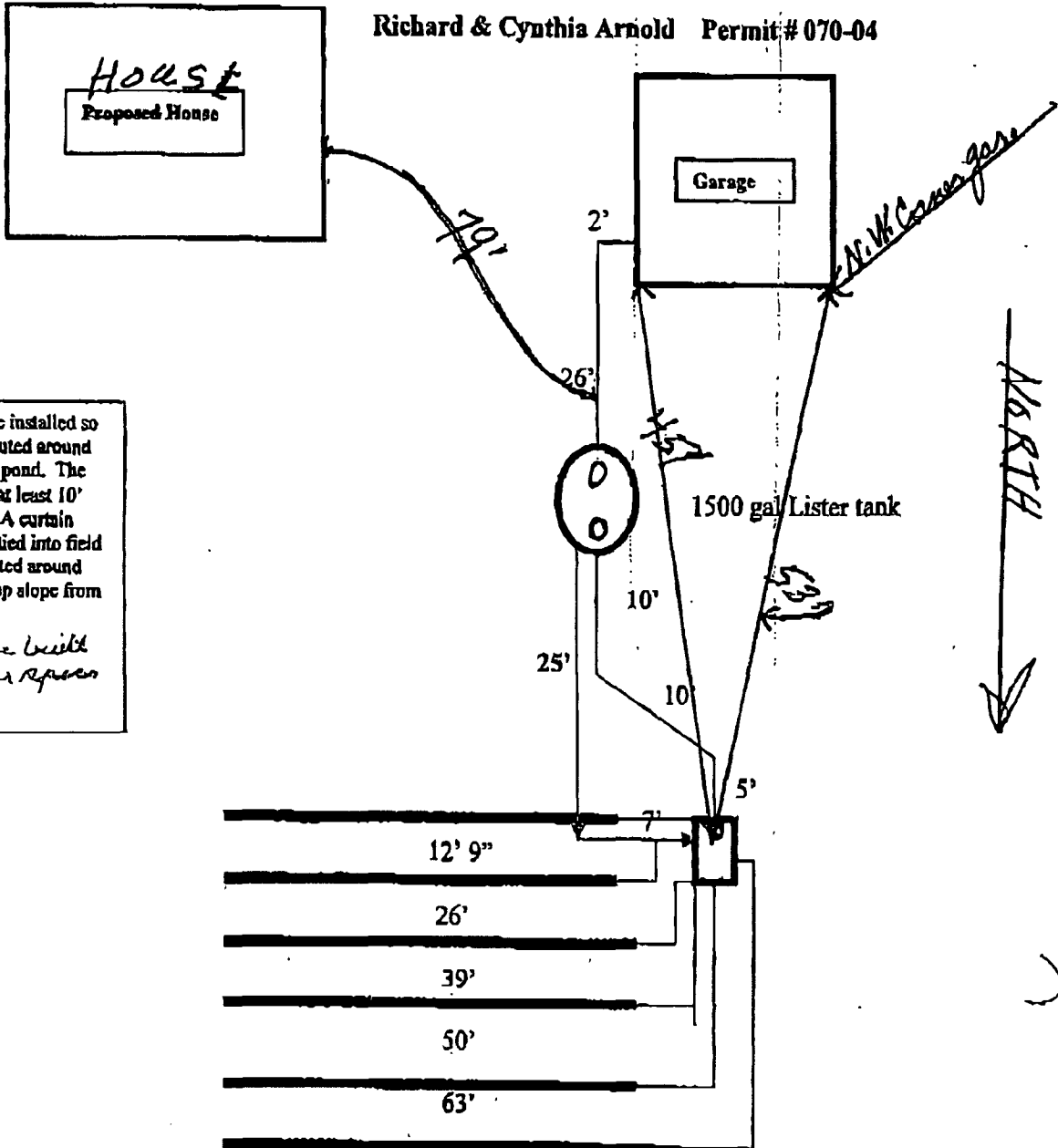

A berm will be installed so the water is routed around lateral field to pond. The berm shall be at least 10' from laterals. A curtain drain shall be tied into field drains and routed around lateral field. (up slope from berm)
Berm to be built to Engineer's specs

36" chamber 6 @ 60'