



Document 2013 GW874

Book 2013 Page 874 Type 43 001 Pages 3
Date 3/26/2013 Time 3:25 PM
Rec Amt \$.00

INDX ✓
ANNO
SCAN
CHEK

LISA SMITH, COUNTY RECORDER
MADISON COUNTY IOWA

**REAL ESTATE TRANSFER - GROUNDWATER HAZARD STATEMENT
TO BE COMPLETED BY TRANSFEROR**

TRANSFEROR:

Name Edna Marie Taylor
Address 302 River Rd Bevington IA 50033
Number and Street or RR City, Town or P.O. State Zip

TRANSFeree:

Name Pontier Properties, L.L.C.
Address 11607 60th Ave Prole IA 50229
Number and Street or RR City, Town or P.O. State Zip

Address of Property Transferred:
302 River Rd Bevington IA 50033
Number and Street or RR City, Town or P.O. State Zip

Legal Description of Property: (Attach if necessary)

SEE EXHIBIT "A" ATTACHED HERETO AND MADE A PART HEREOF

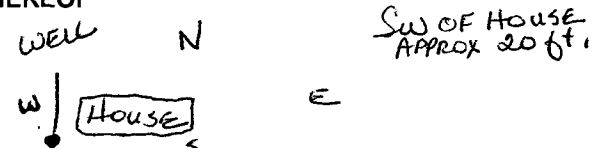

1. Wells (check one)

- There are no known wells situated on this property.
- There is a well or wells situated on this property. The type(s), location(s) and legal status are stated below or set forth on an attached separate sheet, as necessary.

2. Solid Waste Disposal (check one)

- There is no known solid waste disposal site on this property.
- There is a solid waste disposal site on this property and information related thereto is provided in Attachment #1, attached to this document.

3. Hazardous Wastes (check one)

- There is no known hazardous waste on this property.
- There is hazardous waste on this property and information related thereto is provided in Attachment #1, attached to this document.

4. Underground Storage Tanks (check one)

- There are no known underground storage tanks on this property. (Note exclusions such as small farm and residential motor fuel tanks, most heating oil tanks, cisterns and septic tanks, in instructions.)
- There is an underground storage tank on this property. The type(s), size(s) and any known substance(s) contained are listed below or on an attached separate sheet, as necessary.

5. Private Burial Site (check one)

- There are no known private burial sites on this property.
- There is a private burial site on this property. The location(s) of the site(s) and known identifying information of the decedent(s) is stated below or on an attached separate sheet, as necessary.

6. Private Sewage Disposal System (check one)

- All buildings on this property are served by a public or semi-public sewage disposal system.
- This transaction does not involve the transfer of any building which has or is required by law to have a sewage disposal system.
- There is a building served by private sewage disposal system on this property or a building without any lawful sewage disposal system. A certified inspector's report is attached which documents the condition of the private sewage disposal system and whether any modifications are required to conform to standards adopted by the Department of Natural Resources. A certified inspection report must be accompanied by this form when recording.
- There is a building served by private sewage disposal system on this property. Weather or other temporary physical conditions prevent the certified inspection of the private sewage disposal system from being conducted. The buyer has executed a binding acknowledgment with the county board of health to conduct a certified inspection of the private sewage disposal system at the earliest practicable time and to be responsible for any required modifications to the private sewage disposal system as identified by the certified inspection. A copy of the binding acknowledgment is attached to this form.
- There is a building served by private sewage disposal system on this property. The buyer has executed a binding acknowledgment with the county board of health to install a new private sewage disposal system on this property within an agreed upon time period. A copy of the binding acknowledgment is provided with this form.
- There is a building served by private sewage disposal system on this property. The building to which the sewage disposal system is connected will be demolished without being occupied. The buyer has executed a binding acknowledgment with the county board of health to demolish the building within an agreed upon time period. A copy of the binding acknowledgment is provided with this form. [Exemption #9]
- This property is exempt from the private sewage disposal inspection requirements pursuant to the following exemption [Note: for exemption #9 use prior check box]: _____.
- The private sewage disposal system has been installed within the past two years pursuant to permit number _____.

Information required by statements checked above should be provided here or on separate sheets attached hereto:

I HEREBY DECLARE THAT I HAVE REVIEWED THE INSTRUCTIONS FOR THIS FORM AND THAT THE INFORMATION STATED ABOVE IS TRUE AND CORRECT.

Signature: Edm. J. [Signature] Telephone No.: (515) 371-7606
 (Transferor or Agent)

EXHIBIT "A"

TRACT I: Blocks Eighteen (18) and Nineteen (19), in the Original Town of Bevington, Madison County, Iowa, and the vacated street lying on either side of said Block Eighteen (18); AND a tract of land located in the Northeast Quarter (1/4) of the Southeast Quarter (1/4) of Section Twenty-five (25), Township Seventy-six (76) North, Range Twenty-six (26) West of the 5th P.M., Madison County, Iowa more particularly described as follows to-wit: Commencing at the Southwest corner of the above-named Block Nineteen (19), thence South to the center of Middle River, thence in a Northeasterly direction, with the meanderings of Middle River, to a point directly South of the Southwest corner of Block Seventeen (17), thence North to the Southwest corner of Block Seventeen (17), thence Southwesterly to the point of beginning

AND

TRACT II: All that part of Blocks Thirteen (13) and Fourteen (14), and the vacated streets lying on either side of said Block Fourteen(14), lying South of Iowa Highway No. 92; all in the City of Bevington, Madison County, Iowa

AND

ALL that part of the former Des Moines, Winterset & Southwestern Railroad Company (now known as Chicago, Rock Island and Pacific Railroad Company) Right-of-Way lying between said Tract I and said Tract II, all in the City of Bevington, Madison County, Iowa; that part of River Road that lies in said Tract II and in the said former Railroad Right-of-Way being subject to the exclusive control of the City of Bevington