

99

FILED NO

BOOK 2 PAGE 592

95 JUL 12 AM 10: 58

MICHELLE L. HOCHSTETLER
RECORDING
MADISON COUNTY, IOWA

REC'D
COMPUTER
RECORDED
CONTACTED

PLAT OF SURVEY FOR JIM ALGOE
IN THE SW. 1/4 OF THE NW. 1/4 OF
SECTION 26, T75N, R27W OF THE 5TH P.M.,
MADISON COUNTY, IOWA

Date of Survey
June 7, 1995

- FOUND 5/8" IRON ROD
- SET CIR #6808
- EXISTING FENCE

Parcel "A" located in the Southeast Quarter of the Northwest Quarter of Section 26, Township 75 North, Range 27 West of the 5th Principal Meridian, Madison County, Iowa, more particularly described as follows:

Commencing at the West Quarter corner of Section 26, T75N, R27W of the 5th P.M., Madison County, Iowa; thence, along the South line of the SW. 1/4 of the NW. 1/4 of said Section 26, North 90°00'00" East 429.26 feet to the Point of Beginning; thence North 00°13'59" West 278.16 feet; thence North 90°00'00" East 533.05 feet, thence South 00°13'59" East 278.16 feet to said South line of the SW. 1/4 of the NW. 1/4; thence, along said South line, South 90°00'00" West 533.05 feet to the Point of Beginning. Said Parcel "A" contains 3.404 acres, including 0.404 acres of county road right of way

533.05'
N90°00'00"E

PARCEL "A"

Gross area 3.404 acres
Co. Rd. ROW 0.404 acres
Net area 3.000 acres

533.05'
S90°00'00"W

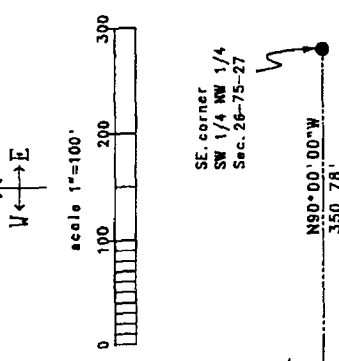

scale 1"=100'

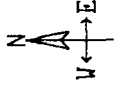

SE. corner
SW 1/4 NW 1/4
Sec. 26-75-27

W. 1/4 corner
Sec. 26-75-27

S89°59'59"E
429.26'

N90°00'00"W
350.78'

33' county road ROW

I HEREBY CERTIFY THAT THE FOREGOING PLAN, SPECIFICALLY THIS PLAT, MAP, SURVEY OR RECORD WAS MADE BY ME OR UNDER MY DIRECT PERSONAL SUPERVISION AND THAT I AM A LICENSED PROFESSIONAL ENGINEER AND LAND SURVEYOR UNDER THE LAWS OF THE STATE OF IOWA.

SIGNED: *J.M. Hochstetler* DATE: *6/12/95*

J.M. Hochstetler, I.A. Reg. No. 6808
My Registration Expires December 31, 1995

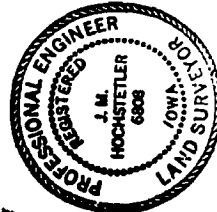

VANCE & HOCHSTETLER, P.C.
CONSULTING ENGINEERS
71 JEFFERSON STREET
WINTERSSET, IOWA 50273