



Document 2012 GW1547

Book 2012 Page 1547 Type 43 001 Pages 6

Date 5/29/2012 Time 11:49 AM

Rec Amt \$.00

INDX ✓
ANNO
SCAN
CHEK

LISA SMITH, COUNTY RECORDER
MADISON COUNTY IOWA

**REAL ESTATE TRANSFER - GROUNDWATER HAZARD STATEMENT
TO BE COMPLETED BY TRANSFEROR**

TRANSFEROR:

Name James C. Eller

Address 321 N 9th St., Winterset, IA 50273

Number and Street or RR

City, Town or P.O.

State

Zip

TRANSFeree:

Name Terri Lenig and John Lenig

Address 2614 180th St., Corydon, IA 50060

Number and Street or RR

City, Town or P.O.

State

Zip

Address of Property Transferred:

1796 State Hwy 92, Winterset, IA 50273

Number and Street or RR

City, Town, or P.O.

State

Zip

Legal Description of Property: (Attach if necessary) Parcel "A" located in the Northeast Quarter (1/4) of the Northeast Quarter (1/4) of Section Five (5), Township Seventy-five (75) North, Range Twenty-eight (28) West of the 5th P.M., Madison County, Iowa, containing 3.00 acres, as shown in Plat of Survey filed in Book 3, Page 22 on June 18, 1997, in the Office of the Recorder of Madison County, Iowa

1. Wells (check one)

There are no known wells situated on this property.

There is a well or wells situated on this property. The type(s), location(s) and legal status are stated below or set forth on an attached separate sheet, as necessary.

2. Solid Waste Disposal (check one)

There is no known solid waste disposal site on this property.

There is a solid waste disposal site on this property and information related thereto is provided in Attachment #1, attached to this document.

3. Hazardous Wastes (check one)

There is no known hazardous waste on this property.

There is hazardous waste on this property and information related thereto is provided in Attachment #1, attached to this document.

4. Underground Storage Tanks (check one)

There are no known underground storage tanks on this property. (Note exclusions such as small farm and residential motor fuel tanks, most heating oil tanks, cisterns and septic tanks, in instructions.)

There is an underground storage tank on this property. The type(s), size(s) and any known substance(s) contained are listed below or on an attached separate sheet, as necessary.

5. Private Burial Site (check one)

- There are no known private burial sites on this property.
- There is a private burial site on this property. The location(s) of the site(s) and known identifying information of the decedent(s) is stated below or on an attached separate sheet, as necessary.

6. Private Sewage Disposal System (check one)

- All buildings on this property are served by a public or semi-public sewage disposal system.
- This transaction does not involve the transfer of any building.
- There is a building served by private sewage disposal system on this property or a building without any lawful sewage disposal system. A certified inspector's report is attached which documents the condition of the private sewage disposal system and whether any modifications are required to conform to standards adopted by the Department of Natural Resources. A certified inspection report must be accompanied by this form when recording.
- There is a building served by private sewage disposal system on this property. Weather or other temporary physical conditions prevent the certified inspection of the private sewage disposal system from being conducted. The buyer has executed a binding acknowledgment with the county board of health to conduct a certified inspection of the private sewage disposal system at the earliest practicable time and to be responsible for any required modifications to the private sewage disposal system as identified by the certified inspection. A copy of the binding acknowledgment is attached to this form.
- There is a building served by private sewage disposal system on this property. The buyer has executed a binding acknowledgment with the county board of health to install a new private sewage disposal system on this property within an agreed upon time period. A copy of the binding acknowledgment is provided with this form.
- There is a building served by private sewage disposal system on this property. The building to which the sewage disposal system is connected will be demolished without being occupied. The buyer has executed a binding acknowledgment with the county board of health to demolish the building within an agreed upon time period. A copy of the binding acknowledgment is provided with this form. [Exemption #9]
- This property is exempt from the private sewage disposal inspection requirements pursuant to the following exemption [Note: for exemption #9 use prior check box]: _____
- The private sewage disposal system has been installed within the past two years pursuant to permit number _____

Information required by statements checked above should be provided here or on separate sheets attached hereto:

Approx: matley 50 ft west of house

I HEREBY DECLARE THAT I HAVE REVIEWED THE INSTRUCTIONS FOR THIS FORM AND THAT THE INFORMATION STATED ABOVE IS TRUE AND CORRECT.

Signature: James C. Allen
(Transferor or Agent)

Telephone No.: (515) 468-0017

Addendum

Legal Description of Property

Parcel "A" located in the Northeast Quarter ($\frac{1}{4}$) of the Northeast Quarter ($\frac{1}{4}$) of Section Five (5), Township Seventy-five (75) North, Range Twenty-eight (28) West of the 5th P.M., Madison County, Iowa, containing 3.00 acres, as shown in Plat of Survey filed in Book 3, Page 22 on June 18, 1997, in the Office of the Recorder of Madison County, Iowa



Time of Transfer Inspection Report

Other components:

Alarms Working? yes disinfection working?
Control box Timers inspection ports

Other components _____

Overall condition of the private sewage disposal system

Report system status The septic system at 1796 Hwy 92 Winterset, IA

on 4-24-12 is in good cond. Explain (attach additional pages as needed): The tanks was opened and Pumped on 4-24-12 the 1000 gal tank has 2-Compartments of intake + outflow

Comments: baffles are in place the 2nd 750 gal tank is one compartment & baffles are in place - the pump tank was opened & is operating good. The dest. box is in good cond. all laterals took water on 4-24-12

water was added to system to simulate heavy use cond. all graywater goes to system on 4-24-12

Site status at conclusion of Time of Transfer inspection:

- Done • Verify that controls are set on the appropriate mode.
- Done • Power is on to all components.
- Done • Revisit all components to verify lids are secure.
- Done • Gather all tools for removal from the site.
- Verify that no sewage is on the ground surface. None on 4-24-12

Using this worksheet, write a narrative report of the inspection results and attach a site sketch.

This report indicates the condition of the private sewage disposal system at the time of the inspection. It does not guarantee that it will continue to function satisfactorily.

Signature of Certified inspector: John W. Mayer Date: 4-24-2012
Name (print): _____ Certificate #: 8979
Address: _____
Phone # 515-462-2624

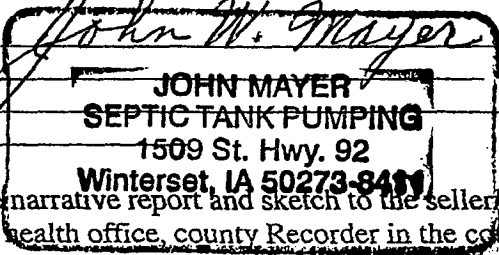

Provide a copy of this report, the narrative report and sketch to the seller/agent, buyer/agent, the county sanitarian/environmental health office, county Recorder in the county the inspection was conducted and to;

Iowa DNR Onsite Wastewater Program
502 E. 9th St.
Des Moines, IA 50319

Map on Back →

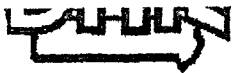

Realtor
Time of Transfer Inspection Report (DNR Form 542-0191)

Property information

Current owner Jim Eller
 Buyer _____ Realtor Madison Co Realty
 Mailing address _____

Site Address/County 1796 Hwy 92 Winterset, Va 50273
 Legal Description Madison Co.

No. of bedrooms 4 Last occupied? not for Records available yes

Permit/installation date 9-6-01 Separation distances ok/ no? OK
↳ 2016

Septic system information

1000 gal 1 of 750 gal 2nd tank
 Septic tank(s): size 1000 gal material Plastic condition good
 Tank pumped? yes date 4-24-12 licensed pumper Major S.J. 75
 Septic/trash/processing tank: size _____ material _____ condition _____
 Tank pumped? _____ date _____ licensed pumper _____

Aerobic treatment unit (ATU) mfr _____ size _____
 Tank pumped? _____ date _____ licensed pumper _____
 Maintenance contract? _____ expiration date _____ service provider _____
 Condition _____

Pump tanks/vaults: type Plastic size 500 gal condition good

Distribution system: distribution box Plastic outlets used 5 condition Good
 Header pipe(s) 4 # of lines 5 Pressure dosed? _____

Secondary treatment:

length of absorption fields 5 at 100 ft long determined by walking & probing
 condition of fields good determined by walking & probing
 type of trench material gravelless

Size of sand filter _____ determined by _____
 Vent pipes above grade? _____ discharge pipe located? _____
 Effluent sample taken? _____ Results _____

Media filters: type _____
 Maintenance contract? _____ expiration date _____ service provider _____
 Condition _____

NPDES General Permit No. 4: required? _____ permitted? _____ NOI provided _____

Pictures on Back →

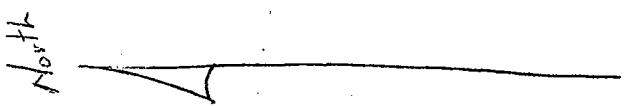
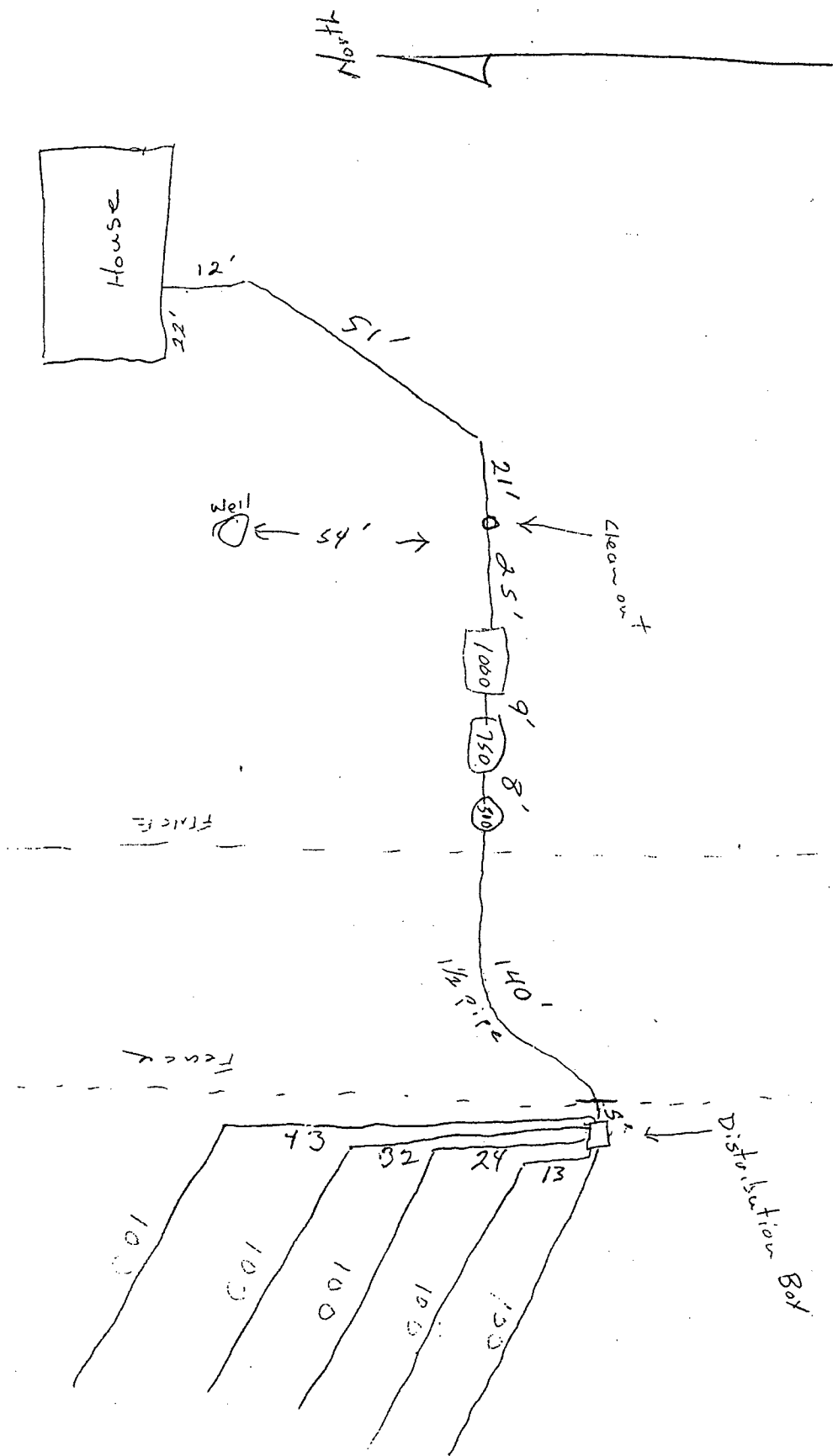

Permit # ~~1796~~ 2016
 1796 S Hwy 92
 Inspection 9/6/01