



Document 2011 GW3545

Book 2011 Page 3545 Type 43 001 Pages 6

Date 12/29/2011 Time 2:48 PM

Rec Amt \$.00

INDX ✓
ANNO
SCAN
CHEK

LISA SMITH, COUNTY RECORDER
MADISON COUNTY IOWA

**REAL ESTATE TRANSFER - GROUNDWATER HAZARD STATEMENT
TO BE COMPLETED BY TRANSFEROR**

TRANSFEROR:

Name Estate of Lee Ravis Hill

Address c/o Darren Hill, Executor, 371 Gillham Road, Royal, Arkansas 71968

Number and Street or RR

City, Town or P.O.

State

Zip

TRANSFeree:

Name Rick Young and Cindy Kern

Address 2985 Settlers Trail, P.O. Box 244, St. Charles, Iowa 50240

Number and Street or RR

City, Town or P.O.

State

Zip

Address of Property Transferred:

2888 282nd Trail, St. Charles, Iowa 50240

Number and Street or RR

City, Town, or P.O.

State

Zip

Legal Description of Property: (Attach if necessary) All of the real estate lying South of the county road right of way as it now exists in the South Half (1/2) of the Northeast Quarter (1/4) of Section Six (6), Township Seventy-four (74) North, Range Twenty-six (26) West of the 5th P.M., Madison County, Iowa.

1. Wells (check one)

- There are no known wells situated on this property.
- There is a well or wells situated on this property. The type(s), location(s) and legal status are stated below or set forth on an attached separate sheet, as necessary.

2. Solid Waste Disposal (check one)

- There is no known solid waste disposal site on this property.
- There is a solid waste disposal site on this property and information related thereto is provided in Attachment #1, attached to this document.

3. Hazardous Wastes (check one)

- There is no known hazardous waste on this property.
- There is hazardous waste on this property and information related thereto is provided in Attachment #1, attached to this document.

4. Underground Storage Tanks (check one)

- There are no known underground storage tanks on this property. (Note exclusions such as small farm and residential motor fuel tanks, most heating oil tanks, cisterns and septic tanks, in instructions.)
- There is an underground storage tank on this property. The type(s), size(s) and any known substance(s) contained are listed below or on an attached separate sheet, as necessary.

5. Private Burial Site (check one)

- There are no known private burial sites on this property.
- There is a private burial site on this property. The location(s) of the site(s) and known identifying information of the decedent(s) is stated below or on an attached separate sheet, as necessary.

6. Private Sewage Disposal System (check one)

- All buildings on this property are served by a public or semi-public sewage disposal system.
- This transaction does not involve the transfer of any building.
- There is a building served by private sewage disposal system on this property or a building without any lawful sewage disposal system. A certified inspector's report is attached which documents the condition of the private sewage disposal system and whether any modifications are required to conform to standards adopted by the Department of Natural Resources. A certified inspection report must be accompanied by this form when recording.
- There is a building served by private sewage disposal system on this property. Weather or other temporary physical conditions prevent the certified inspection of the private sewage disposal system from being conducted. The buyer has executed a binding acknowledgment with the county board of health to conduct a certified inspection of the private sewage disposal system at the earliest practicable time and to be responsible for any required modifications to the private sewage disposal system as identified by the certified inspection. A copy of the binding acknowledgment is attached to this form.
- There is a building served by private sewage disposal system on this property. The buyer has executed a binding acknowledgment with the county board of health to install a new private sewage disposal system on this property within an agreed upon time period. A copy of the binding acknowledgment is provided with this form.
- There is a building served by private sewage disposal system on this property. The building to which the sewage disposal system is connected will be demolished without being occupied. The buyer has executed a binding acknowledgment with the county board of health to demolish the building within an agreed upon time period. A copy of the binding acknowledgment is provided with this form. [Exemption #9]
- This property is exempt from the private sewage disposal inspection requirements pursuant to the following exemption [Note: for exemption #9 use prior check box]: Exemption No. 3
- The private sewage disposal system has been installed within the past two years pursuant to permit number _____.

Information required by statements checked above should be provided here or on separate sheets attached hereto:

One (1) active well is located by the trailer.

One (1) active well is located approximately 500 feet west of the trailer.

I HEREBY DECLARE THAT I HAVE REVIEWED THE INSTRUCTIONS FOR THIS FORM AND THAT THE INFORMATION STATED ABOVE IS TRUE AND CORRECT.

Signature: _____

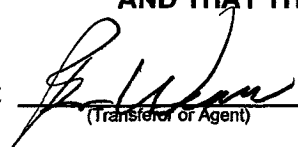

(Transferor or Agent)

Telephone No.: (515) 468-1051



Time of Transfer Inspection Report

542-0191

Property Information

Current Owner: Regena Strable 641-728-4225
 Buyer: Rick Young 515-250-7881 Realtor: Bob Weeks 515-468-1051
 Mailing Address: Rick Young 2985 Settlers Trail Tunica La 50257
 Site Address/County: 2888 282nd Street Dora La Madison County
 Legal Description mobile home

No. of bedrooms: 2 Last occupied: Vacant Records available: Pictures only
 Permit/ installation date: 1658 - 1994 or 96 Separation distances (ok/no?): yes ok

Septic System Information

Septic tank(s): Size: 1,500 Material: concrete Condition: excellent
 Tank pumped? Y N Date: 11-14-11 Licensed pumper: yes ST 307

Septic/Trash/Processing tank: Size: _____ Material: _____ Condition: _____
 Tank pumped? Y N Date: _____ Licensed pumper: _____

Aerobic treatment unit (ATU) mfg: _____ Size: _____
 Tank pumped? Y N Date: _____ Licensed pumper: _____

Maintenance contract? Y N Expiration date: _____ Service provider: _____
 Condition: _____

Pump tanks/vaults: Type: _____ Size: _____ Condition: _____
 Distribution system: Distribution box yes Outlets used no Condition: excellent
 Header pipe(s): 1 No. of lines: 3 Pressure dosed? no

Secondary Treatment:

Length of absorption fields: 3 at 100 feet Determined by: _____
 Condition of fields: good Determined by: _____

Type of trench material: gravelless SABS socks and fabric
 Size of sand filter: _____ Determined by: _____

Vent pipes above grade? Y N Discharge pipe located? Y N
 Effluent sample taken _____ Results: _____

Media Filters: Type: _____
 Maintenance contract? Y N Expiration date: _____ Service provider: _____

Condition: _____
 NPDES General Permit No. 4: Required? Y N Permitted? Y N NOI provided: _____



Time of Transfer Inspection Report

Other components:

Alarms: Y N Working: Y N Disinfection: Y N Working: Y N

Control Box: no Timers: no Inspection Ports: no

Other components: none

Overall condition of the private sewage disposal system:

Report system status: Good working order

Explain (attach additional pages as needed): _____

Comments: Should have septic tank pumped and cleaned every 3 to 5 years

Site status at conclusion of Time of Transfer inspection:

- Verify that controls are set on the appropriate mode.
- Power is on to all components.
- Revisit all components to verify lids are secure.
- Gather all tools for removal from the site.
- Verify that no sewage is on the ground surface.

Using this worksheet, write a narrative report of the inspection results and attach a site sketch.

This report indicates the condition of the private sewage disposal system at the time of the inspection. It does not guarantee that it will continue to function satisfactorily.

Signature of Certified Inspector: Vance Smith Date: 11-28-11

Name (print): Vance Smith Certificate #: 8992

Address: 502 West Main Street St Charles Ia 50240

Phone #: 641-396-2440

Provide a copy of this report, the narrative report and sketch to the seller/agent, buyer/agent, the county sanitarian/environmental health office in the county the inspection was conducted, the county recorder and to:

Iowa DNR Onsite Wastewater Program
502 E 9th St
Des Moines IA 50319

**ANYTIME SEPTIC SERVICES II
VANCE SMITH
ST. CHARLES, IA 50240
641-396-2440**

REAL ESTATE SEPTIC INSPECTION

On November 14th, 2011 Anytime Septic Services II and Mark Mease Construction did Time of Transfer Real Estate Inspection on septic tank, distribution box and Absorption field at 2888 282nd street. In Peru, Iowa. The septic tank is a two compartment 1500 gallon Lister concrete septic tank that is 20 inches below surface, with 12 inch lids on each end and 24'inch clean out lid. The inlet and outlet baffles are plastic and are attached to the walls, does not have effluent filter. The Distribution box is a plastic Tuf Tite box that is supported with concrete with schedule 40 tee- baffle. Pumped and cleaned distribution box and filled with clean water. There is 3 lines of schedule 35 pipes leaving distribution box equally through the speed levelers, into the absorption field that consist of 3 at 100 ft. each, grave less 10 inch SKB5 socks and fabric laterals 10 feet on center apart. There is no sign of effluences ponding or surfacing at ground level.

**ANYTIME SEPTIC SERVICES II IS NOT RESPONSIBLE
FOR ANY FAILED SEPTIC SYSTEMS**

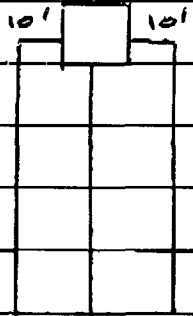
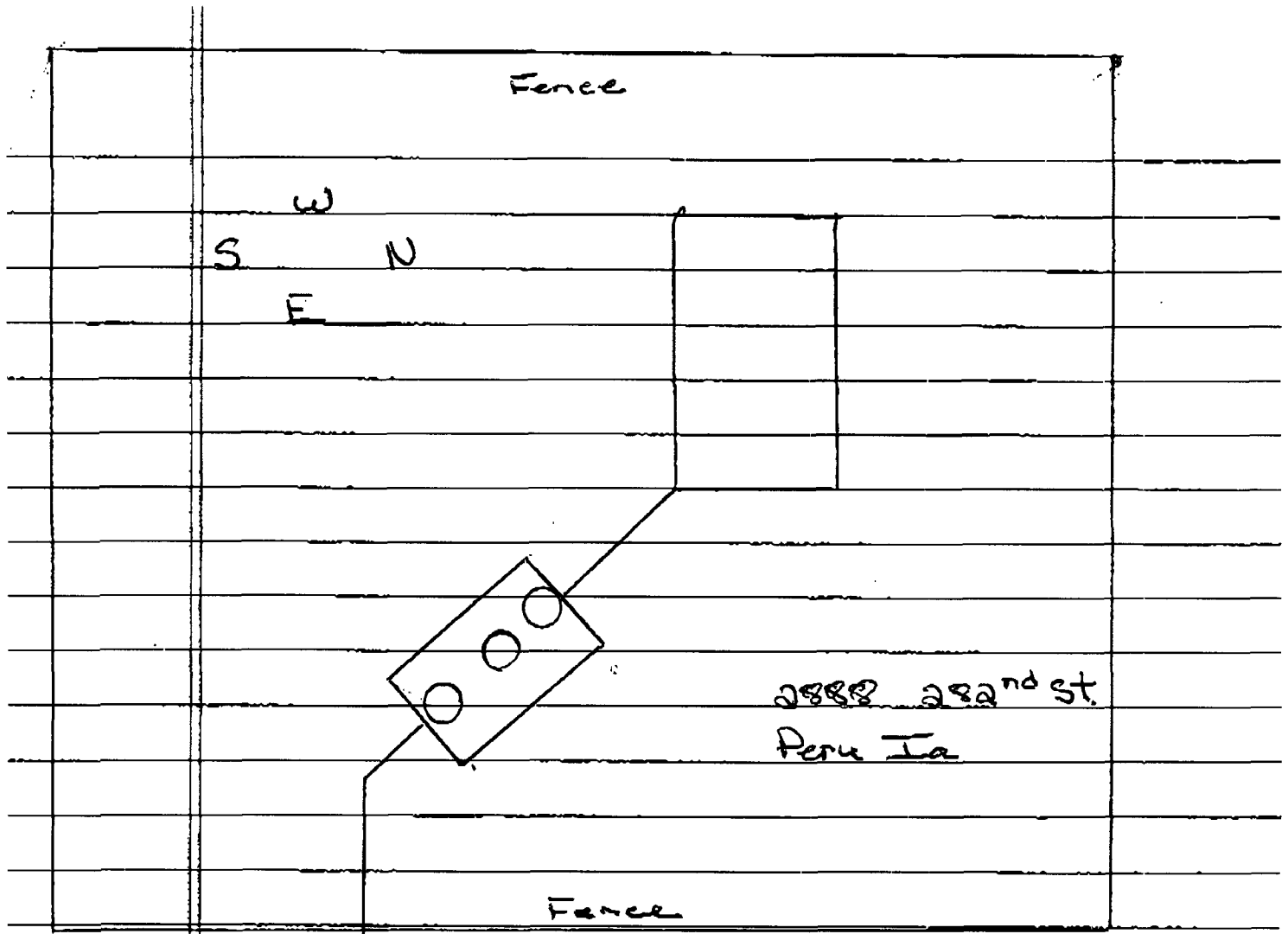

from South East corner of mobile home to center clean out lid is 32 feet from outlet side of septic Tank 15 feet South East to 45 degree turn then straight East 54 feet to center of Distribution box