



Document 2011 1332

Book 2011 Page 1332 Type 06 043 Pages 1

Date 5/24/2011 Time 10:58 AM

Rec Amt \$9.00

1NDX ✓

ANNO ✓

SCAN

CHEK

LISA SMITH, COUNTY RECORDER
MADISON COUNTY IOWA

Prepared By: J. Brian Morrissey, Morrissey Surveying, 1405 Hwy. G28, Otley, Ia. 50214, Tel. (641) 627-5554

UNITED STATES PUBLIC LAND SURVEY CORNER CERTIFICATE OF

Land Survey Monuments situated in Section 24, Township 76N, Range 26W, of the Fifth Principal Meridian, Madison County, Iowa.
Previously recorded in Bk. 1, P. 570 in County Recorders Office.

(book, page, document number, etc.)

(Show reason for preparing this certificate, the evidence and detailed procedures used in establishing the corner positions and monumentation found or placed.)

Monument Description and Remarks: Found 5/8" rebar, accepted position. Previous ties altered or obliterated.

PLAN VIEW

(Show a minimum of three reference ties to durable physical objects, relevant monuments and physical conditions that will enable recovery of the corner.)

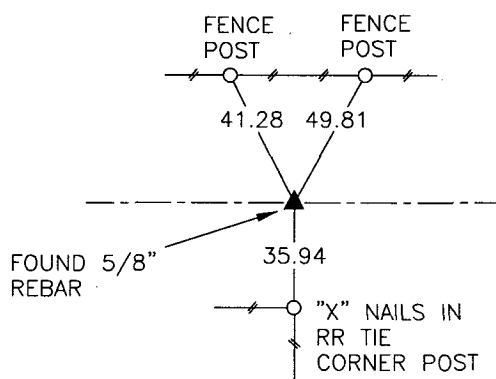
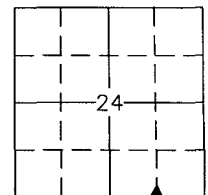

SW COR., SE 1/4, SE 1/4, SEC. 24

NOTE: ALL TIES TO "X" NAILS UNLESS NOTED.

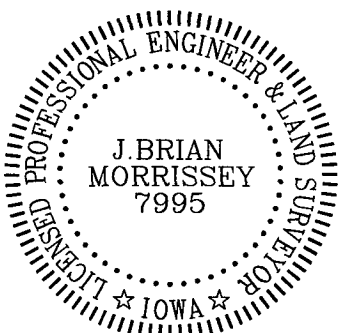

I hereby certify that this land surveying document was prepared and the related survey work was performed by me or under my direct personal supervision and that I am a duly Licensed Land Surveyor under the laws of the State of Iowa.

Signature: J. Brian Morrissey Date: 5/23/11

License number 7995.

My license renewal date is December 31, 2011

628-10-3