



Document 2011 1331

Book 2011 Page 1331 Type 06 043 Pages 1

Date 5/24/2011 Time 10:58 AM

Rec Amt \$9.00

INDX ✓

ANNO ✓

SCAN

CHEK

LISA SMITH, COUNTY RECORDER  
MADISON COUNTY IOWA

Prepared By: J. Brian Morrissey, Morrissey Surveying, 1405 Hwy. G28, Otley, Ia. 50214, Tel. (641) 627-5554

## UNITED STATES PUBLIC LAND SURVEY CORNER CERTIFICATE OF

Land Survey Monuments situated in Section 24, Township 76N, Range 26W, of the Fifth Principal Meridian, Madison County, Iowa.  
Previously recorded in Bk. 1, P. 570 in County Recorders Office.

(book, page, document number, etc.)

(Show reason for preparing this certificate, the evidence and detailed procedures used in establishing the corner positions and monumentation found or placed.)

Monument Description and Remarks: Found 1/2" yellow plastic capped rebar, # not legible, at centerline of road. Previous ties altered or obliterated.

### PLAN VIEW

(Show a minimum of three reference ties to durable physical objects, relevant monuments and physical conditions that will enable recovery of the corner.)

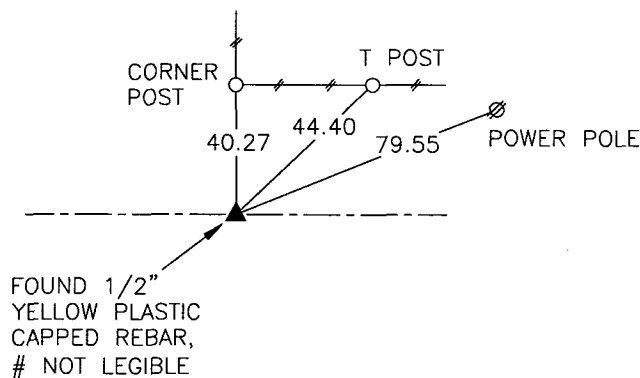
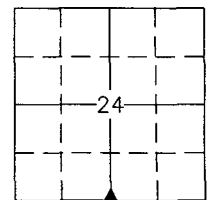

SW COR., SW 1/4, SE 1/4, SEC. 24

NOTE: ALL TIES TO BRASS DISK UNLESS NOTED.

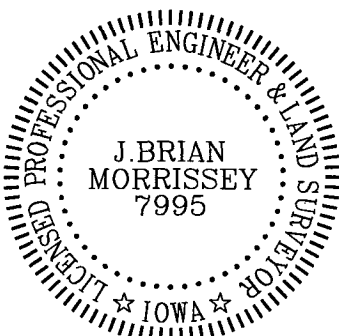

I hereby certify that this land surveying document was prepared and the related survey work was performed by me or under my direct personal supervision and that I am a duly Licensed Land Surveyor under the laws of the State of Iowa.

Signature: J. Brian Morrissey Date: 5/23/11  
J. Brian Morrissey

License number 7995.

My license renewal date is December 31, 2011

628-10-2