

(PG 10 of 2)

FILED NO. 5217-1
BOOK 2 PAGE 398-399

06-22-1999

WILLIAMSON ADDITION PLAT 1

W

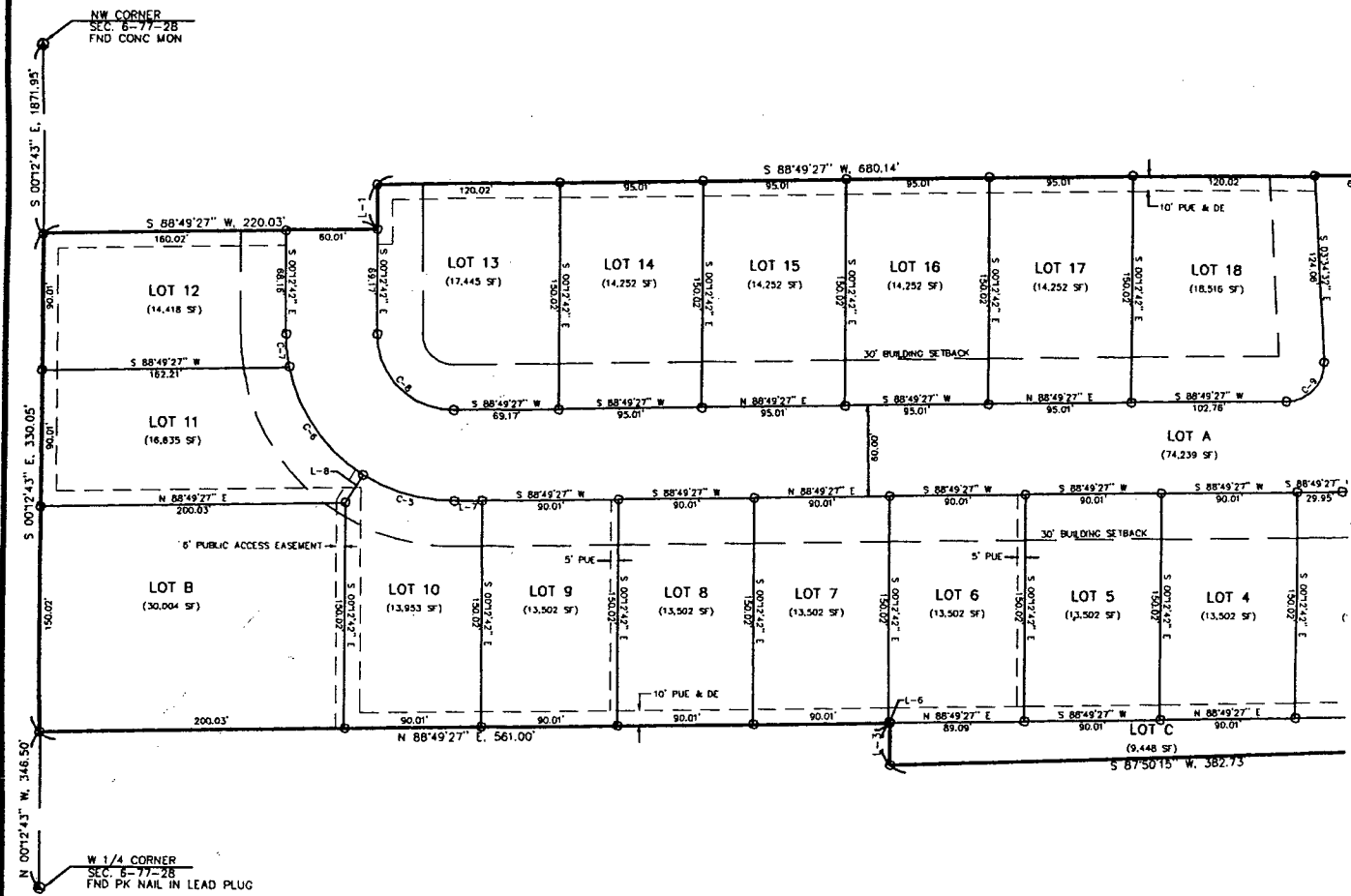

CURVE DATA

CURVE NO.	DELTA	RADIUS	ARC LENGTH	TANGENT	CHORD BEARING, DISTANCE
C-1	37°54'38"	70.00'	46.32'	24.04'	S 70°41'24" W, 45.48'
C-2	90°00'00"	25.00'	39.27'	25.00'	N 45°21'17" W, 35.36'
C-3	17°32'02"	150.00'	45.90'	23.13'	N 60°30'06" E, 45.72'
C-4	19°33'20"	150.00'	51.20'	25.85'	S 79°02'47" W, 50.95'
C-5	33°09'21"	110.00'	63.65'	32.75'	S 74°35'52" E, 62.77'
C-6	46°22'07"	110.00'	89.02'	47.11'	N 34°50'08" W, 86.61'
C-7	11°26'23"	110.00'	21.96'	11.02'	S 05°55'54" E, 21.93'
C-8	90°57'51"	50.00'	79.38'	50.85'	S 45°41'37" E, 71.30'
C-9	92°23'59"	25.00'	40.32'	26.07'	S 42°37'28" W, 36.09'
C-10	93°13'15"	25.00'	40.68'	26.45'	S 43°02'06" W, 36.33'
C-11	37°54'38"	130.00'	86.02'	44.65'	S 70°41'24" W, 84.46'
C-12	124°41'23"	25.00'	54.41'	47.71'	N 65°55'14" W, 44.29'

LINE DATA

LINE NO.	BEARING	DISTANCE
L-1	N 00°12'42" W	30.00'
L-2	N 03°34'32" W	35.73'
L-3	N 00°12'42" W	28.00'
L-4	S 89°38'43" W	4.19'
L-5	N 00°46'17" W	21.41'
L-6	N 88°49'27" E	0.92'
L-7	N 88°49'27" E	18.15'
L-8	N 31°58'48" E	21.39'
L-9	S 89°38'43" W	1.66'



- ④ FOUND SECTION CORNER AS NOTED
- ⑤ SET SECTION CORNER 5/8" IRON PIN W/CAP #12106 UNLESS NOTED OTHERWISE
- FOUND MONUMENT AS NOTED
- SET MONUMENT 5/8" IRON PIN W/CAP #12106 UNLESS NOTED OTHERWISE
- (R) RECORDED DISTANCE OR BEARING
- FOUND IRON-OR-NAIL MONUMENT, AS NOTED
- PUE PUBLIC UTILITY EASEMENT
- SWE SIDEWALK EASEMENT
- TCE TEMPORARY CONSTRUCTION EASEMENT
- SSE STORM SEWER EASEMENT
- DE DRAINAGE EASEMENT
- NR NON RADIAL
- C COMPUTED DISTANCE
- EXISTING FENCE LINE AS NOTED
- ADDRESS

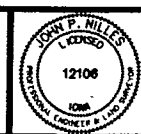

I HEREBY CERTIFY I PREPARED AND THE ME OR UNDER MY D AND THAT I AM A C LAWS OF THE STATE

JOHN P. HILL
LICENSE NO. 12106
MY LICENSE RENEWA

WILLIAMSON ADDITION PLAT 1

For Dedication, Resolution
& Certificates See Deed
Record 63 page 198

FILED NO. 5217-1
BOOK 2 PAGE 398-399
99 JUN 22 AM 8:20
MICHELLE UTSLER
RECORDER
MADISON COUNTY, IOWA

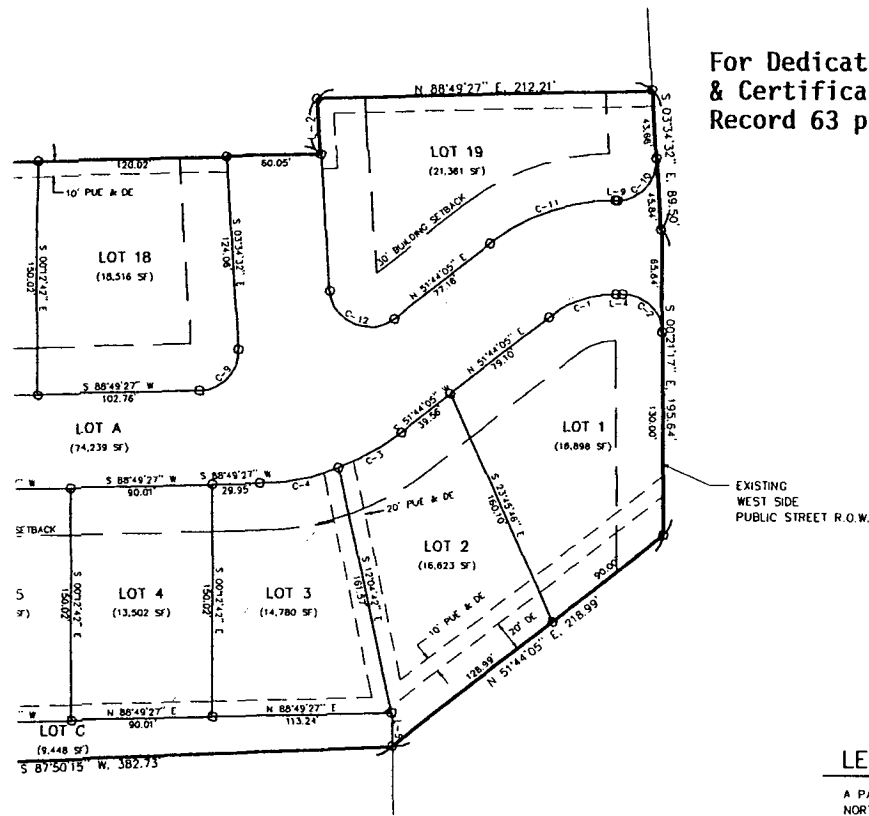

LEGAL DESCRIPTION

A PARCEL OF LAND LOCATED IN THE SOUTHWEST FRACTIONAL QUARTER OF THE NORTHWEST QUARTER OF SECTION 6, TOWNSHIP 77 NORTH, RANGE 28 WEST OF THE 5TH P.M., MADISON COUNTY, IOWA; BEING DESCRIBED AS FOLLOWS:

COMMENCING AT THE WEST QUARTER CORNER OF SAID SECTION 6, THENCE N 00°2'43" W ALONG THE WEST LINE OF SAID NW 1/4, 346.50 FEET TO THE POINT OF BEGINNING; THENCE CONTINUING N 00°2'43" W ALONG THE WEST LINE OF SAID NW 1/4, 330.05 FEET TO A POINT; THENCE N 88°49'27" E, 220.03 FEET TO A POINT; THENCE N 00°2'42" W, 30.00 FEET TO A POINT; THENCE N 88°49'27" E, 680.14 FEET TO A POINT; THENCE N 03°34'32" W, 35.73 FEET TO A POINT; THENCE N 88°49'27" E, 212.21 FEET TO THE EXISTING WEST PUBLIC STREET RIGHT OF WAY; THENCE S 03°34'32" E ALONG SAID WEST RIGHT OF WAY, 89.50 FEET; THENCE S 00°21'17" E ALONG SAID WEST RIGHT OF WAY, 195.64 FEET TO A POINT; THENCE S 51°44'05" W, 218.99 FEET TO A POINT; THENCE S 87°50'15" W, 382.73 FEET TO A POINT; THENCE N 00°12'42" W, 28.00 FEET TO A POINT; THENCE S 88°49'27" W, 561.00 FEET TO THE POINT OF BEGINNING, CONTAINING 9.282 ACRES, MORE OR LESS.

SAID PARCEL BEING SUBJECT TO ANY AND ALL EASEMENTS OF RECORD.

ABOVE BEARINGS ASSUMED FOR THIS SURVEY ONLY.

NOTES

1. LOT A IS TO BE DEEDED TO THE CITY OF EARLHAM FOR ROADWAY PURPOSES.
2. LOT B COULD BE DEEDED TO THE CITY OF EARLHAM FOR SWIMMING POOL PURPOSES.
3. LOT C COULD BE DEEDED TO EARLHAM COMMUNITY SCHOOL.



I HEREBY CERTIFY THAT THIS LAND SURVEYING DOCUMENT WAS PREPARED AND THE RELATED SURVEY WORK WAS PERFORMED BY ME OR UNDER MY DIRECT PERSONAL SUPERVISION AND THAT I AM A DULY LICENSED LAND SURVEYOR UNDER THE LAWS OF THE STATE OF IOWA.
John P. Nilles DATED: 6/15/99 PAGES OR SHEETS COVERED BY THIS SEAL: 1 of 1
LICENSE NO. 12108
MY LICENSE RENEWAL DATE IS: DEC. 31, 2000

WILLIAMSON ADDITION PLAT 1

FINAL PLAT

NILLES SURVEYING, INC.

P. O. BOX 798 ANKENY, IOWA 50021-0798
(515) 965 - 0123 Fax: (515) 965 - 3222

PROJECT NO.	98261
DATE	6/15/99
DRAWN BY	JPN
CHECKED BY	JPN
SCALE	AS NOTED
SHEET NO.	1 of 1