



IOWA DEPARTMENT OF TRANSPORTATION
HIGHWAY DIVISION
ENTRANCE PERMIT
(Application for Permit to Construct Entrance from Private Property
to Primary Road or Primary Road Extension)

DVD.
REC.
PAGE

Permit Number 4-1383
County Madison
Project FA 366
Highway Number U.S. 169

Applicant Jerry L. Schwertfeger and Beth A. Schwertfeger and Mobile Plaza, Inc.
(Owner or Owners of Record)

Address 216 South 11th Avenue, Winterset, Iowa 50273 (Date) 19

A permit is hereby requested to construct a Joint Type "C" entrance 35 feet in width, from right of way line to primary road traveled way, including necessary drainage structure thereunder at Station 48+50, east side.

PLAT OF ENTRANCE AS PROPOSED TO BE CONSTRUCTED IS ATTACHED TO AND IS A PART OF THIS APPLICATION. (Form 640002)

Proposed entrance is located on Primary Road No. US 169, Sec. 30, T. 76N, R. 27W, Madison County, .77 Miles north from the north Jct. of Iowa 92 more specifically described as follows:

approximately 4078' north of the S.W. corner of Section 30-76-27.

The applicant agrees that if granted a permit to construct the above described entrance, the following stipulations shall govern.

- Written approval of the Department shall be obtained before any change is made in the entrance or its location.
- That the entrance, including drainage structure, grading and surfacing, shall be constructed by the applicant at the applicant's expense, in accordance with the plat attached hereto, and in conformity with the standard specifications of the Highway Division, and shall thereafter be kept in repair and maintained by the applicant at his own expense. Nothing in this stipulation, however, shall preclude the Department from entering upon said entrance on highway right of way and performing necessary maintenance for the protection of the highway.
- That the construction of the entrance shall be completed by the 30th day of May, 1988. (The permit is null and void if drive is not completed by the above date unless extension is granted in writing by the Department.)
- That the construction, future repair or maintenance of said entrance shall be carried on in such a way as not to interfere with, or interrupt traffic on said highway, and the applicant shall take all reasonable precautions to protect and safeguard the lives and property of any person or persons, and shall save the State and Department of Transportation harmless of any damage or losses that may be sustained by any person or persons, on account of such construction, repair, or maintenance operations.
- That no filling will be permitted in the right of way of primary road No. U.S. 169 other than that necessary to construct the proposed entrance an additional. That the culvert pipe under the entrance shall be zinc coated corrugated metal or 1500D concrete pipe. It shall be 18 inches in diameter and 24 feet in length as shown on attached sketch, and of quality complying with Sec. 4141 and Sec. 4145 of the Highway Division Standard and Specifications, Series of 1977, or subsequent revisions. The pipe shall be installed at the elevation specified by the engineer. The finished surface elevation of the driveway over the pipe or place where the pipe would normally be shall be 4 inches lower than shoulder elevation at Station 48+60 to prevent water draining onto the pavement or travel way. Side slope of the requested entrance shall be constructed with a minimum of 8:1 slope.
- That the applicant agrees to give the Highway Division forty-eight hours notice of his intention to start construction on the highway right of way. Said notice shall be in writing to the person whose name is shown on the reverse side.
- That all provisions herein relating to future repair or maintenance shall be binding on all successors or assigns of the applicant.
- Stipulations and requirements contained herein are not intended to waive greater requirement of local zoning ordinances.
- Applicant's attention is directed to the fact that private property may not be used so as to obstruct or encumber the public highway right of way, or interfere with the safety, comfort, and rights of public highway users.
- §319.14 Code of Iowa requires any work performed under this permit to be in conformity with the specifications of the D.O.T. If the applicant does not conform to these specifications the D.O.T. may make the necessary changes and charge the cost against the person responsible, including court action if necessary.

1503 C

STATE OF IOWA, ss. Inst. No. 1503 Filed for Record this 2 day of March, 1988 at 8:10 AM
DIXON COUNTY, Book 38 Page 255 Recording Fee 15.00 Mary E. Welty, Recorder, By M. Welty Deputy

Compared

COURT

Mobile Plaza, Inc.

11. The existing access @ Sta 48140
will be made a part of the By: Curtis C. Allen
proposed access @ Sta 48150. Curtis C. Allen

By: Beth A. Schwertfeger
Beth A. Schwertfeger

Signed Jerry L. and Beth A. Schwertfeger By: Jerry L. Schwertfeger
(Applicant) OWNER OF RECORD (Type name below line) Jerry L. Schwertfeger
Title Owners Address 218 S. 11th Avenue, Winterset, IA 5027

ACKNOWLEDGEMENT

STATE OF IOWA
On this 23rd day of January, A.D., 1988, before me Jean Pry
a Notary Public in and for said State of Iowa, personally appeared Jerry Schwertfeger and
to me known to be the person(s), named in and who execute the foregoing instrument, and acknowledged, that
executed the same as voluntary act and deed.

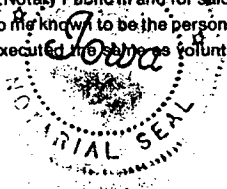

Jean Pry
Notary Public in and for said state

Recommended for approval by Thomas J. Donahy
Resident Maintenance Engineer, on 2/24 1988
Access hereby requested is approved and granted by the Department of Transportation, Highway Division
by Donald R. Shan
Authorized Dist. Agent
on 2/25 1988

Recommended for approval for _____
city of town _____
on _____ 19____ by _____
Authorized City Official _____ Title _____
Joseph J. Trivittyan
Zoning Officer

Notice of date construction is to start shall be sent by applicant to:
Jack Farver, Box 149, Winterset, Iowa 50273
Name Address

NOTATION OF RECORD

Filed for Record on the 2 day of March, 1988, at 8:10 o'clock A M., and Recorded in
Book 38 of Misc., on Page 255

Fee \$15.00

Recorder Mary E. Welty
By _____
Deputy

To be recorded by State for applications on all Primary Highways except the arterial Connector System. On the Arterial Connector System, if applicant may record the approved application, if desired.



IOWA DEPARTMENT OF TRANSPORTATION
Highway Division
ACCESS PLAT

No. 4-1385
County MADISON
Proj. No. EA 366

SPECIAL PUBLIC ROAD CONNECTION

Access Rights Acquired
Attach to Form 640001

CHECK
 XXXX

PRIVATE PROPERTY ENTRANCE
Access Rights Not Acquired
Attach to Form 640004

Location Description: Primary Road No. US 169, Sec. 30, T. 26N, R. 27W, MADISON County,
Being .77 Miles NORTH From THE NORTH SET. OF TOWN 98. More Specifically described as:

Robert M. Casper

Gene Kline

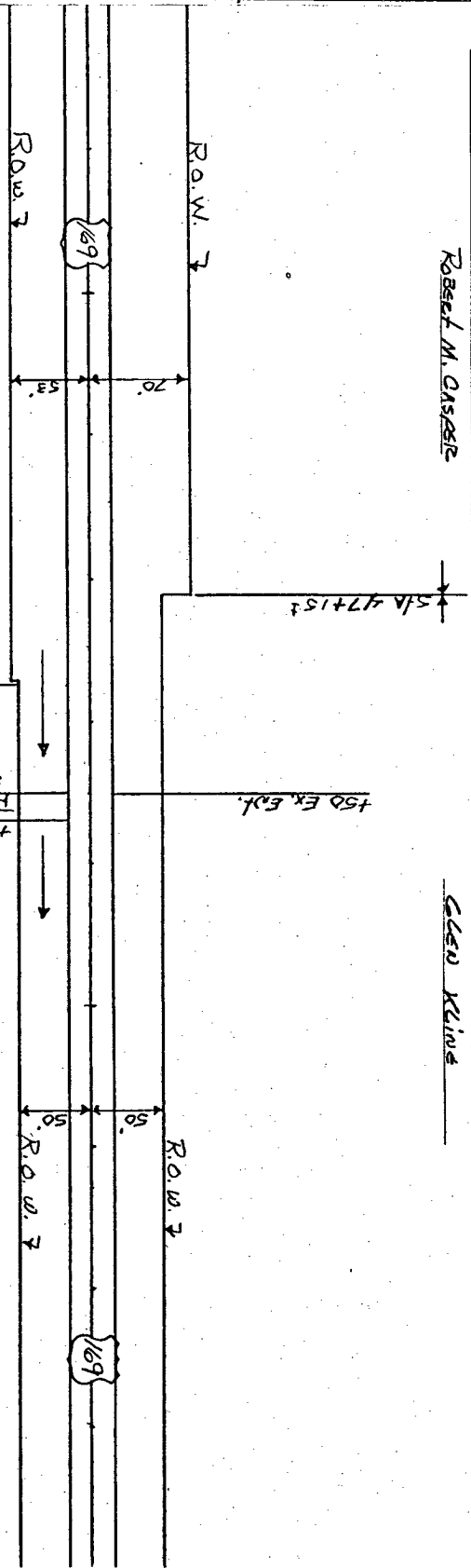

Mobile Plaza Inc.

MOBILE PLAZA INC.

CERTIFICATION

I hereby certify that this sketch was prepared by me or under my direct personal supervision and that I am a duly registered professional engineer under the laws of the State of Iowa.

Date 1/22/88
N. D. V.

APPLICANT JERRY L. SCHWETZGER AND BETH A. SCHWETZGER
AND MOBILE PLAZA INC.
ADDRESS 216 SOUTH 11TH AVENUE WINDYBUSH, IOWA 50273.