

COMPUTER
RECORDED
COMPARED

FILED NO. **4543**
BOOK 1 PAGE 624

REC \$ 5.00
AUD \$
R.M.F. \$ 1.00

98 MAY 15 PM 3:43
MICHELLE UTSLER
RECORDER
MADISON COUNTY, IOWA

VANCE & HOCHSTETLER, P.C., CONSULTING ENGINEERS, WINTERSSET, IOWA (515) 462-3995
CHARLES T. VANCE, 110 West Green St., Winterset, Iowa, 50273
JAMES M HOCHSTETLER, 110 West Green St., Winterset, Iowa 50273

UNITED STATES PUBLIC LAND SURVEY CORNER CERTIFICATE

Land Survey Monuments situated in Section 27 OF 27 Township 76 NORTH, Range 26 WEST, of the Fifth Principal Meridian, MADISON County, Iowa.
Previously recorded in _____ in County Recorder's Office.
(book, page, document number, etc.)

(Show reason for preparing this certificate, the evidence and detailed procedures used in establishing the the corner positions and monumentation found or placed.)

Monument Description and Remarks:

SE cor - Fd I.D.O.T. disc on iron pin

SE cor. NE. 1/4 SE. 1/4 - Set C.I.R. #6808 at split between Found corners at E. 1/4 cor. & SE cor.

E. 1/4 cor - Fd C.I.R. #6263

PLAN - VIEW

(Show a minimum of three reference ties to durable physical objects, relevant monuments and physical conditions that will enable recovery of the corner.)

SE CORNER
SEC. 27-76-26
Fd. I.D.O.T. C.I.R.
(24' N. of Hwy 92 E)

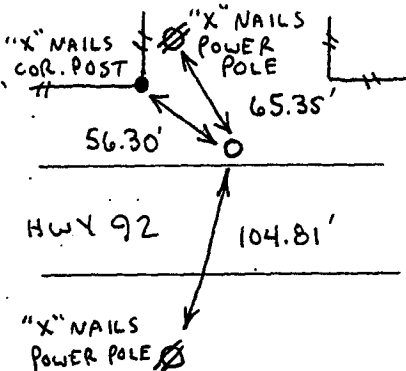

EAST 1/4 COR.
SEC. 27-76-26
Fd. C.I.R. #6263

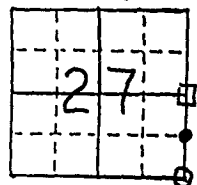
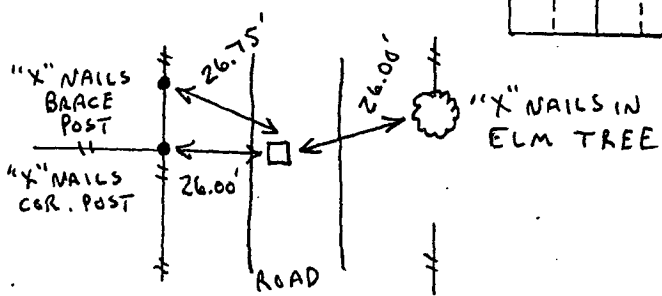

SE CORNER
NE. 1/4 SE. 1/4
SEC. 27-76-26
Set C.I.R. #6808

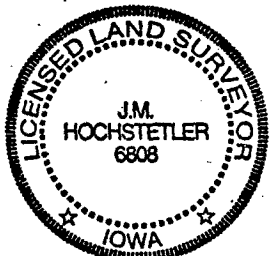
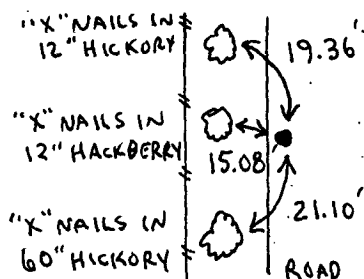

I hereby certify that this land surveying document was prepared and the related survey work was performed by me or under my direct personal supervision and that I am a duly Licensed Land Surveyor under the laws of the State of Iowa.

J.M. Hochstetler
J.M. HOCHSTETLER
License number 6808
My license renewal date is December 31, 1999
Pages or sheets covered by this work 1

List Corners to be Indexed

| Corners | Section | Twp | Range |
|----------------------------|---------|-----|-------|
| SE cor. | 27 | 76N | 26W |
| E. 1/4 cor. | 27 | 76N | 26W |
| SE cor. NE. 1/4 SE. 1/4 | 27 | 76N | 26W |