

REC'S 5⁰⁰
AUDS _____
R.M.F.S. 1⁰⁰

COMPUTER
RECORDED
COMPARED

FILED NO. 4616
BOOK 1 PAGE 627
98 MAY 21 PM 12:47

Prepared By: J. Brian Morrissey, Morrissey Surveying, 1926 Pammel Park Road, Winterset, Ia. 50273, Telephone 62-2166
MICHELLE UTSLER
RECORDED
MADISON COUNTY, IOWA

UNITED STATES PUBLIC LAND SURVEY CORNER CERTIFICATE OF

Land Survey Monuments situated in Section 12, Township 75 N, Range 26 W, of the Fifth Principal Meridian, Madison County, Iowa.
Previously recorded in _____ N. A. _____ in County Recorders Office.
(book, page, document number, etc.)

(Show reason for preparing this certificate, the evidence and detailed procedures used in establishing the corner positions and monumentation found or placed.)

Monument Description and Remarks: Set 5/8" capped rebar, #7995, at midpoint between the NW. corner of the SE. 1/4 of Section 12 and the NE. corner of the SE. 1/4 of Section 12.

PLAN VIEW

(Show a minimum of three reference ties to durable physical objects, relevant monuments and physical conditions that will enable recovery of the corner.)

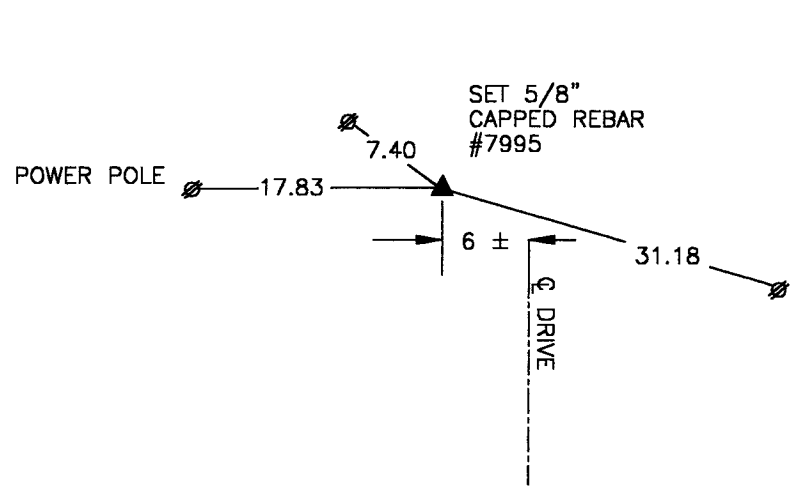
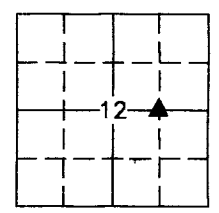

NE. COR., NW. 1/4, SE. 1/4, SEC. 12

NOTE: ALL TIES TO "X" NAILS UNLESS NOTED

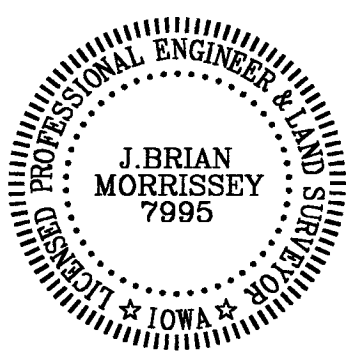

I hereby certify that the survey work was completed and this certificate was prepared by me or under my direct personal supervision and that I am a duly Licensed Land Surveyor under the laws of the State of Iowa.

Signature: J. Brian Morrissey Date: 5/20/98
J. Brian Morrissey

License number 7995.
My license renewal date is December 31, 1999.