

COMPUTER
 RECORDED
 COMPARED

2988
 FILED NO. _____
 BOOK 1 PAGE 584
 98 FEB 13 PM 2:57

REC \$ 5.00
 AUD \$ _____
 R.M.F. \$ 1.00

MICHELLE UTSLER
 RECORDER
 MADISON COUNTY, IOWA

VANCE & HOCHSTETLER, P.C. CONSULTING ENGINEERS, WINTERSSET, IOWA (515)462-3995

CHARLES T. VANCE, 110 West Green St., Winterset, Iowa 50273
 JAMES M. HOCHSTETLER, 110 West Green St., Winterset, Iowa 50273

SLSI 9-94

UNITED STATES PUBLIC LAND SURVEY CORNER CERTIFICATE

OF
 Land Survey Monuments situated in Section 23, Township 74 N, Range 28 W, of the Fifth Principal Meridian, MADISON County, Iowa.
 Previously recorded in _____ in County Recorder's Office.

(Show reason for preparing this certificate, the evidence and detailed procedures used in establishing the corner positions and monumentation found or placed.)

Monument Description and Remarks: CENTER OF SECTION 23-74-28 - Found Concrete Monument set by Iowa DOT.
SW Cor SE 1/4 NW 1/4 - Set CIR # 6808 based on information shown on Iowa State Highway Commission right-of-way plat and information shown on Corner stone ties for W 1/4 Corner.
SE Cor. SW 1/4 NE 1/4 - Set CIR # 6808 at old established fence corner.

PLAN - VIEW

(Show a minimum of three reference ties to durable physical objects, relevant monuments and physical conditions that will enable recovery of the corner.)

CENTER SEC 23-74-28

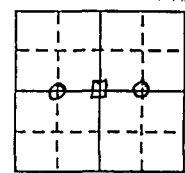
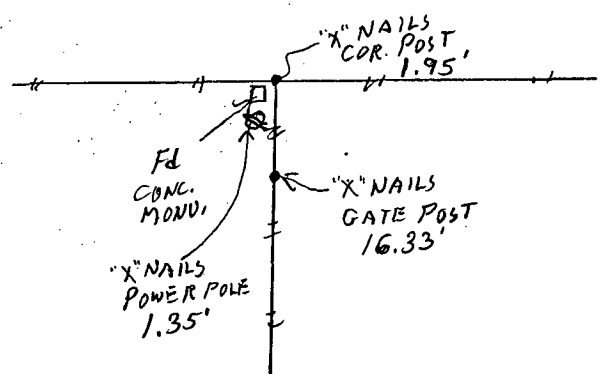

SE COR SW 1/4 NE 1/4

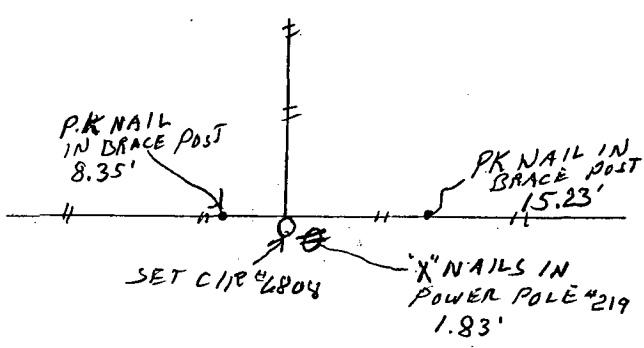

SW COR. SE 1/4 NW 1/4

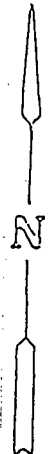
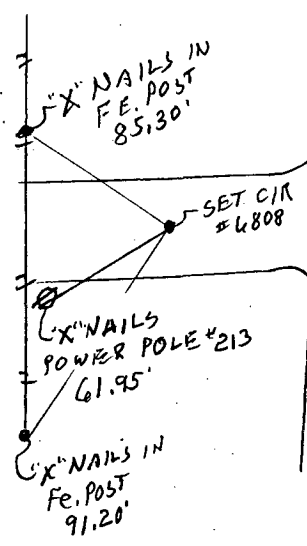

List Corners to be Indexed

Corners	Section	Twp	Range
CENTER	23	74N	28W
SE COR SW 1/4 NE 1/4	23	74N	28W
SW COR SE 1/4 NW 1/4	23	74N	28W

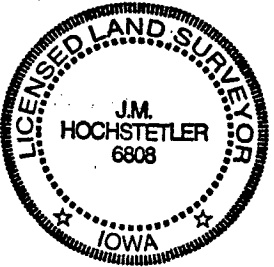

I hereby certify that this land surveying document was prepared and the related survey work was performed by me or under my direct personal supervision and that I am a duly licensed Land Surveyor under the laws of the State of Iowa.

J.M. Hochstetler
 J.M. HOCHSTETLER
 License number 6808
 Date 2/13/98
 My license renewal date is December 31, 1999.
 Pages or sheets covered by this seal: 1