

REC \$ 500

AUD

96 OCT -2 AM 8:10

R.M.F. \$ 100

COMPUTER

MICHELLE UTSLER
RECORDER
MADISON COUNTY, IOWA

RECORDED

COMPARED

VANCE & HOCHSTETLER, P.C. CONSULTING ENGINEERS, WINTERSSET, IOWA (515)462-3995

CHARLES T. VANCE, 110 West Green St., Winterset, Iowa 50273

JAMES M. HOCHSTETLER, 110 West Green St., Winterset, Iowa 50273

SLSI 9-94

UNITED STATES PUBLIC LAND SURVEY CORNER CERTIFICATE

OF

Land Survey Monuments situated in Section 20, Township 76 NORTH, Range 27 WEST, of the Fifth Principal Meridian, MADISON County, Iowa. Previously recorded in _____ in County Recorder's Office.

(book, page, document number, etc.)

(Show reason for preparing this certificate, the evidence and detailed procedures used in establishing the corner positions and monumentation found or placed.)

Monument Description and Remarks: FOUND HALF INCH IRON ROD AT THE NORTHWEST CORNER NORTHEAST QUARTER, NORTH WEST QUARTER

PLAN - VIEW

(Show a minimum of three reference ties to durable physical objects, relevant monuments and physical conditions that will enable recovery of the corner.)

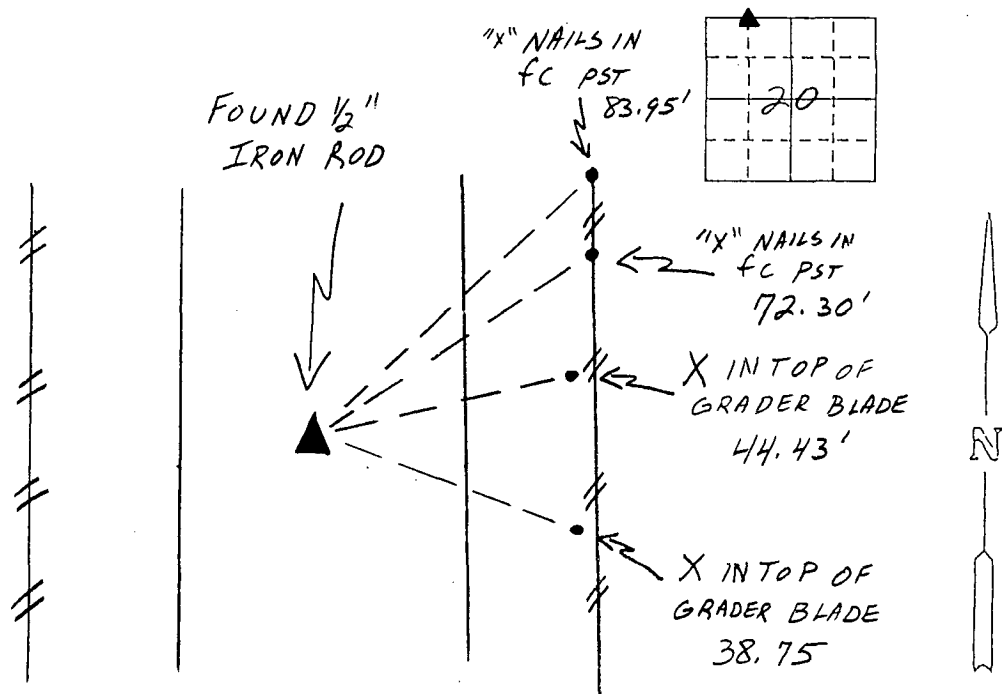

REF. TO NW COR NE 1/4 NW 1/4

I hereby certify that the survey work was completed and this land surveying document was prepared by me or under my direct personal supervision and that I am a duly registered land surveyor under the laws of the state of Iowa

Signature: J.M. Hochstetler

Name typed or printed: J.M. Hochstetler

Date: 10/1/96 Reg. No. 6808

My registration renewal date is December 31, 1997

List Corners to be Indexed

Corners	Section	Twp	Range
NW COR NE 1/4 NW 1/4	20	76	27

