

COMPUTER
RECORDED
COMPARED

FILED NO. 64

BOOK 1 PAGE 390

96 JUL -9 AM 11:12

MICHELLE UTSLER
RECORDER
MADISON COUNTY, IOWA

REC \$ 5.00

AUD \$

R.M.F. \$

VANCE & HOCHSTETLER, P.C. CONSULTING ENGINEERS, WINTERSSET, IOWA (515)462-3995

CHARLES T. VANCE, 71 JEFFERSON ST., WINTERSSET, IOWA 50273

JAMES M. HOCHSTETLER, 71 JEFFERSON ST., WINTERSSET, IOWA 50273

SLS19-94

UNITED STATES PUBLIC LAND SURVEY CORNER CERTIFICATE

OF

Land Survey Monuments situated in Section 16, Township 75 NORTH, Range 26 WEST, of the Fifth Principal Meridian, MADISON County, Iowa. Previously recorded in _____ in County Recorder's Office.

(book, page, document number, etc.)

(Show reason for preparing this certificate, the evidence and detailed procedures used in establishing the corner positions and monumentation found or placed.)

Monument Description and Remarks: _____

CENTER- Found CIR #6808

WEST 1/4 cor. - Found Railroad Spike

PLAN - VIEW

(Show a minimum of three reference ties to durable physical objects, relevant monuments and physical conditions that will enable recovery of the corner.)

CENTER
SEC. 16-75-26
Fd. CIR #6808

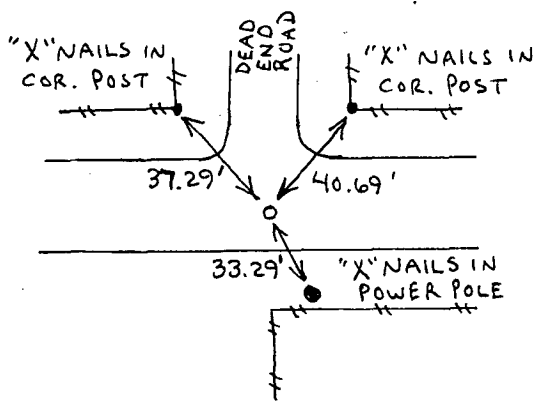
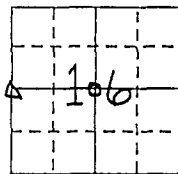

WEST 1/4 cor.
SEC. 16-75-26
Fd. RR Spike

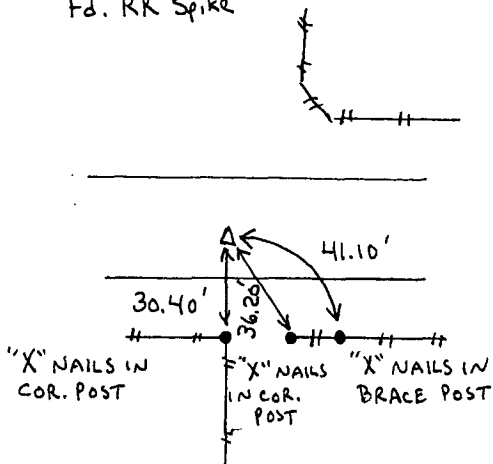

I hereby certify that the survey work was completed and this land surveying document was prepared by me or under my direct personal supervision and that I am a duly registered land surveyor under the laws of the state of Iowa

Signature: J.M. Hochstetler

Name typed or printed: J.M. Hochstetler

Date: 6/18/96 Reg. No. 6808

My registration renewal date is December 31, 1997

List Corners to be Indexed

Corners	Section	Twp	Range
o CENTER	16	75N	26W
o W 1/4 cor.	16	75N	26W

SEAL

