

REC 500

R.M.P. \$ 100

FILED NO. 26

BOOK 1 PAGE 386

96 JUL -3 PM 1:44

COMPUTER ✓
RECORDED ✓
CO. PAGED ✓

MICHELLE UTSLER
RECORDER
MADISON COUNTY, IOWA
50273, Tele. (515) 462-2166

Prepared By: J. Brian Morrissey, Morrissey Surveying, 1926 Pammel Park Road, Winterset, Ia. 50273, Tele. (515) 462-2166

UNITED STATES PUBLIC LAND SURVEY CORNER CERTIFICATE OF

Land Survey Monuments situated in Section 10, Township 75N, Range 27W, of the Fifth Principal Meridian, Madison County, Iowa. Previously recorded in N.A. in County Recorders Office.

(book,page,document number,etc.)

(Show reason for preparing this certificate, the evidence and detailed procedures used in establishing the corner positions and monumentation found or placed.)

Monument Description and Remarks: Found nail. Distance to S. 1/4 Cor. checked reasonably close to County Surveyor records. Accepted position.

PLAN VIEW

(Show a minimum of three reference ties to durable physical objects, relevant monuments and physical conditions that will enable recovery of the corner.)

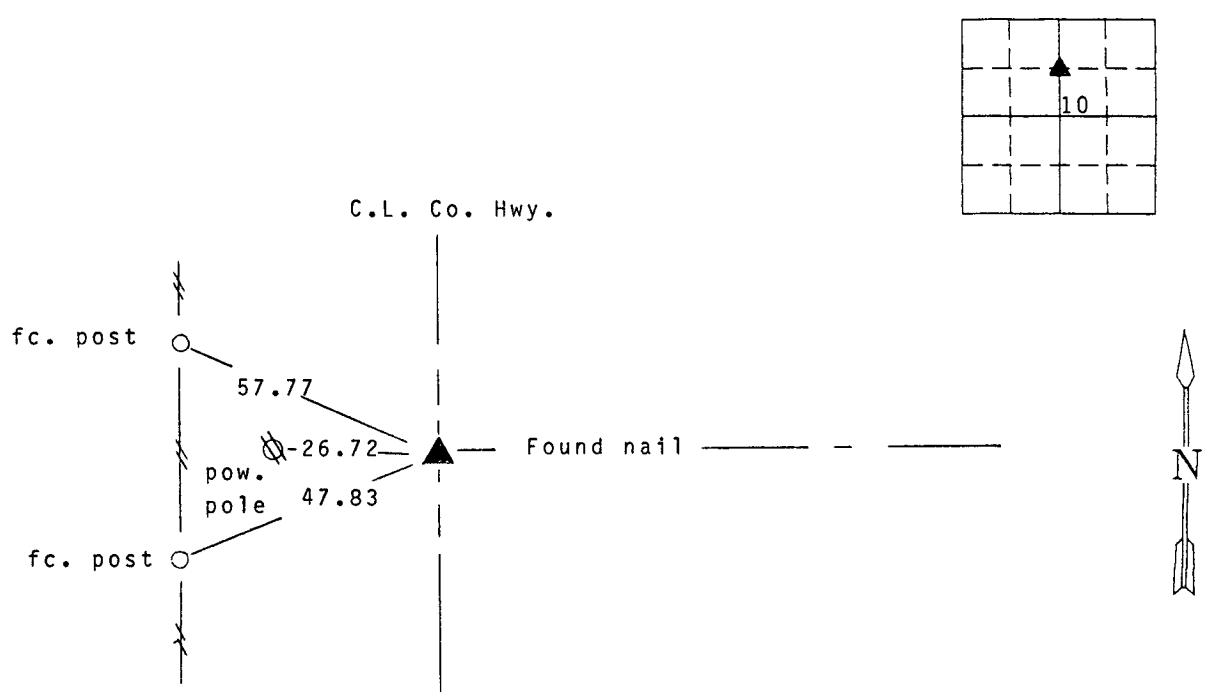

SW. Cor. NW. 1/4, NE. 1/4, Sec. 10

Note: all ties to "x" nails



I hereby certify that the survey work was completed and this certificate was prepared by me or my direct personal supervision and that I am a duly registered land surveyor under the laws of the state of Iowa. My registration renewal date is 12/31/97.

Signature: J. Brian Morrissey

Name typed or printed: J. Brian Morrissey

Date: 7/1/96 Reg.No. 7995