

REC \$ 5.00
A.D.P. _____
R.M.F. \$ 1.00

FILED NO. 2574
BOOK 1 PAGE 352
96 MAR 22 PM 1:09

COMPUTER
RECORDED
INDEXED

MICHELLE UTSLER
RECORDER
MADISON COUNTY, IOWA

Prepared By: J. Brian Morrissey, Morrissey Surveying, 1926 Pammel Park Road, Winterset, Ia. 50273, Tele. (515) 462-2166

UNITED STATES PUBLIC LAND SURVEY CORNER CERTIFICATE OF

Land Survey Monuments situated in Section 13, Township 76 N, Range 28 W, of the Fifth Principal Meridian, Madison County, Iowa. Previously recorded in Book 1, Page 101 in County Recorders Office.
(book, page, document number, etc.)

(Show reason for preparing this certificate, the evidence and detailed procedures used in establishing the corner positions and monumentation found or placed.)

Monument Description and Remarks: Found I.D.O.T. disc. Some of previous ties are gone, therefore a new certificate was prepared.

PLAN VIEW

(Show a minimum of three reference ties to durable physical objects, relevant monuments and physical conditions that will enable recovery of the corner.)

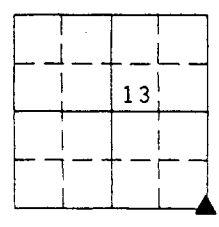

SE. Cor. Sec. 13

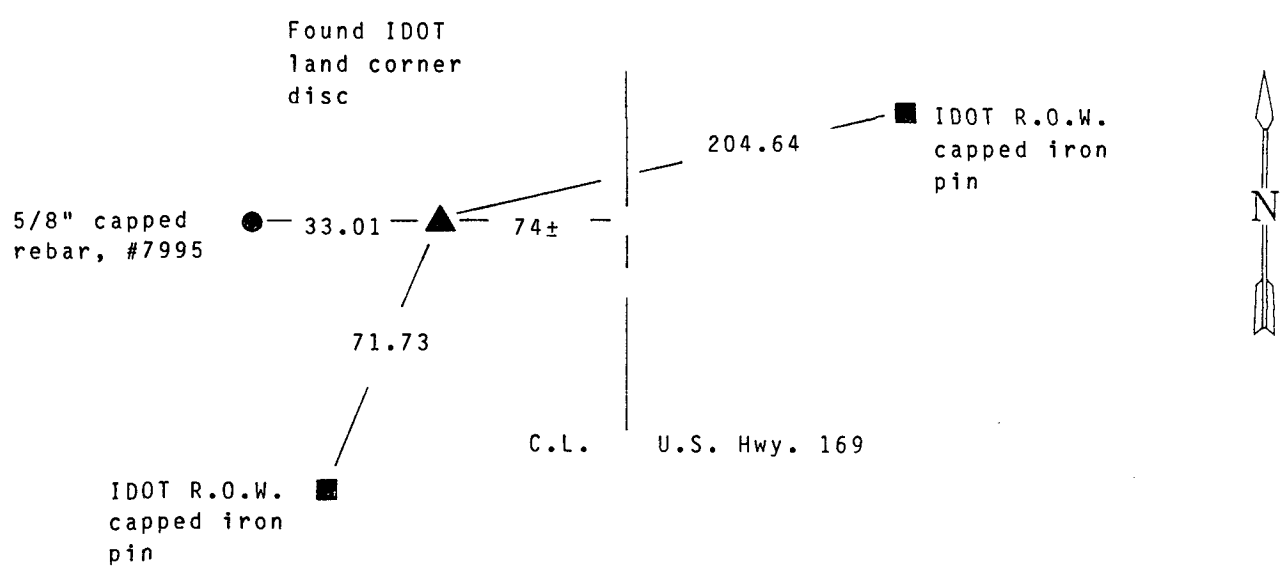

I hereby certify that the survey work was completed and this certificate was prepared by me or my direct personal supervision and that I am a duly registered land surveyor under the laws of the state of Iowa. My registration renewal date is 12/31/97.

Signature: J. Brian Morrissey
Name typed or printed: J. Brian Morrissey

Date: 3/22/96 Reg. No. 7995