

REC \$ 500

AUD ?

R.M.F. \$ 100

FILED NO. 2871

BOOK 1 PAGE 358

96 APR 22 PH 1:06

COMPUTER   
RECORDED   
COMPARED

MICHELLE UTSLER  
RECORDER  
MADISON COUNTY, IOWA

Prepared By: J. Brian Morrissey, Morrissey Surveying, 1926 Pammel Park Road, Winterset, Ia. 50273, Tele. (515) 462-2166

# UNITED STATES PUBLIC LAND SURVEY CORNER CERTIFICATE OF

Land Survey Monuments situated in Section 15, Township 74 N, Range 26 W, of the Fifth Principal Meridian, Madison County, Iowa. Previously recorded in N. A. in County Recorders Office.

(book, page, document number, etc.)

(Show reason for preparing this certificate, the evidence and detailed procedures used in establishing the corner positions and monumentation found or placed.)

Monument Description and Remarks: Set P-K nail at intersection of Section line based on land survey recorded in Town Plat Book 2, Page 248 (N-S line) and south line SW 1/4 Sec. 15.

## PLAN VIEW

(Show a minimum of three reference ties to durable physical objects, relevant monuments and physical conditions that will enable recovery of the corner.)

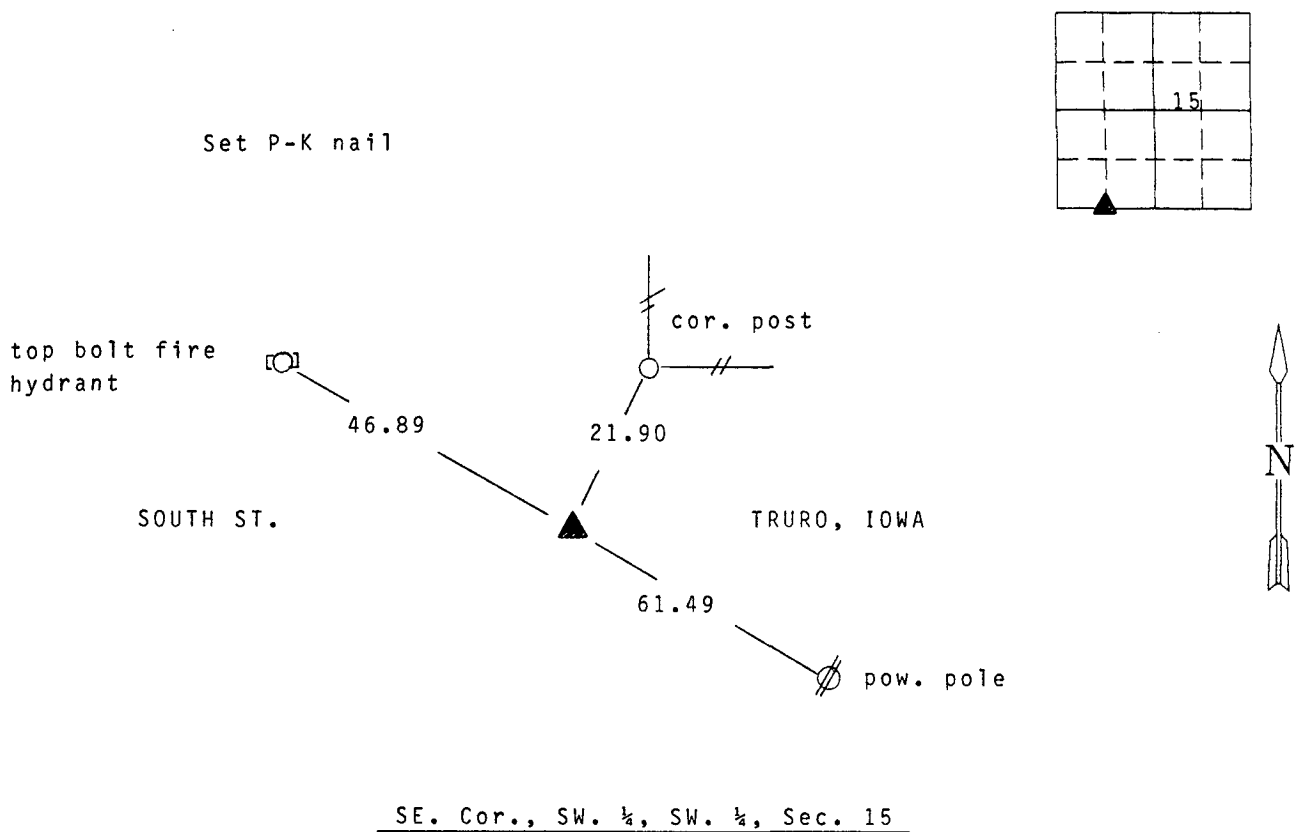

Note: all ties to "x" nails unless noted

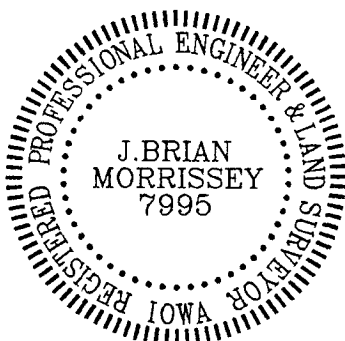

I hereby certify that the survey work was completed and this certificate was prepared by me or my direct personal supervision and that I am a duly registered land surveyor under the laws of the state of Iowa. My registration renewal date is 12/31/97.

Signature: J. Brian Morrissey

Name typed or printed: J. Brian Morrissey

Date: 4/19/96 Reg. No. 7995