

UNITED STATES PUBLIC LAND SURVEY CORNER CERTIFICATE

OF

Land Survey Monuments situated in Section 13 (18), Township 75N, Range 26W (25W), of the Fifth Principal Meridian, Madison (Warren) County, Iowa. Previously recorded in (Bk. 1, P. 184) in County Recorder's Office.

(book, page, document number, etc.)

(Show reason for preparing this certificate, the evidence and detailed procedures used in establishing the corner positions and monumentation found or placed.)

- Monument Description and Remarks: (1) Found 6"x6" cut stone exposed, accepted position.
 (2) Found 1/2" capped iron pin, #5041, at fence intersection, accepted position.
 (3) Found 1/2" iron pin and 1/2" capped iron pin, #5041. Accepted position of 1/2" iron pin, ties checked with IDOT ties to old fence corner posts, 1/2" capped iron pin, #5041, appeared to be set from newer fence posts.

PLAN - VIEW

(Show a minimum of three reference ties to durable physical objects, relevant monuments and physical conditions that will enable recovery of the corner.)

Found 6"x6" cut stone exposed

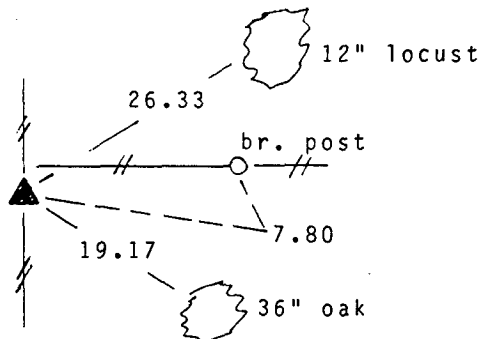

(1) SW. Cor., NW. 1/4, SE. 1/4, Sec. 13

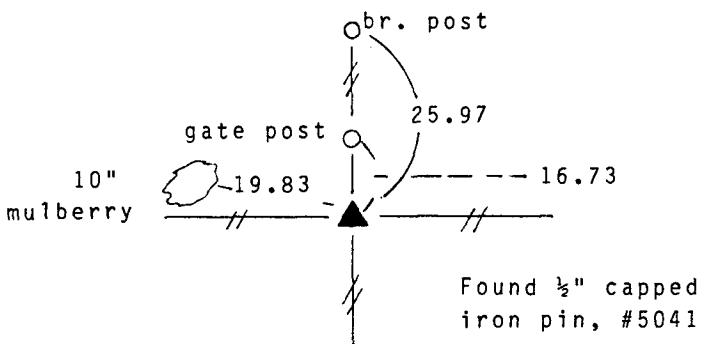

(2) NW. Cor., SE. 1/4, NE. 1/4, Sec. 13

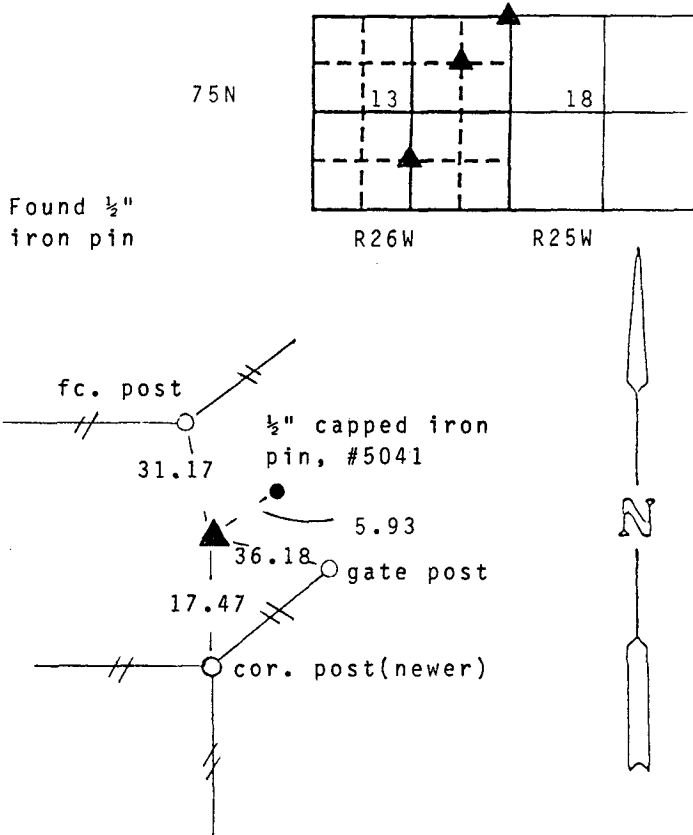

(3) NE. Cor. Sec. 13
 NW. Cor. Sec. 18

Note: all ties to "x" nails unless noted

I hereby certify that the survey work was completed and this certificate was prepared by me or under my direct personal supervision and that I am a duly registered land surveyor under the laws of the state of Iowa. My registration renewal date is 12/31/95.

Signature: J. Brian Morrissey
 Name typed or printed: J. Brian Morrissey
 Date: July 15, 1995 Reg. No. 7995

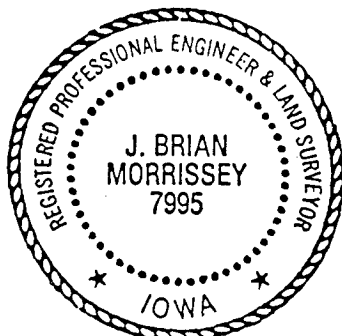

SEAL

List Corners to be Indexed			
Corners	Section	Twp	Range
SW., NW. 1/4, SE. 1/4	13	75N	26W
NW., SE. 1/4, NE. 1/4	13	75N	26W
NE.	13	75N	26W
NW.	18	75N	25W

REC \$ 5.00
 AUD \$ 1.00
 R.M.F. \$ 1.00

FILED NO. 129
 BOOK 1 PAGE 295
 95 JUL 17 PM 12:28

COMPUTER
 RECORDED
 COMPARED

MICHELLE UTGLER
 RECORDER
 MADISON COUNTY, IOWA