

UNITED STATES PUBLIC LAND SURVEY CORNER CERTIFICATE

OF

Land Survey Monuments situated in Section 9, Township 77 N, Range 28 W, of the Fifth Principal Meridian, Madison County, Iowa. Previously recorded in _____ in County Recorder's Office.

(book, page, document number, etc.)

(Show reason for preparing this certificate, the evidence and detailed procedures used in establishing the corner positions and monumentation found or placed.)

Monument Description and Remarks: _____

PLAN - VIEW

(Show a minimum of three reference ties to durable physical objects, relevant monuments and physical conditions that will enable recovery of the corner.)

CENTER, SEC. 9-77-28
FOUND $\frac{3}{4}$ " GAS PIPE
2" BELOW ROAD SURFACE

E $\frac{1}{4}$ COR 9-77-28
Fd. GOD NAIL

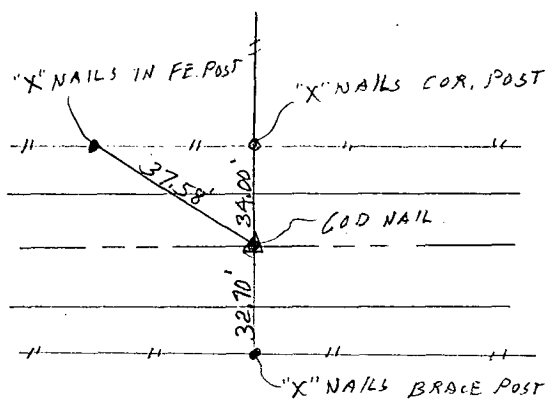
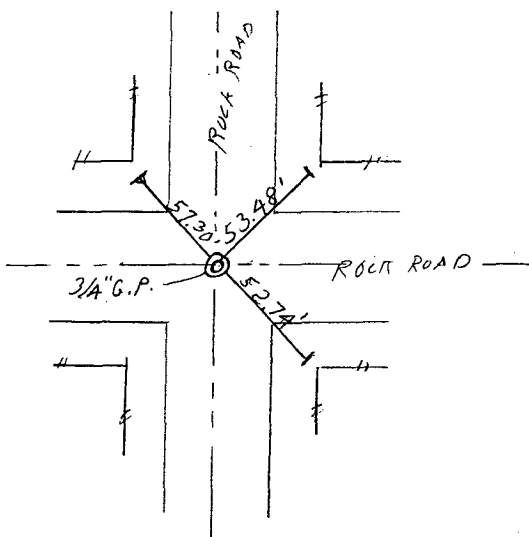
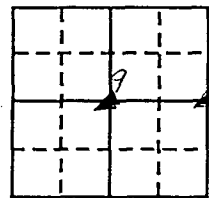

Ties All "X" IN TOP OF GRADER
BLADE

I hereby certify that the survey work was completed and this land surveying document was prepared by me or under my direct personal supervision and that I am a duly registered land surveyor under the laws of the state of Iowa

Signature: J. M. Hochstetler

Name typed or printed: J. M. Hochstetler

Date: 6/9/95 Reg. No. 6808

My registration renewal date is December 31, 1995

SEAL



Corners	List Corners to be Indexed		
	Section	Twp	Range
CENTER	9	77	28
EAST $\frac{1}{4}$ COR.	9	77	28

CHECKED
FILED
CORRECTED

FILED NO. **3132**

BOOK 1 PAGE 290

95 JUN 13 AM 10:31

MICHELLE UTSELL
RECORDER
MADISON COUNTY, IOWA

REC \$ 5.00
AUD \$ _____
R.M.F. \$ 1.00