

RECORDED
COMPARED

UNITED STATES PUBLIC LAND CORNER CERTIFICATE

OF

LAND SURVEY MONUMENTS SITUATED IN SECTION 12, TOWNSHIP 74
NORTH, RANGE 26 WEST, OF THE 5TH P.M. IN MADISON COUNTY, IOWA.

PREVIOUSLY RECORDED IN BOOK , PAGE .
(NOT PREVIOUSLY RECORDED)

MONUMENT DESCRIPTION AND REMARKS:

① NW COR. NE1/4 SE1/4 SEC. 12-74-26, SET P-K NAIL
USING 1/4 SEC. LINE AND FENCE LINES NORTH AND SOUTH.

② E1/4 COR. SEC. 12-74-26, FOUND 1/2" IRON PIN FLUSH
WITH GROUND.

③ SW COR. NE1/4 SE1/4 SEC. 12-74-26, SET 1/2" IRON PIN AT OLD COR. PO.

④ SW COR. SE1/4 SE1/4 SEC. 12-74-26, SET 1/2" IRON PIN AT OLD COR. PO.

FILED NO. **3087**

BOOK 1 PAGE 288

95 JUN -5 PM 12:15

MICHELLE UTSLER
RECORDER
MADISON COUNTY, IOWA

AUD \$
R.M.F. \$

PLAN VIEW

(SHOW A MINIMUM OF THREE REFERENCE TIES TO DURABLE PHYSICAL OBJECTS, RELEVANT MONUMENTS, AND PHYSICAL CONDITIONS THAT WILL ENABLE RECOVERY OF THE CORNER.)

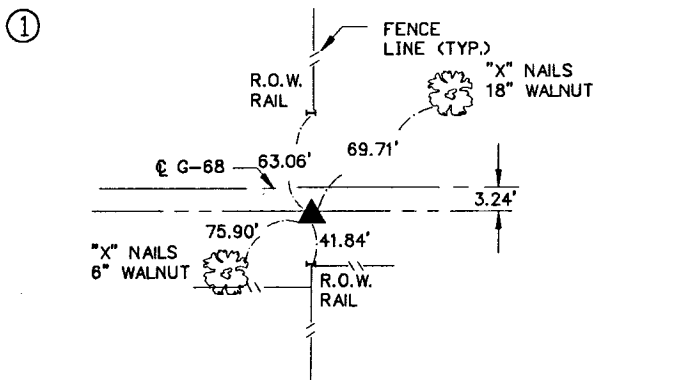

TIES TO NW COR. NE1/4 SE1/4 SEC. 12-74-26

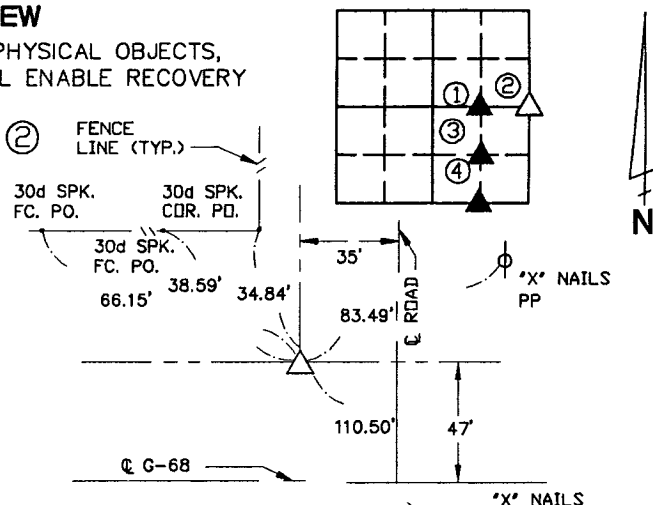

TIES TO E1/4 COR. SEC. 12-74-26

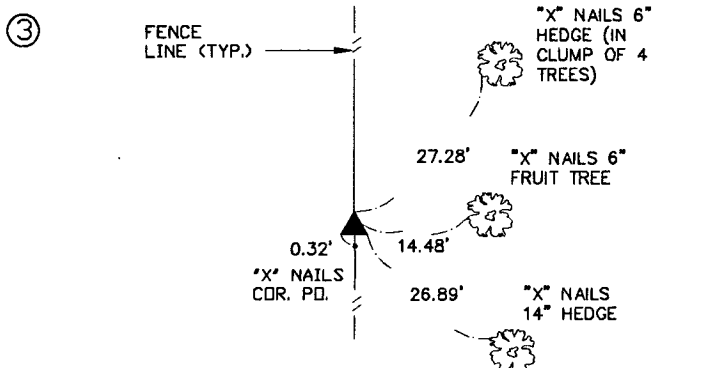

TIES TO SW COR. NE1/4 SE1/4 SEC. 12-74-26

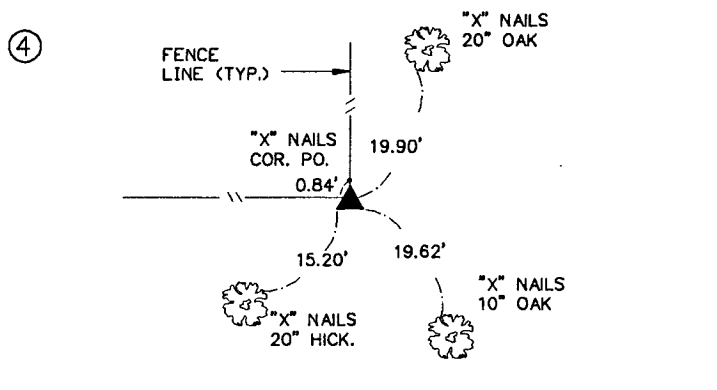

TIES TO SW COR. SE1/4 SE1/4 SEC. 12-74-26

I HEREBY CERTIFY THAT THE SURVEY WORK WAS COMPLETED AND THIS LAND SURVEYING DOCUMENT WAS PREPARED BY ME OR UNDER MY DIRECT PERSONAL SUPERVISION AND THAT I AM A DULY REGISTERED LAND SURVEYOR UNDER THE LAWS OF THE STATE OF IOWA.

SIGNATURE: James E. Norman
JAMES E. NORMAN, L.S.

DATE: 6-1-95 REG. NO. 11808

MY REGISTRATION RENEWAL DATE IS DECEMBER 31, 1995



Howard R. Green Company
CONSULTING ENGINEERS

LIST CORNERS TO BE INDEXED

CORNERS	SECTION	TWP.	RANGE
NW NESE	12	74	26
E1/4	12	74	26
SW NESE	12	74	26
SW SESE	12	74	26

SURVEY FOR: REMAX ACTION REALTY
DATE: 5-26-95