

UNITED STATES PUBLIC LAND SURVEY CORNER CERTIFICATE

OF

Land Survey Monuments situated in Section 2, Township 77N, Range 28W, of the Fifth Principal Meridian, Madison County, Iowa.
 Previously recorded in (2) recorded in Book 1, Page 253 in County Recorder's Office.
(book, page, document number, etc.)

(Show reason for preparing this certificate, the evidence and detailed procedures used in establishing the corner positions and monumentation found or placed.)

Monument Description and Remarks: (1) Found 6"x 2" triangular stone 6" deep, set 5/8" rebar, cap #7995, on N. side. (2) Found 1/2" capped iron pin, #5041, with Section Corner Certificate dated 11/10/94, ties altered or gone, retied point. (3) Found 1" square iron pin 10" deep, accepted position.

PLAN - VIEW

(Show a minimum of three reference ties to durable physical objects, relevant monuments and physical conditions that will enable recovery of the corner.)

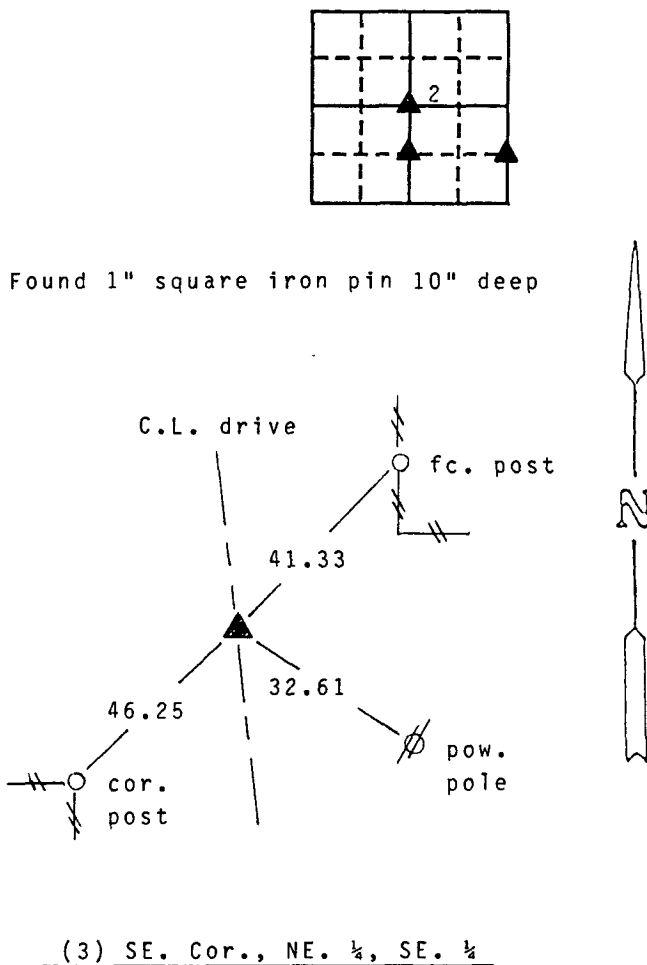
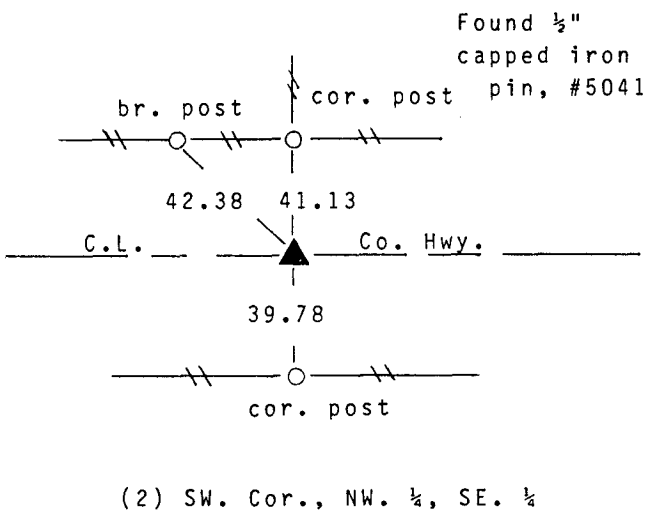
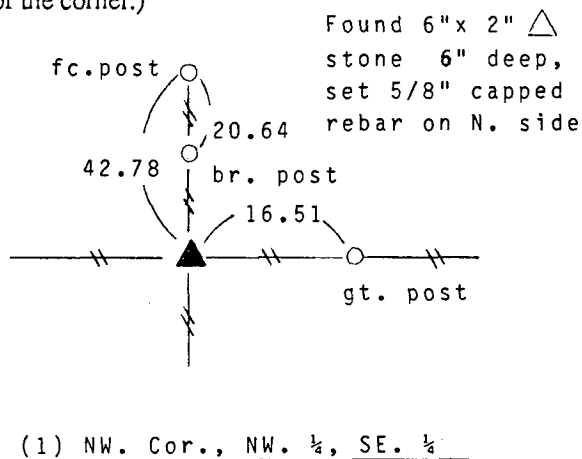

Note: all ties to "x" nails

I hereby certify that the survey work was completed and this certificate was prepared by me or under my direct personal supervision and that I am a duly registered land surveyor under the laws of the state of Iowa. My registration renewal date is 12/31/95.

Signature: J. Brian Morrissey
 Name typed or printed: J. Brian Morrissey
 Date: May 12, 1995 Reg. No. 7995

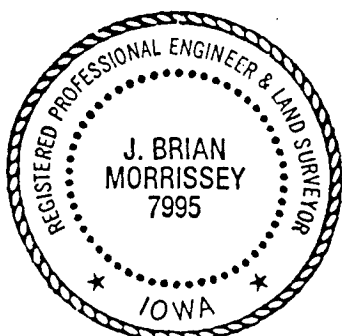

SEAL

| Corners | List Corners to be Indexed | Section | Twp | Range |
|--|----------------------------|---------|-----|-------|
| NW., NW. $\frac{1}{4}$, SE. $\frac{1}{4}$ | | 2 | 77N | 28W |
| SW., NW. $\frac{1}{4}$, SE. $\frac{1}{4}$ | | 2 | 77N | 28W |
| SE., NE. $\frac{1}{4}$, SE. $\frac{1}{4}$ | | 2 | 77N | 28W |

REC \$ 500
 AUD \$ _____
 R.M.F. \$ 100

FILED NO. 2935

BOOK 1 PAGE 287

95 MAY 12 PM 12:40

COMPUTER
 RECORDED
 COMPARED

MICHELLE UTSLER
 RECORDER
 MADISON COUNTY, IOWA