

UNITED STATES PUBLIC LAND SURVEY CORNER CERTIFICATE

94-180 S

OF

Land Survey Monuments situated in Section 3, Township 75 North, Range 26 West, of the Fifth Principal Meridian, Madison County, Iowa. Previously recorded in N/A in County Recorder's Office.

(book, page, document number, etc.)

(Show reason for preparing this certificate, the evidence and detailed procedures used in establishing the corner positions and monumentation found or placed.)

Monument Description and Remarks: see sketch below

PLAN - VIEW

(Show a minimum of three reference ties to durable physical objects, relevant monuments and physical conditions that will enable recovery of the corner.)

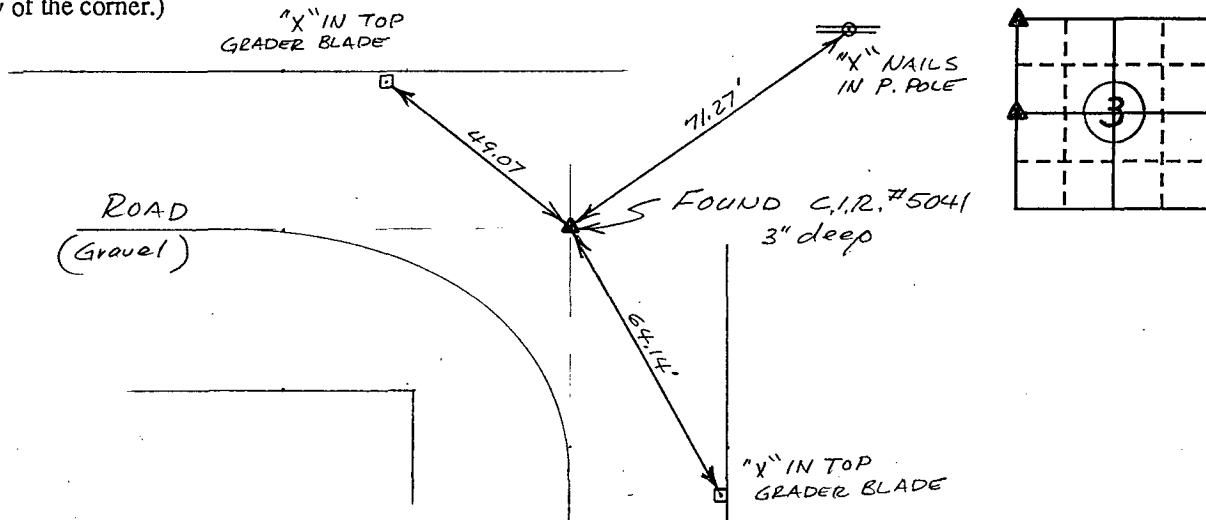

Ref. to NW. COR. OF SECTION 3, T 75N, R 26W

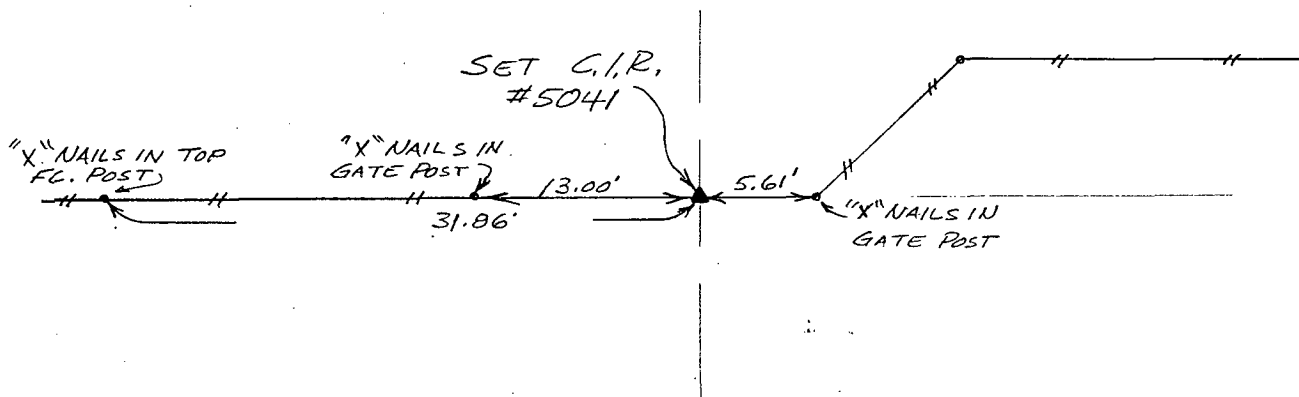

Ref. to W. 1/4 COR. OF SECTION 3, T 75N, R 26W

I hereby certify that the survey work was completed and this land surveying document was prepared by me or under my direct personal supervision and that I am a duly registered land surveyor under the laws of the state of Iowa

Signature: Charles T. Vance

Name typed or printed: Charles T. Vance, PE & LS

Date: 16 Dec. 1994 Reg. No. 5041

My registration renewal date is December 31, 19 95

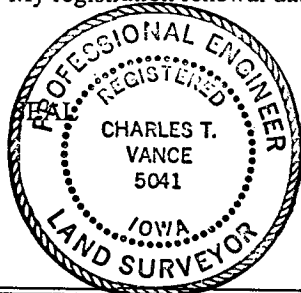

Corners	Section	Twp	Range
NW. COR.	3	77	26
W. 1/4 COR.	3	77	26

COMPUTER
 REPRODUCED
 COMPARED

REC \$ 5.00
 AUD \$
 R.M.F. \$ 1.00

FILED NO. 1758

BOOK 1 PAGE 258

95 JAN -6 AM 10: 31

MICHELLE UTSLEN
RECORDER
MADISON COUNTY, IOWA