

UNITED STATES PUBLIC LAND SURVEY CORNER CERTIFICATE

94-1595

OF

Land Survey Monuments situated in Section 10, Township 76 North, Range 29 West, of the Fifth Principal Meridian, MADISON County, Iowa. Previously recorded in N/A in County Recorder's Office.

(book, page, document number, etc.)

(Show reason for preparing this certificate, the evidence and detailed procedures used in establishing the corner positions and monumentation found or placed.)

Monument Description and Remarks: Set corner monuments according to physical evidence at the site and measurements from other corners.

PLAN - VIEW

(Show a minimum of three reference ties to durable physical objects, relevant monuments and physical conditions that will enable recovery of the corner.)

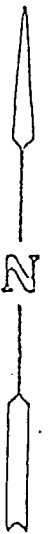
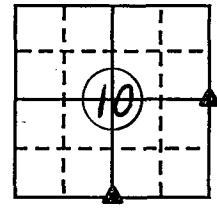
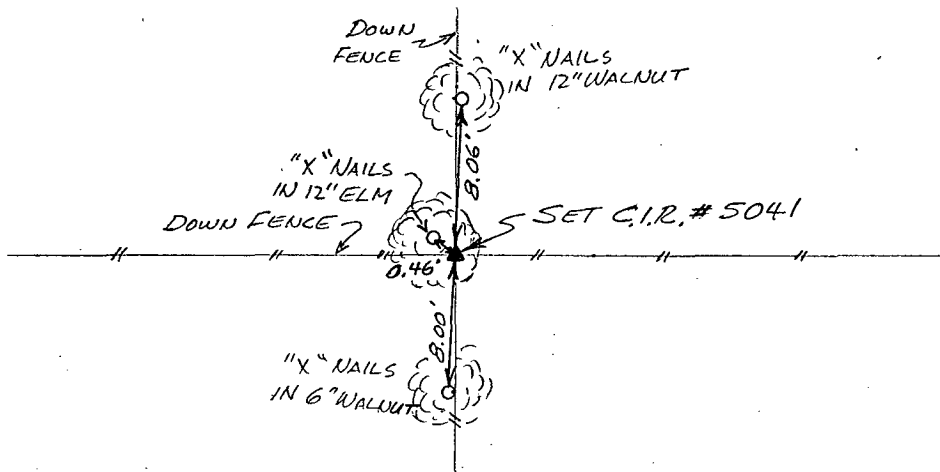

Ref. to the E. 1/4 COR. OF SECTION 10, T76N, R29W.

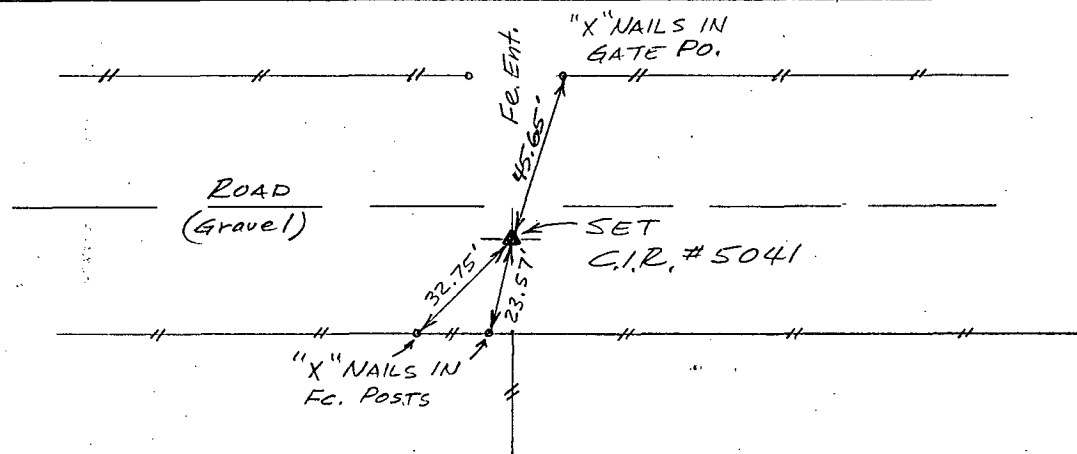

Ref. to the S. 1/4 COR. OF SECTION 10, T76N, R29W.

I hereby certify that the survey work was completed and this land surveying document was prepared by me or under my direct personal supervision and that I am a duly registered land surveyor under the laws of the state of Iowa

Signature: Charles T. Vance  
Name typed or printed: Charles T. Vance, PE & LS

Date: 1 Dec. 1994 Reg. No. 5041

My registration renewal date is December 31, 19 95

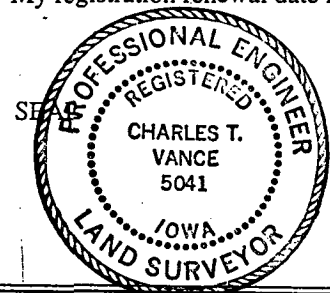

Corners	List Corners to be Indexed	Section	Twp	Range
E. 1/4 COR.	10 - 76 - 29			
S. 1/4 COR.	10 - 76 - 29			
COMPUTER	<input checked="" type="checkbox"/>			
RECORDED	<input checked="" type="checkbox"/>			
COMPARED	<input checked="" type="checkbox"/>			
REC \$	<u>5.00</u>			
AUD \$	<u>1.00</u>			
R.M.F. \$	<u>1.00</u>			
FILED NO.	<u>1512</u>			
BOOK	<u>1</u>	PAGE	<u>252</u>	
	<u>94 DEC -6 PM 2:00</u>			
	<u>MICHELLE UTSLER</u>			
	<u>RECORDER</u>			
	<u>MADISON COUNTY, IOWA</u>			