

# UNITED STATES PUBLIC LAND SURVEY CORNER CERTIFICATE

OF

Land Survey Monuments situated in Section 26, Township 76 NORTH, Range 27 WEST, of the Fifth Principal Meridian, MADISON County, Iowa. Previously recorded in \_\_\_\_\_ in County Recorder's Office.

(book, page, document number, etc.)

(Show reason for preparing this certificate, the evidence and detailed procedures used in establishing the corner positions and monumentation found or placed.)

Monument Description and Remarks: \_\_\_\_\_

## PLAN - VIEW

(Show a minimum of three reference ties to durable physical objects, relevant monuments and physical conditions that will enable recovery of the corner.)

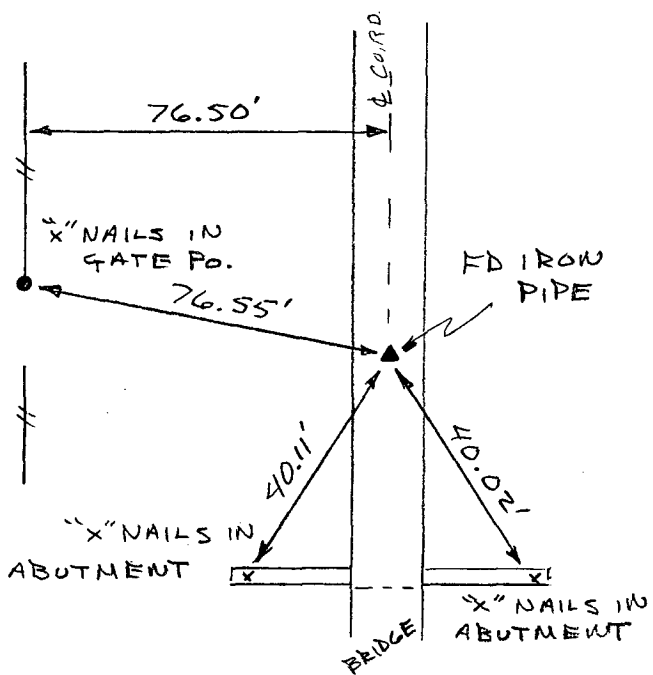

REF TO NW COR  
SEC 26 - T 76 N, R 27 W

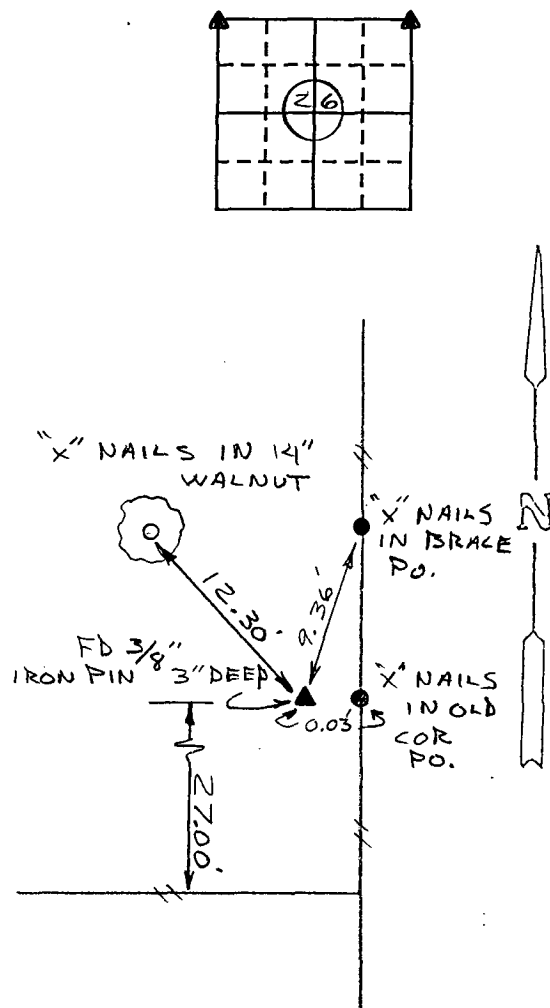

REF. TO NE COR  
SEC 26, T 76 N, R 27 W

I hereby certify that the survey work was completed and this land surveying document was prepared by me or under my direct personal supervision and that I am a duly registered land surveyor under the laws of the state of Iowa

Signature: J. M. Hochstetler  
Name typed or printed:

Date: 1/27/95 Reg. No. 6808

My registration renewal date is December 31, 1995

SEAL

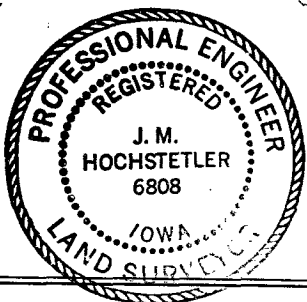

Corners	Section	Twp	Range
NE. COR	26	76	27
NW. COR	26	76	27

COMPUTER   
RECORDED   
COMPALED

REC \$ 5.00  
AUD \$ \_\_\_\_\_  
R.M.F. \$ 1.00

FILED NO. 2064  
BOOK 1 PAGE 264  
95 FEB 15 AM 10:00  
MICHELLE UTGILL,  
RECORDER  
MADISON COUNTY, IOWA