

UNITED STATES PUBLIC LAND SURVEY CORNER CERTIFICATE

OF

Land Survey Monuments situated in Section 13, Township 75 N, Range 26 W, of the Fifth Principal Meridian, Madison County, Iowa. Previously recorded in N. A. in County Recorder's Office.

(Show reason for preparing this certificate, the evidence and detailed procedures used in establishing the corner positions and monumentation found or placed.)

Monument Description and Remarks: (1) Set 5/8" rebar, cap #7995, at midpoint of line from monuments at NE. cor. Section to SW. Cor., NW. 1/4. (2) and (3) Set 5/8" rebar, cap # 7995, at positions determined by traversing Section.

PLAN - VIEW

(Show a minimum of three reference ties to durable physical objects, relevant monuments and physical conditions that will enable recovery of the corner.)

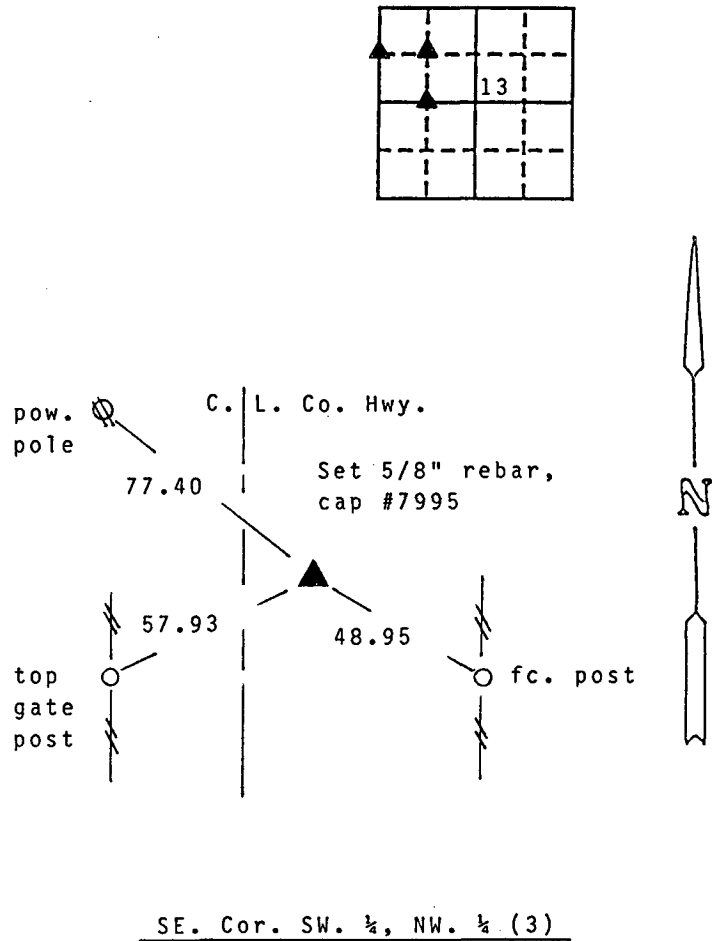
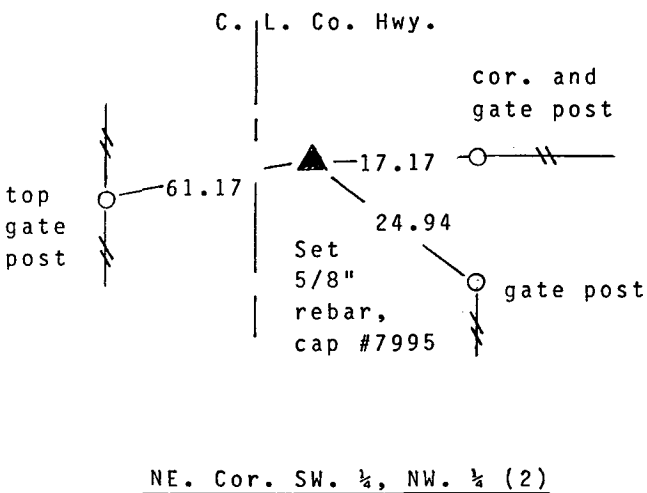
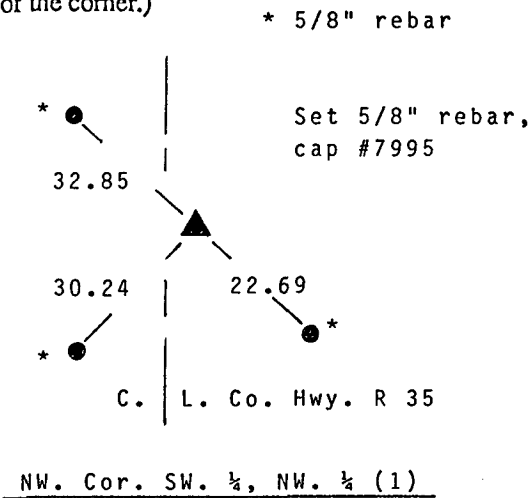

Note: all ties to "x" nails unless noted.

I hereby certify that the survey work was completed and this certificate was prepared by me or under my direct personal supervision and that I am a duly registered land surveyor under the laws of the state of Iowa. My registration renewal date is 12/31/95.

Signature: J. Brian Morrissey
Name typed or printed: J. Brian Morrissey
Date: Sept. 30, 1994 Reg. No. 7995

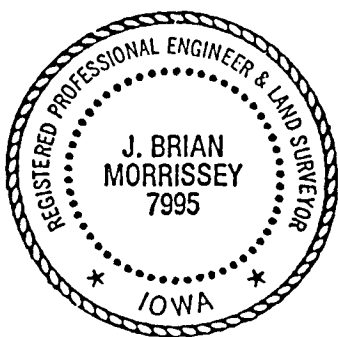

SEAL

Table with 4 columns: Corners, Section, Twp, Range. Rows list NW., SW., NW. 1/4 corners for Section 13, Township 75N, Range 26W.

COMPUTER [checked]
RECORDED [checked]
COMPARED [checked]

FILED NO. 903

BOOK 1 PAGE 242

94 SEP 30 AM 9:23

REC \$ 5.00
AUD \$
R.M.F. \$ 1.00

MICHELLE UTSLER
RECORDER
MADISON COUNTY, IOWA