

# UNITED STATES PUBLIC LAND SURVEY CORNER CERTIFICATE

OF

Land Survey Monuments situated in Section 18, Township 76 North, Range 28 West, of the Fifth Principal Meridian, Madison County, Iowa.  
Previously recorded in N/A in County Recorder's Office.

(book, page, document number, etc.)

(Show reason for preparing this certificate, the evidence and detailed procedures used in establishing the corner positions and monumentation found or placed.)

Monument Description and Remarks: \_\_\_\_\_

## PLAN - VIEW

(Show a minimum of three reference ties to durable physical objects, relevant monuments and physical conditions that will enable recovery of the corner.)

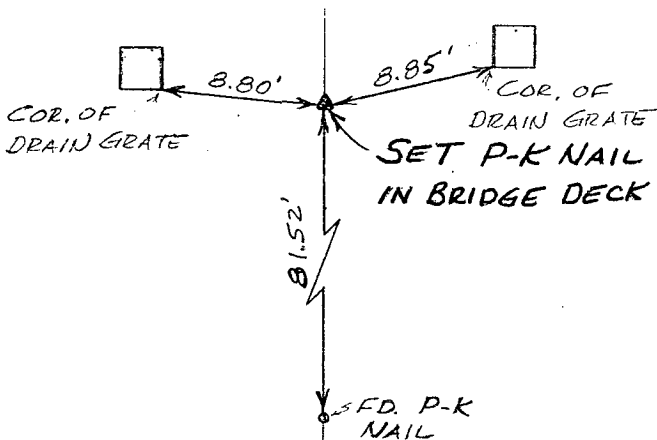
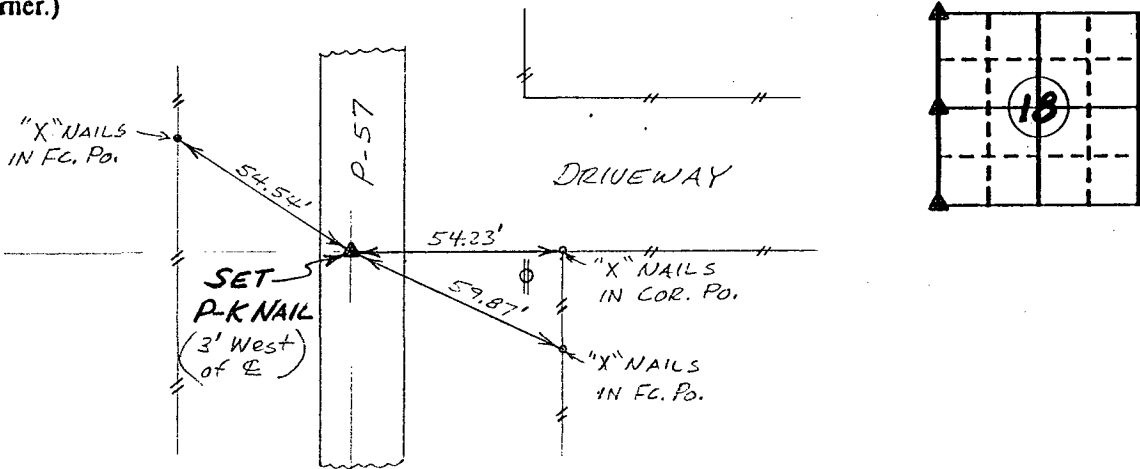

Ref. to NW. COR.,  
SECTION 18, T76N, R29W

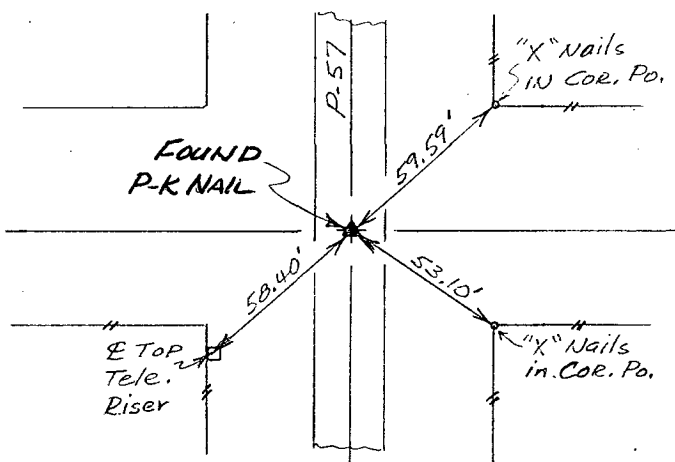

Ref. to SW. COR.,  
SECTION 18, T76N, R29W.

I hereby certify that the survey work was completed and this certificate was prepared by me or under my direct personal supervision and that I am a duly registered land surveyor under the laws of the state of Iowa.

Signature: Charles T. Vance  
Name typed or printed: Charles T. Vance, PE & LS  
Date: 11 July 1994 Reg. No. 5041  
94-435

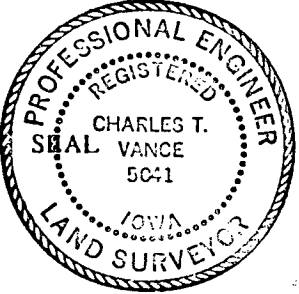

Corners	List Corners to be Indexed	Section	Twp	Range
NW. COR.	18-76-28			
W. 1/4 COR.	18-76-28			
SW. COR.	18-76-28			

REC \$ 500  
AUD \$ \_\_\_\_\_  
R.M.F. \$ 100  
COMPUTER   
RECORDED   
COMPARED

FILED NO. 320  
BOOK 1 PAGE 234  
94 AUG -2 PM 1:52  
MICHELLE UTSLER  
RECORDER  
MADISON COUNTY, IOWA