

UNITED STATES PUBLIC LAND SURVEY CORNER CERTIFICATE

OF

Land Survey Monuments situated in Section 15, Township 77N, Range 29W, of the Fifth Principal Meridian, Madison County, Iowa. Previously recorded in None in County Recorder's Office.

(book, page, document number, etc.)

(Show reason for preparing this certificate, the evidence and detailed procedures used in establishing the corner positions and monumentation found or placed.)

Monument Description and Remarks: _____

N.W. Cor. & W $\frac{1}{4}$ Cor. found plastic markers in centerline of P.C.C. pavement.

PLAN - VIEW

(Show a minimum of three reference ties to durable physical objects, relevant monuments and physical conditions that will enable recovery of the corner.)

North end C.M.P.

"X" Nails P.P.

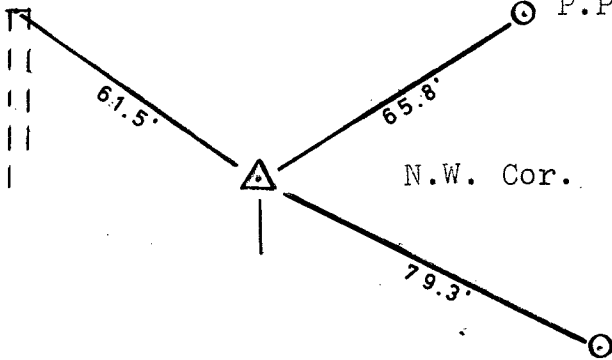
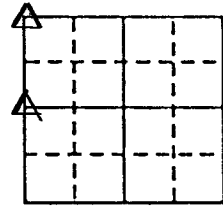

N.W. Cor.

"X" Nails Power Pole

S. end bridge

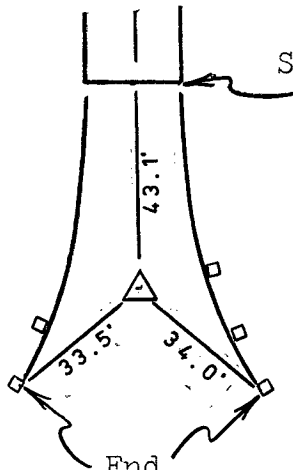

End Guardrail posts



I hereby certify that the survey work was completed and this certificate was prepared by me or under my direct personal supervision and that I am a duly registered land surveyor under the laws of the state of Iowa.

Signature: James V. Rash
Name typed or printed: James V. Rash

Date: 5-26-94 Reg. No. 5899

Corners	List Corners to be Indexed		
	Section	Twp	Range
N.W.	15	77N	29W
W $\frac{1}{4}$	15	77N	29W

REC \$ 500
AUD \$ _____
R.M.F. \$ 100

FILED NO. 3368

BOOK 1 PAGE 214

94 JUN -6 AM 10:13

COMPUTER
RECORDED
COMPARED

MICHELLE UTSLER
RECORDER
MADISON COUNTY, IOWA

SEAL

