

UNITED STATES PUBLIC LAND SURVEY CORNER CERTIFICATE

OF

Land Survey Monuments situated in Section 8, Township 75 N, Range 28 W, of the Fifth Principal Meridian, Madison County, Iowa. Previously recorded in N/A in County Recorder's Office.

(book, page, document number, etc.)
(Show reason for preparing this certificate, the evidence and detailed procedures used in establishing the corner positions and monumentation found or placed.)

Monument Description and Remarks: S.W. cor. S.E. 1/4 NE 1/4 sec. 8 - found 1/2" iron rod 11" deep

PLAN - VIEW

(Show a minimum of three reference ties to durable physical objects, relevant monuments and physical conditions that will enable recovery of the corner.)

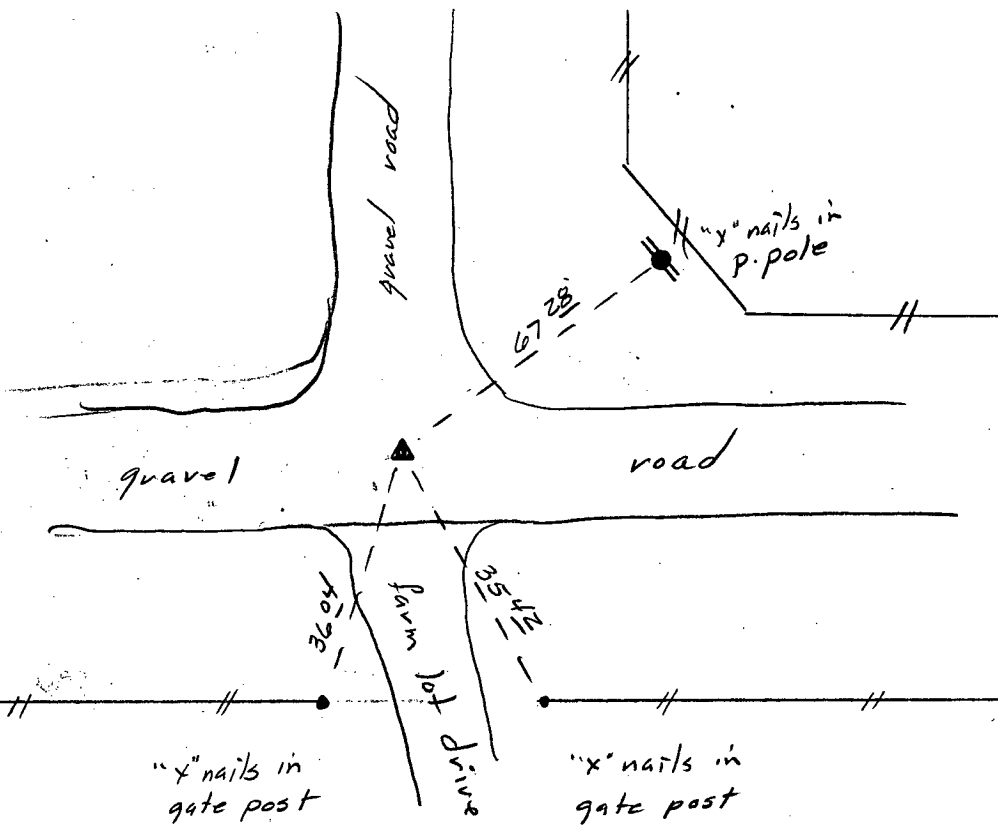
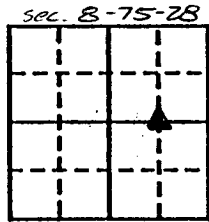

I hereby certify that the survey work was completed and this certificate was prepared by me or under my direct personal supervision and that I am a duly registered land surveyor under the laws of the state of Iowa.

Signature: J. M. Hochstetler
Name typed or printed: J. M. Hochstetler
Date: 4/12/94 Reg. No. 6808



SEAL

List Corners to be Indexed
Corners Section Twp Range
S.W. cor. SE 1/4 NE 1/4 8 T 75 N R 28 W

REC \$ 500
AUD \$ _____
R.M.F. \$ 100

FILED NO. 2741
BOOK 1 PAGE 206
94 APR 12 PM 2:28
MICHELLE UTSLER
RECORDER
MADISON COUNTY, IOWA

COMPUTER
RECORDED
COMPARED _____