

# UNITED STATES PUBLIC LAND SURVEY CORNER CERTIFICATE

OF

Land Survey Monuments situated in Section 9, Township 76 N, Range 28 W, of the Fifth Principal Meridian, Madison County, Iowa. Previously recorded in N.A. in County Recorder's Office.

(book, page, document number, etc.)

(Show reason for preparing this certificate, the evidence and detailed procedures used in establishing the corner positions and monumentation found or placed.)

Monument Description and Remarks: (1) Found 6"x6" cut stone previously logged in County Engineer's Office. (2) and (3) Set 5/8" capped re-bar based on traversing entire section 9 using monuments, fence corners, and recorded section corners to establish location.

## PLAN - VIEW

(Show a minimum of three reference ties to durable physical objects, relevant monuments and physical conditions that will enable recovery of the corner.)

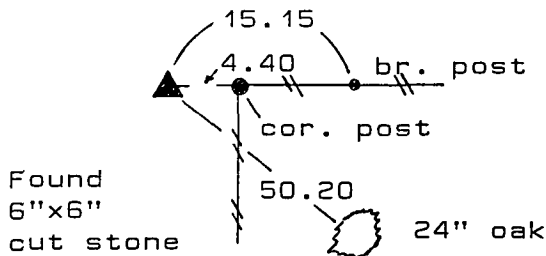

NE. Cor. (1)

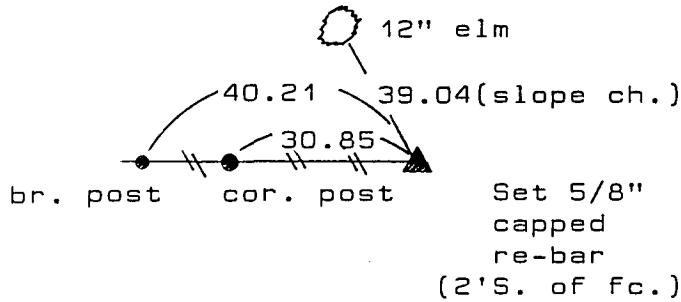

NW. Cor., SE. 1/4 (2)

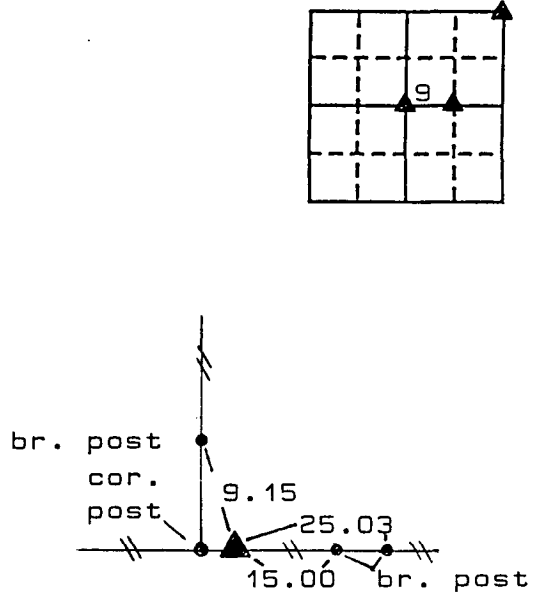

NE. Cor., NW. 1/4, SE. 1/4 (3)

note: all ties to "x" nails

I hereby certify that the survey work was completed and this certificate was prepared by me or under my direct personal supervision and that I am a duly registered land surveyor under the laws of the state of Iowa. My registration renewal date is 12/31/95.

Signature: J. Brian Morrissey  
Name typed or printed: J. Brian Morrissey

Date: 1/20/94 Reg. No. 7995

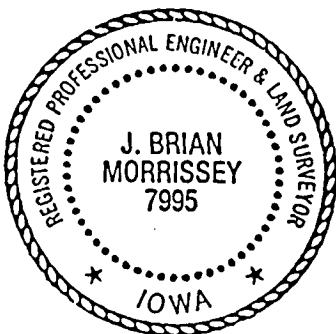

SEAL

Corners	Section	Twp	Range
NE.	9	76 N	28 W
NW., SE. 1/4	9	76 N	28 W
NE., NW. 1/4, SE. 1/4	9	76 N	28 W

FILED NO. 1922

BOOK 1 PAGE 196

94 JAN 20 PM 12:18

MICHELLE UTSLER  
RECORDER  
MADISON COUNTY, IOWA

COMPUTER   
RECORDED   
COMPARED

REC \$ 5.00

AUD \$ 0.00

R.M.F. \$ 0.00