

# UNITED STATES PUBLIC LAND SURVEY CORNER CERTIFICATE

OF

Land Survey Monuments situated in Section 16, Township 75 NORTH, Range 26 West, of the Fifth Principal Meridian, Madison County, Iowa. Previously recorded in \_\_\_\_\_ in County Recorder's Office.

(book, page, document number, etc.)

(Show reason for preparing this certificate, the evidence and detailed procedures used in establishing the corner positions and monumentation found or placed.)

Monument Description and Remarks: \_\_\_\_\_  
\_\_\_\_\_  
\_\_\_\_\_  
\_\_\_\_\_  
\_\_\_\_\_

## PLAN - VIEW

(Show a minimum of three reference ties to durable physical objects, relevant monuments and physical conditions that will enable recovery of the corner.)

NE CORNER NW $\frac{1}{4}$  SW $\frac{1}{4}$  SECTION 16-75-26

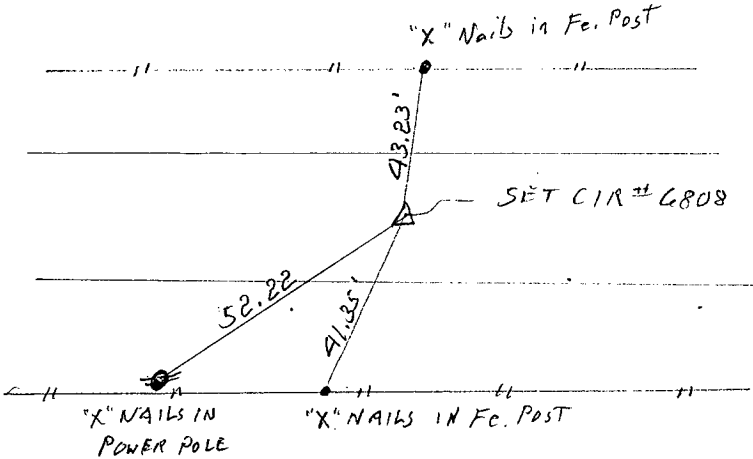
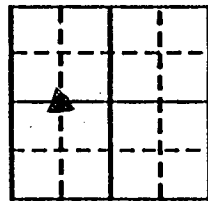

I hereby certify that the survey work was completed and this certificate was prepared by me or under my direct personal supervision and that I am a duly registered land surveyor under the laws of the state of Iowa.

Signature: J. M. Hochstetler  
Name typed or printed: J. M. Hochstetler  
Date: 12/21/93 Reg. No. 6808

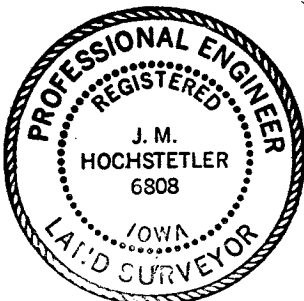

SEAL

Corners	List Corners to be Indexed Section	Twp	Range
NE COR NW $\frac{1}{4}$ SW $\frac{1}{4}$	16	75	26
COMPUTER	<input checked="" type="checkbox"/>		
RECORDED	<input checked="" type="checkbox"/>		
COMPARED	<input checked="" type="checkbox"/>		
REC \$	<u>5.00</u>		
AUD \$	_____		
R.M.F. \$	<u>1.00</u>		
FILED NO.	<u>2868</u>		
BOOK	<u>1</u>	PAGE	<u>210</u>
94 APR 20	PM 3:43		
	MICHELLE UTSLER		
	RECORDER		
	MADISON COUNTY, IOWA		