

# UNITED STATES PUBLIC LAND SURVEY CORNER CERTIFICATE

OF

Land Survey Monuments situated in Section 26, Township 77, Range 27, of the Fifth Principal Meridian, MADISON County, Iowa. Previously recorded in Book \_\_\_\_\_, Page \_\_\_\_\_.

(Show reason for preparing this certificate, the evidence and detailed procedures used in establishing the corner positions and monumentation found or placed).

Monument Description and Remarks: N.E. COR. - SET 1" I.R. IN E GRAVEL RD. / N/4 COR. / SET 1" I.R. IN E-E GRAVEL RDS. / N.E. COR. NW/4-NW/4 FOUND 1" I.R.

## PLAN-VIEW

(Show a minimum of three reference ties to durable physical objects, relevant monuments and physical conditions that will enable recovery of the corner.)

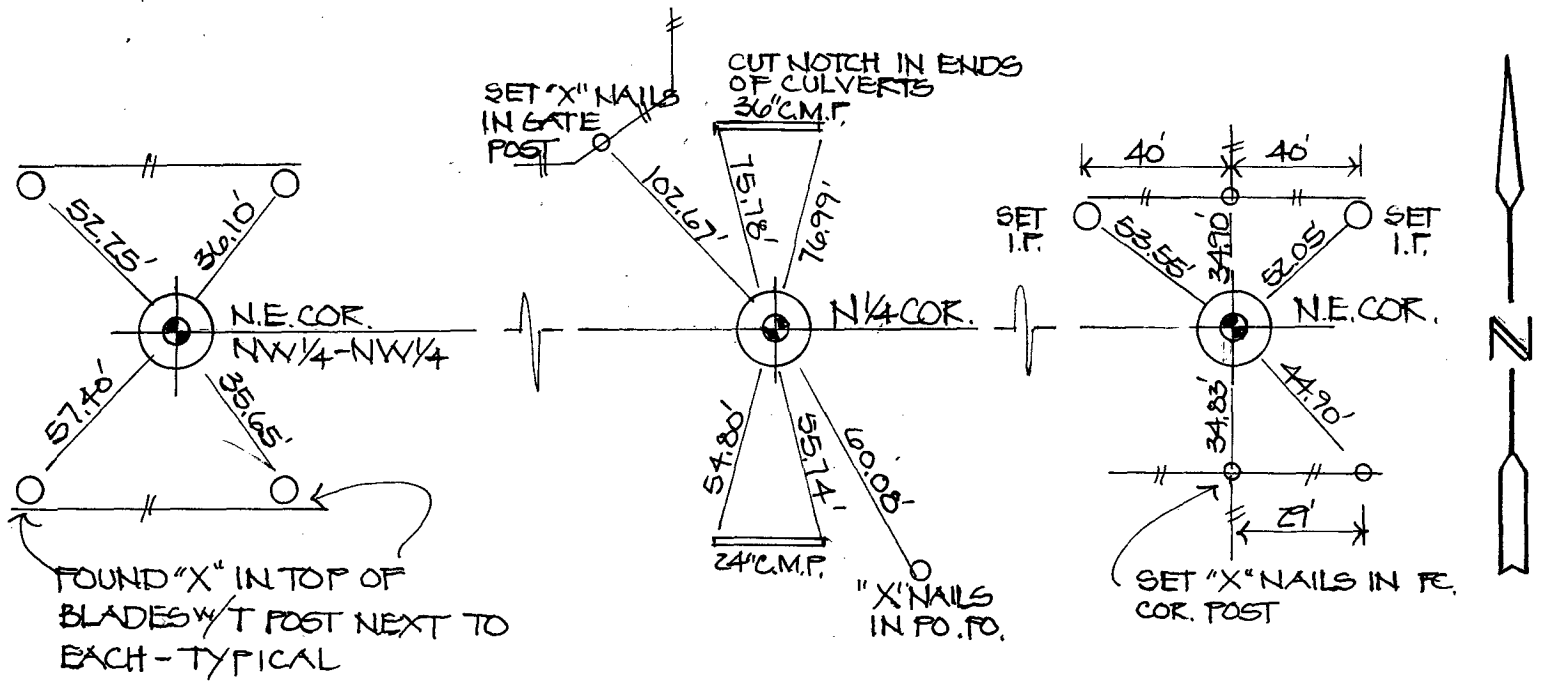
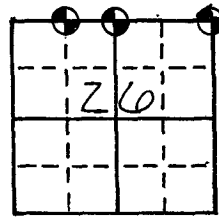

I hereby certify that the survey work was completed and this certificate was prepared by me or under my direct personal supervision and that I am a duly registered land surveyor under the laws of the state of Iowa.

*[Signature]*  
Registered Land Surveyor No. 3169

SEAL



### List Corners to be indexed

Corners	Section	Twp	Range
N.E. COR.	26	77	27
N/4 COR.	26	77	27
N.E. COR. NW/4-NW/4	26	77	27

COMPUTER   
RECORDED   
COMPARED

REC \$ 5.00  
AUD \$ \_\_\_\_\_  
R.M.F. \$ 1.00

FILED NO. 1803  
BOOK 1 PAGE 194  
94 JAN 10 PM 3:48  
MICHELLE UTSLER  
RECORDER  
MADISON COUNTY, IOWA