

UNITED STATES PUBLIC LAND SURVEY CORNER CERTIFICATE

OF

Land Survey Monuments situated in Section 24, Township 75N, Range 28W, of the Fifth Principal Meridian, Madison County, Iowa. Previously recorded in NA in County Recorder's Office.

(book, page, document number, etc.)

(Show reason for preparing this certificate, the evidence and detailed procedures used in establishing the corner positions and monumentation found or placed.)

Monument Description and Remarks: (7) Set 5/8" re-bar based on Vance and Hochstetler surveys recorded in Bk.1, P. 187 and Bk.2, P.7 and IDOT plans for highway P-71. (8) Set 5/8" capped re-bar at midpoint between (7) and (9). (9) Found 2"x4"x6" wedge shaped cut stone, position reasonably close to calculated position.

PLAN - VIEW

(Show a minimum of three reference ties to durable physical objects, relevant monuments and physical conditions that will enable recovery of the corner.)

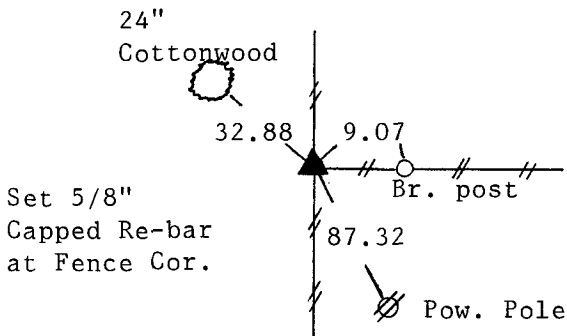

NE Cor., NE 1/4, SE 1/4 (7)

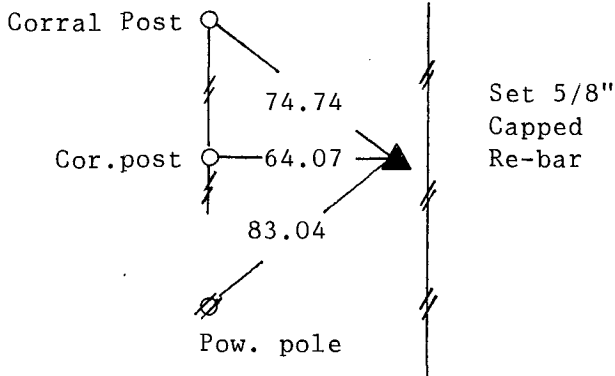

NW Cor., NE 1/4, SE 1/4 (8)

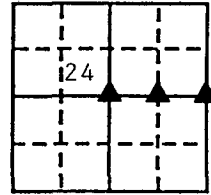

Found 2"x4"x6" Wedge Shaped Cut Stone 0.5' N. of Fc., Set 5/8" Capped Re-bar on W. Side.

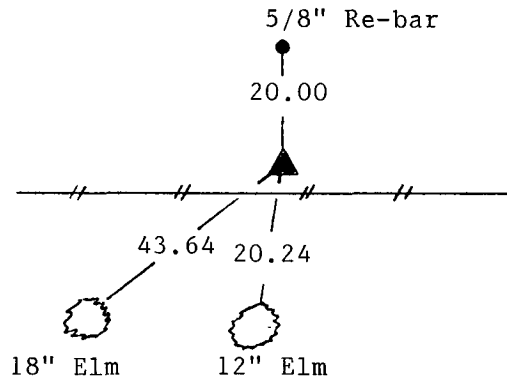

NW Cor. SE 1/4 (9)



Note: All ties to "X" nails unless noted.

I hereby certify that the survey work was completed and this certificate was prepared by me or under my direct personal supervision and that I am a duly registered land surveyor under the laws of the state of Iowa.

Signature: J. Brian Morrissey
Name typed or printed: J. Brian Morrissey
Date: May 5, 1993 Reg. No. 7995

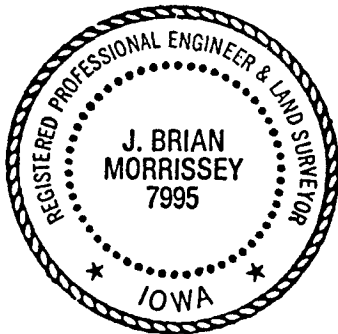

SEAL

Corners	List Corners to be Indexed Section	Twp	Range
NE, NE 1/4, SE 1/4	24	75N	28W
NW, NE 1/4, SE 1/4	24	75N	28W
NW, SE 1/4	24	75N	28W

FILED NO. **2755**

Fee \$5.00

BOOK 1 PAGE 165

93 MAY -6 PM 2:39

MICHELLE UTSLER
RECORDER
MADISON COUNTY, IOWA

COMPUTER

RECORDED

COMPARED