

# UNITED STATES PUBLIC LAND SURVEY CORNER CERTIFICATE

OF

Land Survey Monuments situated in Section 2, Township 75 North, Range 26 West, of the Fifth Principal Meridian, Madison County, Iowa.  
Previously recorded in N/A in County Recorder's Office.

(book, page, document number, etc.)

(Show reason for preparing this certificate, the evidence and detailed procedures used in establishing the corner positions and monumentation found or placed.)

Monument Description and Remarks: \_\_\_\_\_

## PLAN - VIEW

(Show a minimum of three reference ties to durable physical objects, relevant monuments and physical conditions that will enable recovery of the corner.)

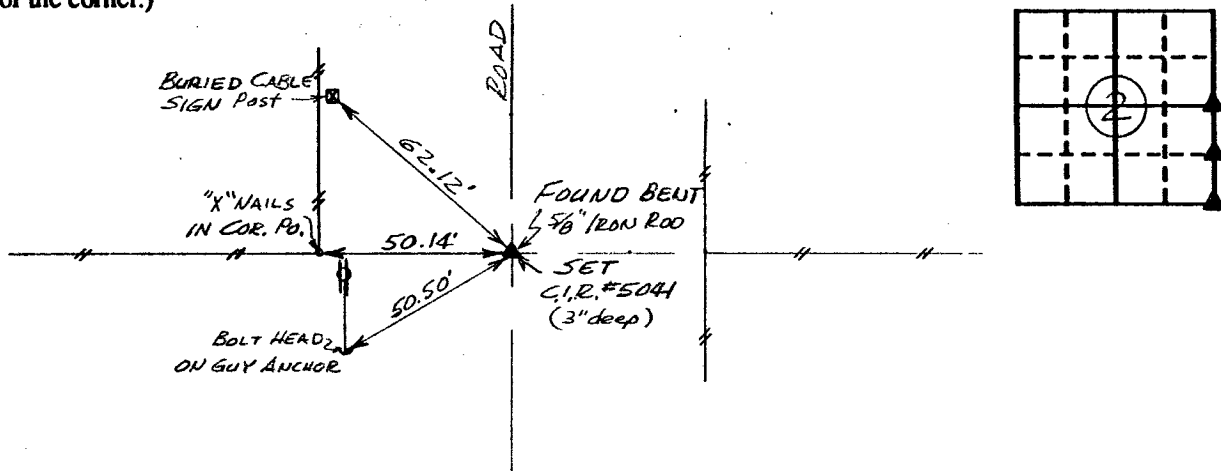

Ref. to E. 1/4 COR., SECTION 2, T75N, R26W.

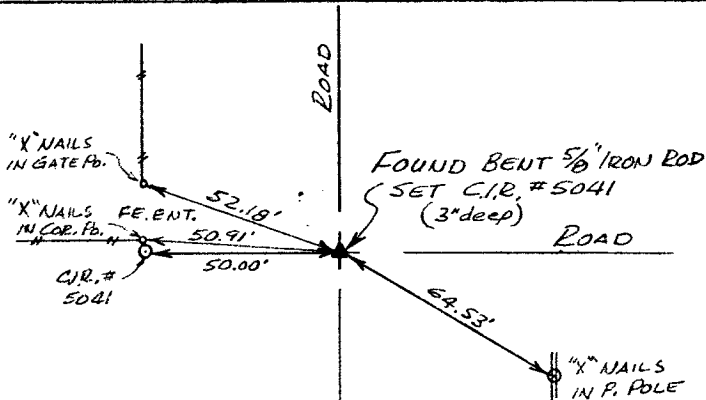

Ref. to NE COR., SE 1/4 SE 1/4, SECTION 2, T75N, R26W.

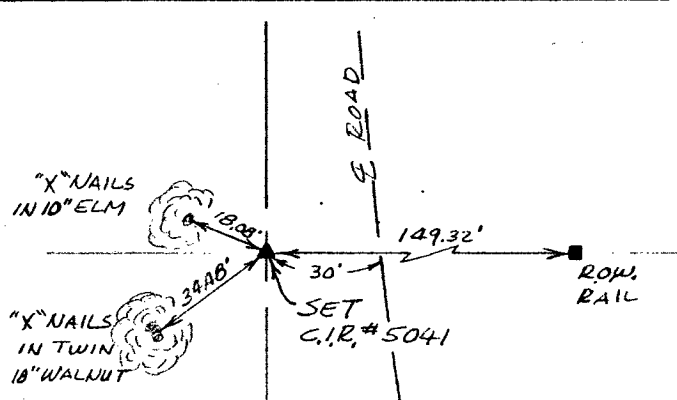

Ref. to SE COR., SECTION 2, T75N, R26W.

I hereby certify that the survey work was completed and this certificate was prepared by me or under my direct personal supervision and that I am a duly registered land surveyor under the laws of the state of Iowa.

Signature: Charles T. Vance

Name typed or printed: Charles T. Vance, PE & LS

Date: 15 April 1993 Reg. No. 5041



COMPUTER

RECORDED

COMPARED

Corners	Section	Twp	Range
E. 1/4 COR.	2	75	26
NE COR.	2	75	26
SE 1/4 SE 1/4	2	75	26
SE COR.	2	75	26

FILED NO. 2660

BOOK 1 PAGE 159

93 APR 28 AM 9:16

Fee \$5.00

MICHELLE UTSLER  
RECORDER  
MADISON COUNTY, IOWA