

# UNITED STATES PUBLIC LAND SURVEY CORNER CERTIFICATE

OF

Land Survey Monuments situated in Section 3, Township 75 North, Range 26 West, of the Fifth Principal Meridian, Madison County, Iowa. Previously recorded in N/A in County Recorder's Office.  
(book, page, document number, etc.)

(Show reason for preparing this certificate, the evidence and detailed procedures used in establishing the corner positions and monumentation found or placed.)

Monument Description and Remarks: NW. COR. and NE. COR. of SW 1/4 SW 1/4 of Sec. 3-75-26 were set at fence corners in line with existing fence lines.

## PLAN - VIEW

(Show a minimum of three reference ties to durable physical objects, relevant monuments and physical conditions that will enable recovery of the corner.)

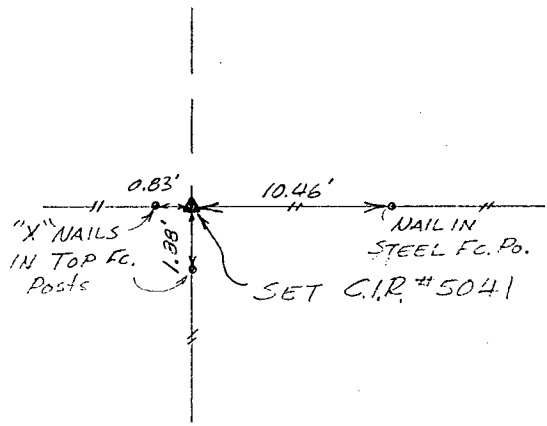

Ref. to NW. COR., SW 1/4 SW 1/4, SECTION 3, T75N, R26W.

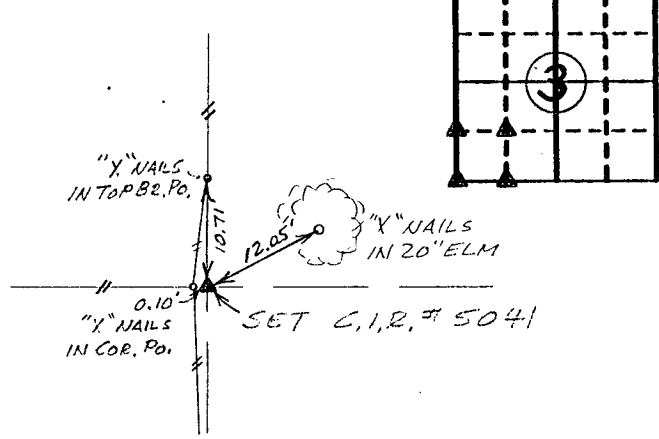

Ref. to NE. COR., SW 1/4 SW 1/4, SECTION 3, T75N, R26W.

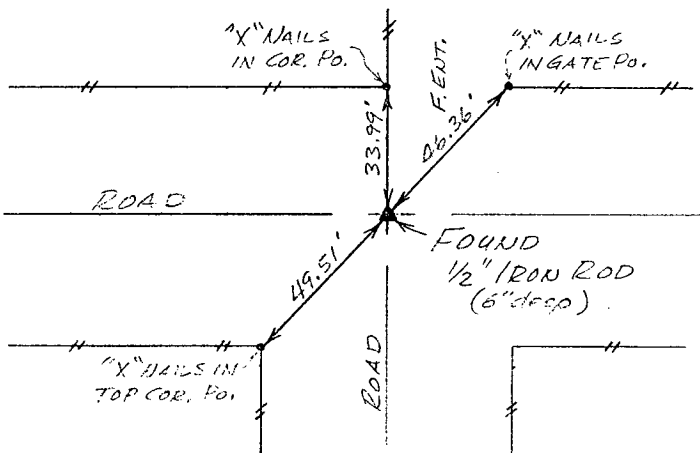

Ref. to SW. COR., SECTION 3, T75N, R26W

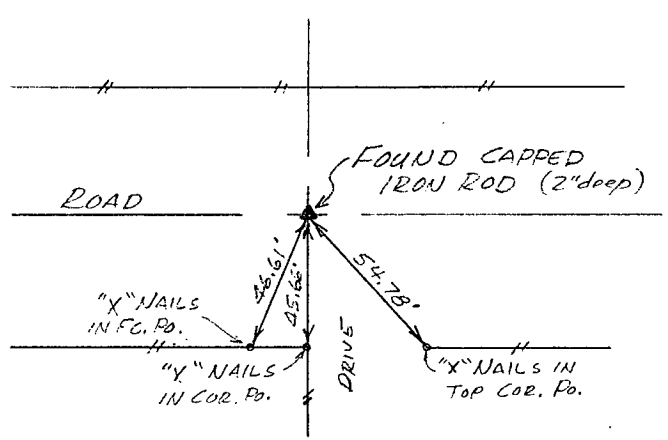

Ref. to SE. COR., SW 1/4 SW 1/4 SECTION 3, T75N, R26W.

I hereby certify that the survey work was completed and this certificate was prepared by me or under my direct personal supervision and that I am a duly registered land surveyor under the laws of the state of Iowa.

Signature: Charles T. Vance  
Name typed or printed: Charles T. Vance, PE & LS  
Date: 22 June 1993 Reg. No. 5041

Corners	List Corners to be Indexed	Section	Twp	Range
NE. COR.		3	75	26
SW 1/4 SW 1/4				
NW. COR.		3	75	26
SW 1/4 SW 1/4				
SW. COR.		3	75	26
SE. COR.		3	75	26
SW 1/4 SW 1/4				



FILED NO. **3308**  
BOOK 1 PAGE 173  
93 JUN 24 PM 3:05  
MICHELLE UTSLER  
RECORDER  
MADISON COUNTY, IOWA

REC \$ 5.00  
AUD \$ -