

# UNITED STATES PUBLIC LAND SURVEY CORNER CERTIFICATE

OF

Land Survey Monuments situated in Section 6, Township 77 North, Range 28 West, of the Fifth Principal Meridian, Madison County, Iowa.  
 Previously recorded in N/A in County Recorder's Office.  
(book, page, document number, etc.)

(Show reason for preparing this certificate, the evidence and detailed procedures used in establishing the corner positions and monumentation found or placed.)

Monument Description and Remarks: \_\_\_\_\_

## PLAN - VIEW

(Show a minimum of three reference ties to durable physical objects, relevant monuments and physical conditions that will enable recovery of the corner.)

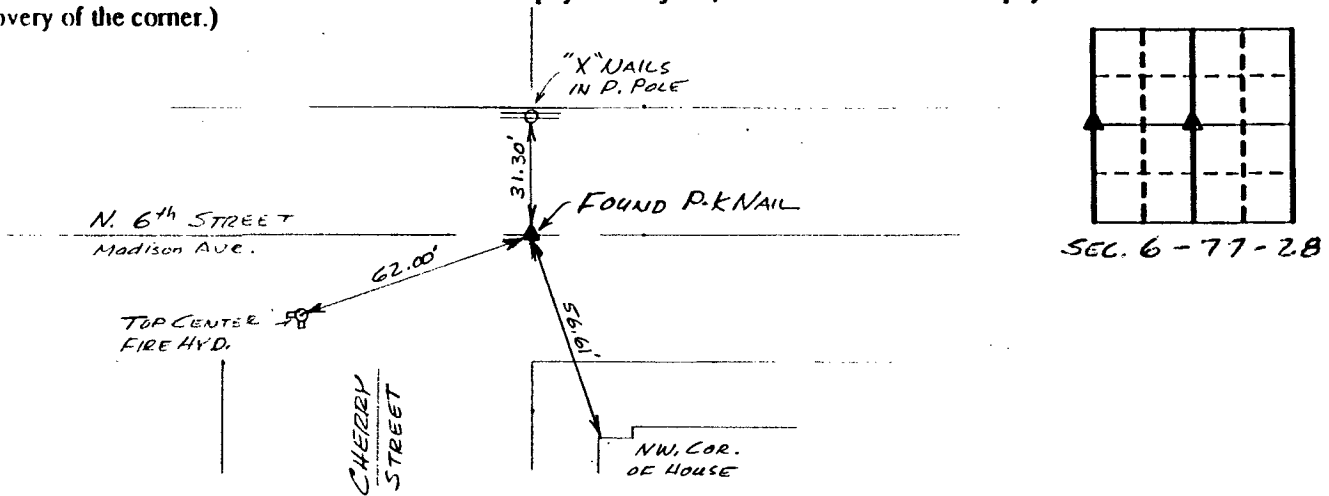

*Ref. to CENTER OF SECTION 6, T77N, R28W*

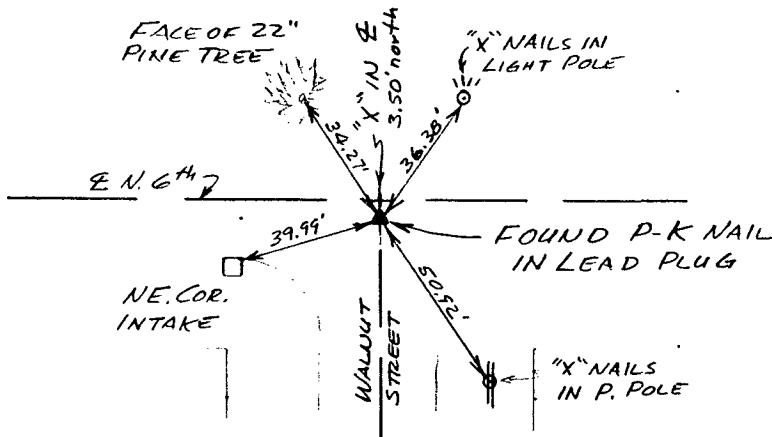

*Ref. to W. 1/4 COR., SECTION 6, T77N, R28W*

I hereby certify that the survey work was completed and this certificate was prepared by me or under my direct personal supervision and that I am a duly registered land surveyor under the laws of the state of Iowa.

Signature: Charles T. Vance  
 Name typed or printed: Charles T. Vance, PE & LS  
 Date: 14 Sept. 1992 Reg. No. 5041

Corners	List Corners to be Indexed		
	Section	Twp	Range
CENTER	6	77	28
W. 1/4 COR.	6	77	28

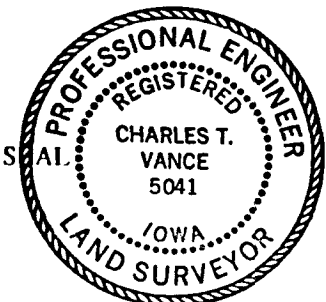

REC \$ 5.00  
 AUD \$ -

FILED NO. 741  
 Corner Cert BOOK 1 PAGE 122  
 92 SEP 21 PM 3:57  
 MICHELLE UTSLER  
 RECORDER  
 MADISON COUNTY, IOWA