

# UNITED STATES PUBLIC LAND SURVEY CORNER CERTIFICATE

OF

Land Survey Monuments situated in Section 9, Township 74 North, Range 26 West, of the Fifth Principal Meridian, Madison County, Iowa.  
 Previously recorded in N/A in County Recorder's Office.  
(book, page, document number, etc.)

(Show reason for preparing this certificate, the evidence and detailed procedures used in establishing the corner positions and monumentation found or placed.)

Monument Description and Remarks: \_\_\_\_\_  
 \_\_\_\_\_  
 \_\_\_\_\_  
 \_\_\_\_\_

## PLAN - VIEW

(Show a minimum of three reference ties to durable physical objects, relevant monuments and physical conditions that will enable recovery of the corner.)

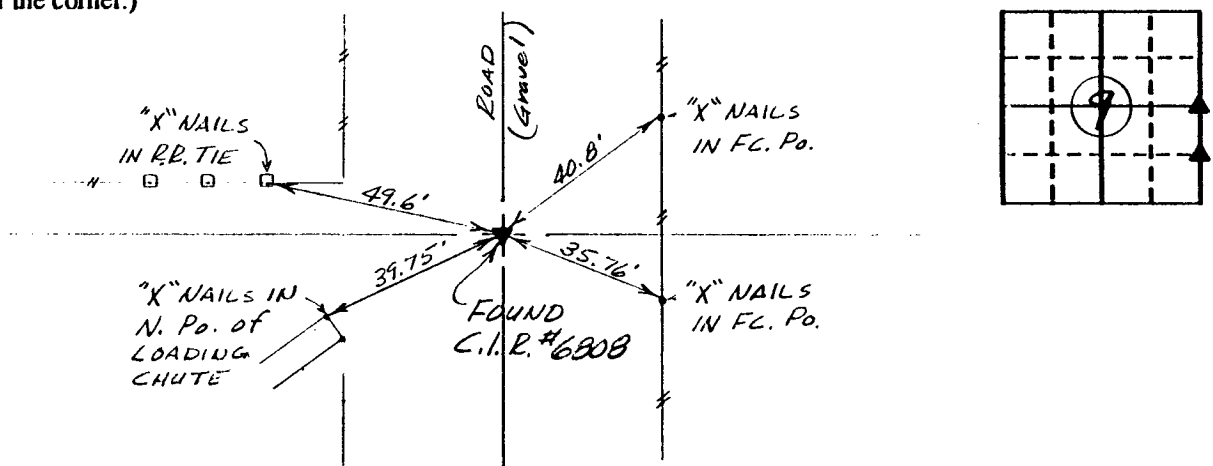

*Ref. to E. 1/4 COR., SECTION 9, T74N, R26W.*

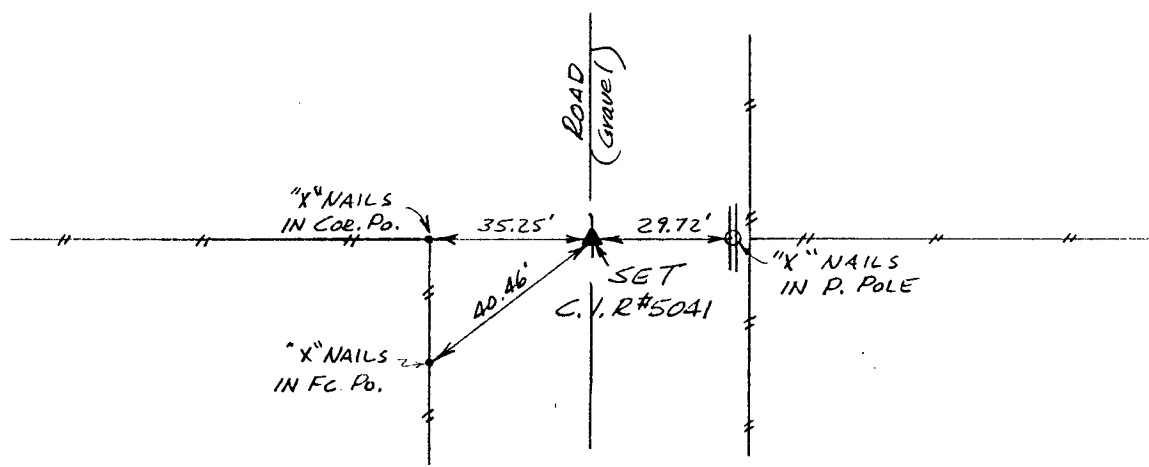

*Ref. to NE COR., SE 1/4-SE 1/4, SECTION 9, T74N, R26W.*

I hereby certify that the survey work was completed and this certificate was prepared by me or under my direct personal supervision and that I am a duly registered land surveyor under the laws of the state of Iowa.

Signature: Charles T. Vance  
 Name typed or printed: Charles T. Vance, PE & LS  
 Date: 24 Feb 1992 Reg. No. 5041



Corners	Section	Twp	Range
E. 1/4 COR.	9	74	26
NE COR			
SE 1/4-SE 1/4			

COMPUTER FILED NO. **2468**

Fee \$5.00 BOOK 1 PAGE 79

92 APR 14 PM 3:28

INT.   
 REC.   
 PAGE   
 MICHELLE UTSLER  
 RECORDER  
 MADISON COUNTY, IOWA

COMPLETED