

UNITED STATES PUBLIC LAND SURVEY CORNER CERTIFICATE

OF

Land Survey Monuments situated in Section 30, Township 77 North, Range 29 West, of the Fifth Principal Meridian, Madison County, Iowa. Previously recorded in N/A in County Recorder's Office.

(book, page, document number, etc.)

(Show reason for preparing this certificate, the evidence and detailed procedures used in establishing the corner positions and monumentation found or placed.)

Monument Description and Remarks: _____

PLAN - VIEW

(Show a minimum of three reference ties to durable physical objects, relevant monuments and physical conditions that will enable recovery of the corner.)

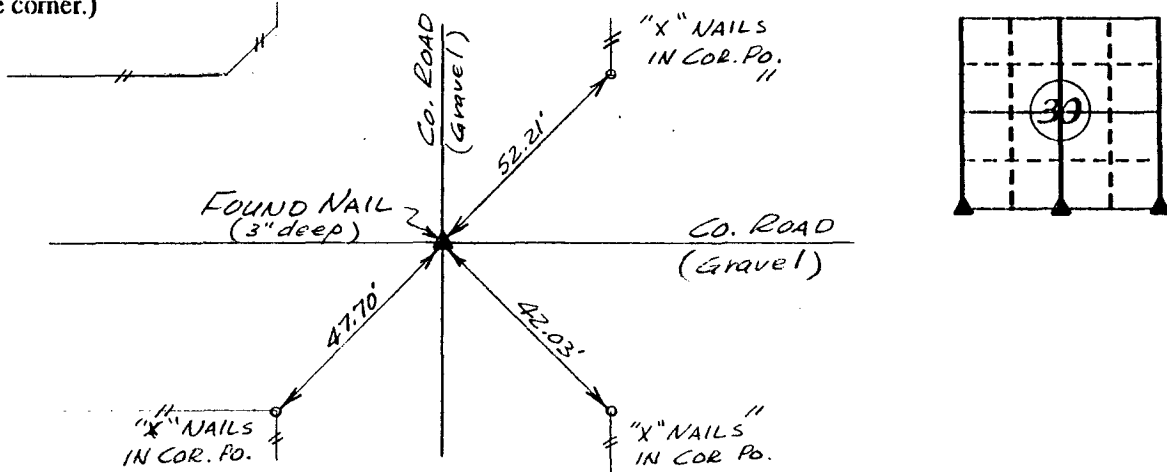

Ref. to SW. COR., SECTION 30, T 77N, R 29W

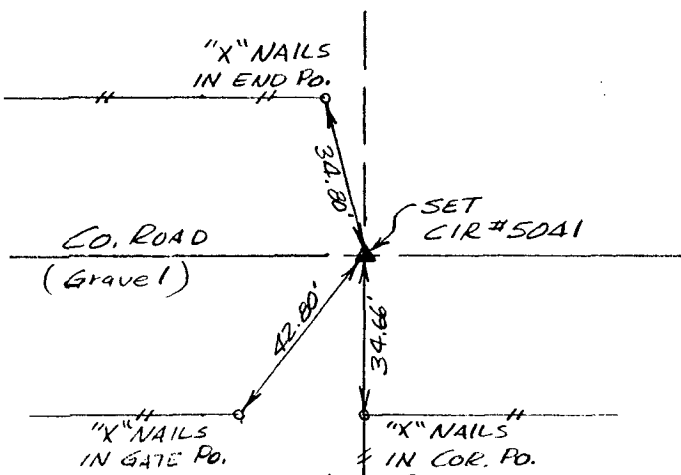

Ref. to S. 1/4 COR., SECTION 30, T 77N, R 29W

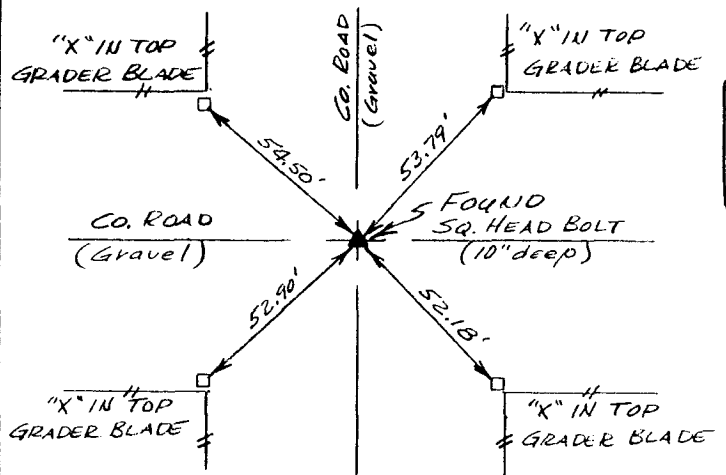

Ref. to SE. COR., SECTION 30, T 77N, R 29W

I hereby certify that the survey work was completed and this certificate was prepared by me or under my direct personal supervision and that I am a duly registered land surveyor under the laws of the state of Iowa.

Signature: Charles T. Vance
Name typed or printed: Charles T. Vance, PE & LS

Date: 24 Aug. 1991 Reg. No. 5041

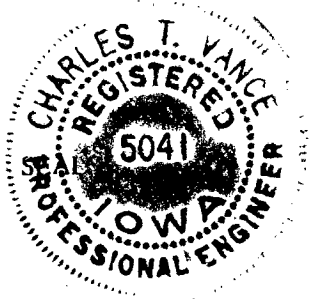

List Corners to be Indexed

Corners	Section	Twp	Range
SW. COR.	30	77	29
S. 1/4 COR.	30	77	29
SE. COR.	30	77	29

FILED NO. **804**

BOOK 1 PAGE 52

91 SEP 18 AM 9:36

COMPARED

MICHELLE UTSLER
RECORDER
MADISON COUNTY, IOWA
Fee \$5.00