

UNITED STATES PUBLIC LAND SURVEY CORNER CERTIFICATE

OF

Land Survey Monuments situated in Section 27, Township 77 NORTH, Range 28 WEST, of the Fifth Principal Meridian, MADISON County, Iowa.
Previously recorded in N/A in County Recorder's Office.
(book, page, document number, etc.)

(Show reason for preparing this certificate, the evidence and detailed procedures used in establishing the corner positions and monumentation found or placed.)

Monument Description and Remarks: _____

PLAN - VIEW

(Show a minimum of three reference ties to durable physical objects, relevant monuments and physical conditions that will enable recovery of the corner.)

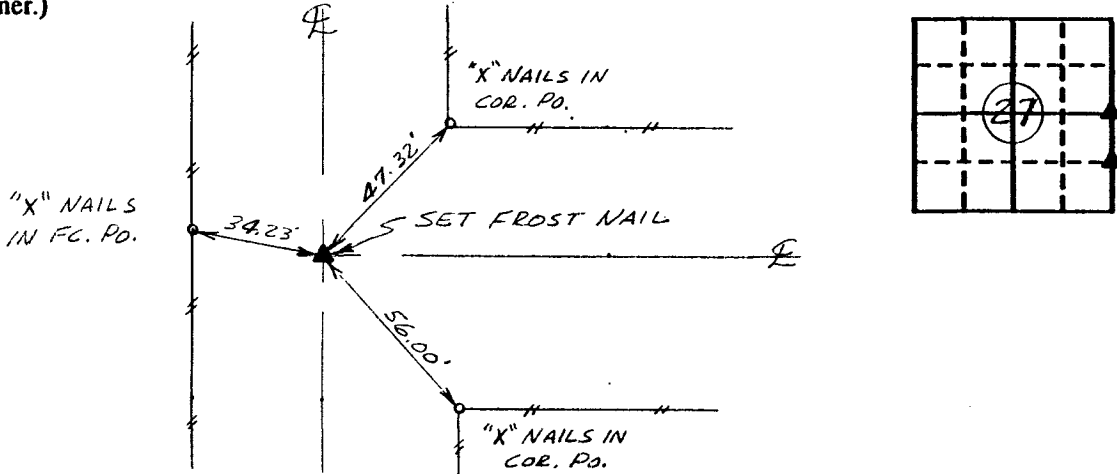

Ref. to E. 1/4 COR., SECTION 27, T77N, R28W

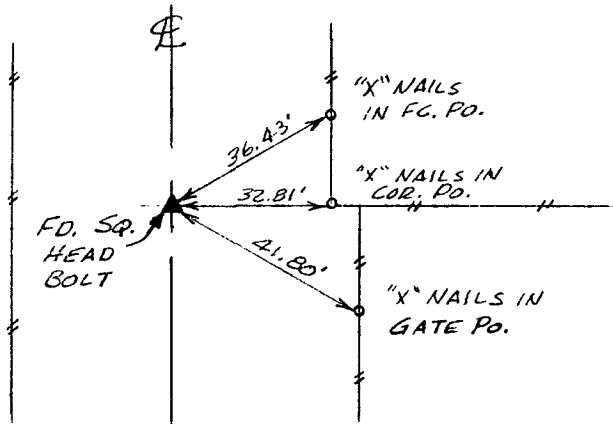

Ref. to SE. COR., NE. 1/4 - SE. 1/4, SECTION 27, T77N, R28W

I hereby certify that the survey work was completed and this certificate was prepared by me or under my direct personal supervision and that I am a duly registered land surveyor under the laws of the state of Iowa.

Signature: Charles T. Vance
Name typed or printed: Charles T. Vance, PE & LS
Date: 11 JAN. 1991 Reg. No. 5041

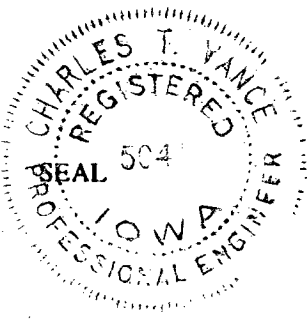

Corners	List Corners to be Indexed	Section	Twp	Range
E. 1/4 COR.		27	77	28
SE. COR.		27	77	28
NE. 1/4 SE 1/4				

FD.
REC.
PAGE

FILED NO. 1660

\$5.00

BOOK 1 PAGE 13
LAND CORNER SURVEY
91 FEB 22 PM 2:05

COMPARED

MICHELLE UTSLER
RECORDER
MADISON COUNTY, IOWA