

# UNITED STATES PUBLIC LAND SURVEY CORNER CERTIFICATE

OF

Land Survey Monuments situated in Section 30, Township 76 NORTH, Range 28 WEST, of the Fifth Principal Meridian, MADISON County, Iowa. Previously recorded in \_\_\_\_\_ in County Recorder's Office.

(book, page, document number, etc.)

(Show reason for preparing this certificate, the evidence and detailed procedures used in establishing the corner positions and monumentation found or placed.)

Monument Description and Remarks:

CENTER: Set C.I.R. #6808 @ Existing fence corner

SE COR.: Found 1/2" Iron Pin (approx 5" deep).

S 1/4 COR.: Set ~~RR SPIKE~~ ~~RR SPIKE~~ at Calculated corner (alignment based on R.O.W. splits).

SW COR.: Found Frost Nail in Highway surface (60d)

## PLAN - VIEW

(Show a minimum of three reference ties to durable physical objects, relevant monuments and physical conditions that will enable recovery of the corner.)

CENTER  
SEC. 30-76-28  
Set C.I.R. #6808

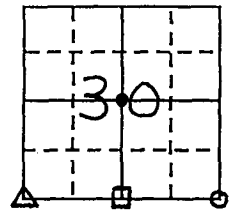
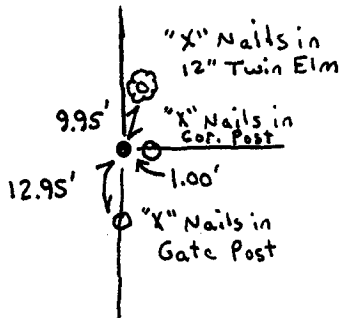

S 1/4 CORNER  
SEC. 30-76-28

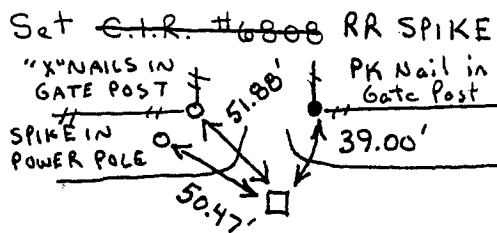

SE CORNER  
SEC. 30-76-28  
Fd. 1/2" Iron Pin  
Approx. 5" deep

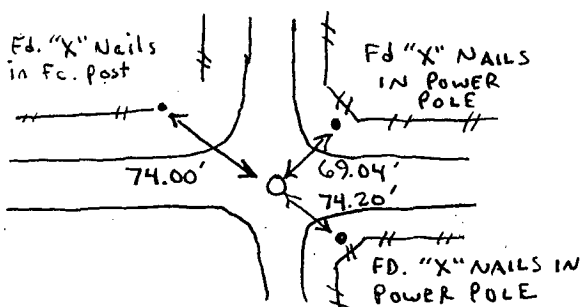

SW CORNER  
SEC. 30-76-28  
Fd. Frost Nail  
60d

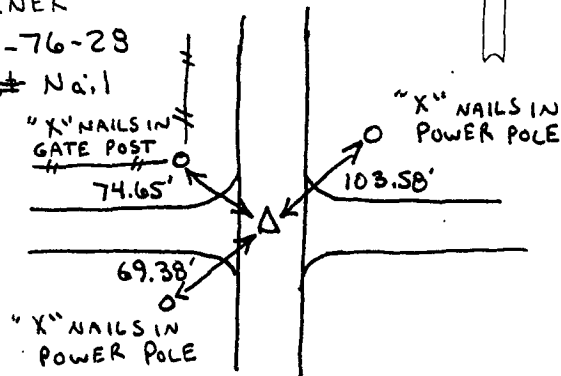

I hereby certify that the survey work was completed and this land surveying document was prepared by me or under my direct personal supervision and that I am a duly registered land surveyor under the laws of the state of Iowa

Signature: J. M. Hochstetler  
Name typed or printed: J. M. Hochstetler

Date: 1/23/96 Reg. No. 6808

My registration renewal date is December 31, 1997

SEAL



COMPUTER RECORDED  
INDEXED

Corners	List Corners to be Indexed Section	Twp	Range
• CENTER	30	76	28
○ SE Cor.	30	76	28
□ S 1/4 Cor.	30	76	28
△ SW Cor.	30	76	28

FILED NO. **2197**

BOOK 1 PAGE 346

96 FEB 14 AM 9:46

MICHELLE UTSLER  
RECORDER  
MADISON COUNTY, IOWA

REC \$ 5.00  
AUD \$ 1.00  
R.M.F. \$ 1.00