

REC # 500  
R.M.F. \$ 100

FILED NO. 1999  
BOOK 1 PAGE 339  
96 JAN 22 AM 11:12

CONVEYED   
INDEXED   
CORRECTED

MICHELLE UTSLER  
RECORDER  
MADISON COUNTY, IOWA

Prepared By: J. Brian Morrissey, Morrissey Surveying, 1926 Pammel Park Road, Winterset, Ia. 50273, Tele. (515) 462-2166

# UNITED STATES PUBLIC LAND SURVEY CORNER CERTIFICATE OF

Land Survey Monuments situated in Section 16, Township 76 N, Range 27 W, of the Fifth Principal Meridian, Madison County, Iowa.  
Previously recorded in N. A. in County Recorders Office.  
(book,page,document number,etc.)

(Show reason for preparing this certificate, the evidence and detailed procedures used in establishing the corner positions and monumentation found or placed.)

Monument Description and Remarks: Set 5/8" capped rebar, #7995, at midpoint of center of Section and evidence of east quarter corner. Position checked good with fences to north and south.

## PLAN VIEW

(Show a minimum of three reference ties to durable physical objects, relevant monuments and physical conditions that will enable recovery of the corner.)

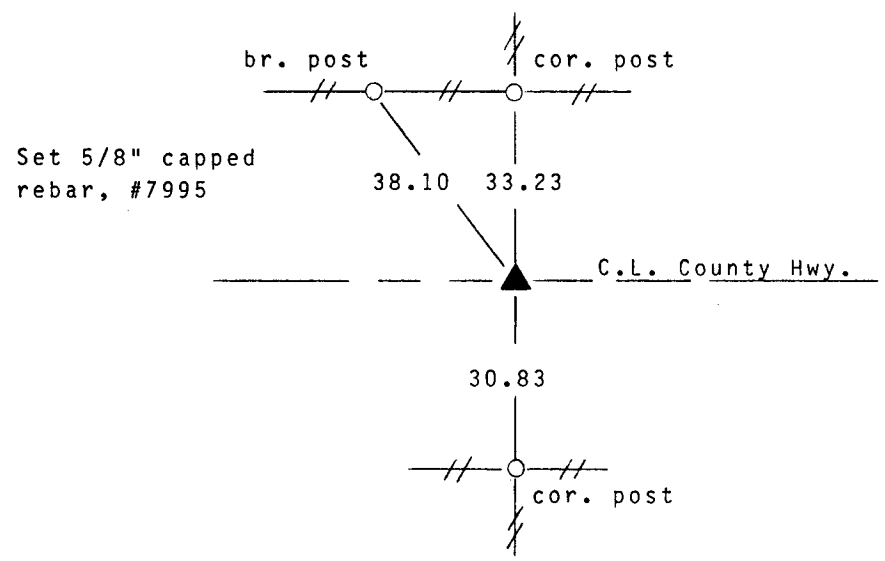
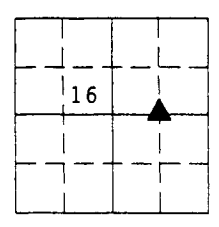

NW. Cor., NE. 1/4, SE. 1/4, Sec. 16

Note: all ties to "x" nails



I hereby certify that the survey work was completed and this certificate was prepared by me or my direct personal supervision and that I am a duly registered land surveyor under the laws of the state of Iowa. My registration renewal date is 12/31/97.

Signature: J. Brian Morrissey

Name typed or printed: J. Brian Morrissey

Date: 1/22/96 Reg.No. 7995